

THIS REPRODUCTION IS COMPRISED
OF THE BEST AND MOST COMPLETE
SET OF ORIGINAL IMAGES AVAILABLE
AT THE TIME OF THIS PROJECT'S
INITIAL START. THE ORIGINAL PAPER,
INK, FONT, FONT SIZE AND QUALITY
OF THE MICROFILMED IMAGES
CONTRIBUTE AND AFFECT THE
QUALITY OF THE FINAL PRODUCT.

Obituaries



**Shaun Michael Shelton
1984 - 2012**

Shaun Michael Shelton, 27, of Martin passed away Friday, March 2, in Boyd County.

Born Sept. 23, 1984, in Martin, he was the son of Regina Shelton Salisbury and husband of Sheena Spears Shelton. Shaun was the grandson of Fred and the late Brenda Lester Shelton.

He was a member of the Local 181 of Operating Engineers, Ashland.

Additional survivors include a son, Davan Michael Shelton

of Martin and one brother, Alan Salisbury of River.

Shaun had many people that loved him and he will be greatly missed.

Funeral services were held Tuesday, March 6, at Nelson Frazier Funeral Home with Donnie Patrick officiating. Burial followed the service at Drift Cemetery under the direction of Nelson Frazier Funeral Home, Martin.

Allen 'Mo' Lewis

Allen "Mo" Lewis, 60, of Cow Creek, died Saturday, March 10, 2012, at St. Joseph Hospital in Martin.

He was born Sept. 23, 1951, to the late Glenn and Beulah Music Lewis. He was the husband of Nancy Cummings Lewis and was a disabled laborer.

He was preceded in death by one son, Glenn Allen Lewis, and one sister, Zella Lewis Goble.

He is survived by his son, David Allen Lewis; daughter, Suzanne Lewis Spencer; brothers, Roy Lewis, Arnold Jarrell, Joe Jarrell, Russell "Warren" Jarrell, Kenneth Jarrell and George Andrew Jarrell; sisters, Dianne Jarrell and Tammy

Jarrell; and grandchildren, Shaler Spencer, Casey Spencer and Tessa Spencer.

Funeral services will be held at 10 a.m., Wednesday, March 14, at Nelson Frazier Funeral Home, with William Jarrell officiating. Burial will follow the service at Jarrell Family Cemetery in Prestonsburg.

Nelson Frazier Funeral Home is in charge of arrangements.

Vina Salisbury Nuckles

Vina Salisbury Nuckles, 84 years of age, passed away Sunday, March 11, 2012, at Mayfair Manor, in Lexington.

Born July 14, 1927, at Hunter, she was the daughter of the late Milton Salisbury and Ora Stumbo Salisbury.

Vina was a nurse, serving many years as a licensed practical nurse at Highlands Regional Medical Center.

She was also a member of the Lodge #31 and a former member of the Women's



Auxiliary of the VFW.

Vina is survived by her husband, Boyd Nuckles, of Prestonsburg, and a daughter, Etta Marrea Nuckles, of Lexington.

Funeral services will be held at 1 p.m., Wednesday, March 14, at the Carter Funeral Home Chapel, with Pastor Dave Garrett officiating. Burial will follow in Gethsemane Gardens, in Prestonsburg.

Donald Eugene Ratliff

Donald Eugene Ratliff, 78, of Dwell, died Wednesday, March 7, 2012, at Highlands Regional Medical Center.

He was born Sept. 19, 1933, to the late Thurman and Ethel Humble Ratliff. He was the husband of the late Wanda Conn Ratliff and was a retired foundry worker for Battle Creek Foundry.

He was preceded in death by one granddaughter, Angel Kilburn.

He is survived by his son, James B. Ratliff; daughter, Debby McGuire; brother, Paul Douglas Ratliff; grandchildren, Jeremy Kilburn and James Kilburn; and great grandchild, Coalton.

Funeral services were held Sun-

day, March 11, at Nelson Frazier Funeral Home, with Bill Tussey Jr. officiating. Burial followed the service at Davidson Memorial Gardens in Ivel.

Nelson Frazier Funeral Home was in charge of arrangements.

Dwayne Douglas 'Doug' Tackett

Dwayne "Douglas" "Doug" Tackett, 62, of Martin, died Friday, March 9, 2012, at Highlands Regional Medical Center.

He was born Feb. 20, 1950, to the late Douglas and Dorothy Vanhoose Tackett. He was a member of the Allen First Baptist Church.

He is survived by one brother, Jack (Sherry) Tackett, of Dana, and two nephews, Jeremy (Kara) Tackett, of Pikeville, and Nicholas (Tiffany) Tackett, of Shepherdsville.

Funeral services were held Tuesday, March 13, at Nelson Frazier Funeral Home with Jeremy Tackett officiating. Burial followed the service at Gethsemane Gardens in Prestonsburg.

Nelson Frazier Funeral Home was in charge of arrangements.

Disaster

From Page A1

nifee, Morgan and Pendleton counties, which were subject to the disaster declaration when it was first issued March 6.

The news was especially welcome in Magoffin County, where current estimates are that 80 businesses and 300 homes

Grave

From Page A1

According to deputies, they received a tip last week that Vicars was in possession of the memorial.

Following the tip, Deputy Landon Hall met with Vicars and questioned him about the theft. Hall later returned with an arrest warrant for Vicars, and on the second trip, Vicars produced the stolen memorial that he had "found."

"I want him to be punished to the fullest extent

Hoops

From Page A1

to choose the teams you think will rise to the occasion this year in the NCAA Basketball Tournament.

Just go to www.floydcountytimes.com and click on the "Contests" link, under the "Local Features" menu, or click the trophy icon in the top left corner of the website. On the next page, you will find a link to the contest, where you can begin filling out your brackets.

This year, there are two ways to play. You can pick a winner in all the brackets before the tournament begins, and then just sit back to see how your teams do as the tournament progresses. Or, you can visit the contest site before each game and pick who you think is going to win each upcoming game, once both teams for a game are known. If you pick teams as the tourna-

were destroyed, and damages are estimated to be over \$45 million.

"This is welcome news for many, but not all families in our region," said U.S. Rep. Hal Rogers, who announced the first nine additions Friday night. "I've been told damage assessments are continuing and we know this is only

Road

From Page A1

of the law," said Osborne. "I want an example made of him."

Osborne says she hopes a stern punishment handed down by the courts will give would-be thieves pause before stealing memorials, not only from the grave of her son, but from any grave.

Vicars was transported to the Floyd County Detention Center, where he continues to be held on a \$10,000 cash bond.

Violating graves is a Class D felony.

ment progresses, you can pick the winner until 20 minutes before the game is scheduled to start. You can sign up to play at any point in the tournament.

You could win \$1 million if you pick all of the games correctly. You could win \$10,000 if you only miss one or two games. And, you could win \$1,000 if you only miss three games. The national grand prize for the player with the highest score is a 32GB iPod Touch sponsored by Upickem and a NCAA Fathead sponsored by Fathead.com.

The top winner among "Times" participants will receive \$50.

For more details (including how ties are broken) see our rules page on the contest site at www.floydcountytimes.com.

the beginning. Our families face enormous challenges with home repair, finding temporary housing, replacing vehicles, and getting life back to normal.

"These are trying times, but with the help of these disaster aid funds, we are taking a step in the right direction toward recovery. As I told FEMA Administrator (William Craig) Fu-

Road

From Page A1

storm relief efforts.

Country Music Highway "Road to Fame" talent competition organizers hope the first round of auditions will give local residents something positive in the midst of such great sadness. "We are expecting hundreds of people to attend the four auditions," said Ken Carriere. "We saw Vina had an opportunity to use this competition to raise funds for our neighbors in need."

The competition will be heavily promoted to

ensure the best possible pool of entrants. The final is expected to be held at the Mountain Arts Center, although producers say that could change.

The grand prize winner will receive a scholarship to participate in a course of career development and coaching under the direction of PGC Nashville, valued at \$25,000. He or she may also receive career-related benefits. Each runner-up will receive an acoustic guitar and a certificate of achievement. Other prizes and gifts may be

provided by participating sponsors. Contestants who don't make it through will be given tips to work on to help them improve, so they can come back and give it another shot later. Winners may also be featured on the nationally syndicated Crook & Chase TV show, appear on a professionally produced and recorded CD and make personal appearances throughout the region.

An added benefit of the contest is the creation of the Country Music

curity number, current and pre-disaster address, telephone number to be contacted, insurance information, total household annual income, bank routing and account numbers, and a description of losses that were caused by the disaster. The disaster declaration number is FEMA-4057-DR.

Additional information about this disaster and required forms to apply for assistance are available at <http://www.disasterassistance.gov/>.

In order to apply for individual assistance, an applicant should have on hand his or her social se-

curity number, current and pre-disaster address, telephone number to be contacted, insurance information, total household annual income, bank routing and account numbers, and a description of losses that were caused by the disaster. The disaster declaration number is FEMA-4057-DR.

Additional information about this disaster and required forms to apply for assistance are available at <http://www.disasterassistance.gov/>.

In order to apply for individual assistance, an applicant should have on hand his or her social se-

curity number, current and pre-disaster address, telephone number to be contacted, insurance information, total household annual income, bank routing and account numbers, and a description of losses that were caused by the disaster. The disaster declaration number is FEMA-4057-DR.

curity number, current and pre-disaster address, telephone number to be contacted, insurance information, total household annual income, bank routing and account numbers, and a description of losses that were caused by the disaster. The disaster declaration number is FEMA-4057-DR.

Highway Road to Fame Arts Education Fund, a nonprofit organization formed in conjunction with the Road to Fame. The intention of the fund is to provide financial and educational support to music and arts programs in area schools. The fund will be administered via the Bluegrass Community Foundation.

More information about the Country Music Highway Road to Fame competition can be found at www.cmhroadtofame.com.

Kentucky State Parks offer spring break deals

FRANKFORT — March and April mean spring break for many families, and Kentucky State Parks invite you to take advantage of several special offers and packages.

The Kentucky State Parks resorts have lodges, cottages and restaurants, as well as recreational opportunities for families. These include trails, playgrounds, tennis and basketball courts, fishing and wildlife viewing. Spring break is a great time to get outside and explore some of the natural beauty at these parks. All state park campgrounds will open in April.

Listed below are some of the special offers and programs in March and April. (Offers based on availability, for individual travel only. Not to be combined with any other discounts or offers. Applicable taxes apply.) For more information or to make a reservation, call the park or visit www.parks.ky.gov.

Barren River Lake State Resort Park, Lucas
Barren River Lake State Resort Park is offering spring break packages for

two to eight people. The Bed and Breakfast Package for an adult and one child includes one night's lodge room and breakfast for \$49.99. The Family Package for four people includes one night's lodge room, a pizza, drinks and cookies for \$69. There are also packages for cottages starting at \$69.95 a night. Prices good through May 24. The park has biking and hiking trails, tennis and basketball courts, free fishing gear and is just 25 miles from Mammoth Cave. Call 1-800-325-0057.

Buckhorn Lake State Resort Park, Buckhorn
Buckhorn Lake State Resort Park is offering overnight lodging packages for families starting at \$49.95 a night. This includes a lodge room, free Wi-Fi, continental breakfast, mini golf, hiking trails, wildlife viewing, fishing, a playground and more. A cottage package is available for \$89.95. Offer good through May 24. Call 1-800-325-0058.

Cumberland Falls State Resort Park, Corbin
Cumberland Falls is offering its Spring Break Adventure

package, April 1-4. Activities include canoeing, whitewater rafting, a rock climbing wall, archery, wildflower walks, astronomy and hikes to waterfalls and natural arches. Activities may be changed due to weather conditions. There is a fee for rafting and canoe trips; other programs are free to guests. Some activities are limited and are offered on a first-come, first-served basis. Call the park for schedule details. Lodge room rates start at \$69 a night. Call 1-800-325-0063.

Kenlake State Resort Park, Aurora

Kenlake State Resort Park is offering packages through March 24 that combine overnight lodging with court time at the park's tennis center. The packages include one night's lodging, continental breakfast and two hours of court time for \$69.95 plus tax. (Available for one or two adults and up to three children). Packages with one- or two-bedroom cottages are also available starting at \$89.95 plus tax per night. Kenlake sits along Kentucky Lake and also has hiking trails, fish-

ing, golf, playgrounds and more. Call 1-800-325-0143.

Rough River Dam State Resort Park, Falls of Rough

Rough River Dam State Resort Park is offering a lodge package starting at \$69.95 that includes one night's lodging and breakfast for the family. Also available is a cottage package for \$139.95 for a family of four (two adults and two children 12 and under) that features one night in a cottage, dinner and breakfast. The park has many outdoor recreational opportunities such as tennis, basketball, trails, fishing, golf and a playground. Package good through May 8. Call 1-800-325-1713.

The Kentucky State Park System is composed of 51 state parks plus an interstate park shared with Virginia. The Department of Parks, an agency of the Tourism, Arts and Heritage Cabinet, operates 17 resort parks with lodges — more than any other state. For more information on Kentucky parks, visit our website at <http://www.parks.ky.gov>.

**SAVE UP TO 50%
OFF YOUR NEXT HEATING BILL**

**Advanced Portable Infrared iHeater®
Saves Money NOW...Saves Money LATER!**

- ✓ Heats up to 1000 sq. ft. evenly for about \$1 a day
- ✓ Safe around kids and pets
- ✓ Cannot start a fire
- ✓ FREE shipping
- ✓ Full factory warranty
- ✓ NEW low price!



Was \$495
Now \$279
Call 1-888-506-8271

Phone lines open 7am-11pm EST
7 days a week
Media Code: 6177

Strict limit of 2 heaters per household

Shawn iHeater
iHEAT001d
iHEAT001d
iHEAT001d
iHEAT001d
iHEAT001d

See our new

e-Edition

Same format as our print edition
online @ www.floydcountytimes.com

More News

AppalReD legal aid helps disaster victims

AppalReD Legal Aid, provider of free civil legal services to people who are living at or below the federal poverty level, is able to provide free civil legal assistance to disaster victims in Magoffin, Martin, Johnson, Laurel and Lawrence counties.

Often during disasters, legal problems are the last thing on people's mind. However, issues pertaining to lost property, insurance, mortgage, unemployment and food-stamp benefits often occur. AppalReD Legal Aid can help disaster victims with these legal problems and many others. In times of disaster and distress like we are seeing in Kentucky, there are extraordinary things AppalReD can do to help people who would not ordinarily qualify for services.

"AppalReD is here to help people in our community. Some programs help our community with food or shelter, AppalReD can help with legal needs," says Jonathan Picklesimer, Interim Executive Director of AppalReD Legal Aid. "We will be at relief sites over the next week to talk with people and help as much as we can."

If you need civil legal assistance for a problem arising from the March 2, 2012 Tornado disaster and

you live in Laurel County, please contact the AppalReD Legal Aid Office in Barbourville, at 800-441-5115. If you are a resident of Martin, Magoffin, Johnson or Lawrence County and need legal assistance, please call 800-556-3876.

Commonwealth Cleanup slated for March 17-24

Volunteers from across Kentucky are set to fill trash bags and pick up old tires March 17-24 during the 14th Commonwealth Cleanup Week.

The annual weeklong event is implemented by the Energy and Environment Cabinet (EEC) and kicks off the Great American Cleanup, spanning from March through May. Its purpose is to provide Kentucky communities with an opportunity to "spring clean," recycle and promote personal responsibility across the Commonwealth.

EEC Secretary Len Peters said Commonwealth Cleanup Week establishes civic pride and allows citizens to take ownership of their communities' environment. "I am impressed each year with the number of Kentuckians who participate in this annual event. Thousands give their time to numerous cleanup projects, picking up litter and trash from our roadways, valleys and streams, and recycling where possible."

"I know that we've accomplished a great deal in the past 14 years, but we can work to make this year's cleanup better than the last and to keep up the momentum throughout the year."

During the 2011 cleanup week, more than 34,000 Kentuckians picked up 36,774 bags of trash and 2,481 tires along 4,212 miles of roadway. In addition, these same volunteers cleaned nine illegal dumps.

The timing of this initiative also helps prepare our state for visitors and tourists who visit Kentucky their travel destination during the spring and summer months.

Kentucky Educational Television (KET) will promote this year's event, and Kentucky Life host Dave Shuffett will be taping a special "Dave Does It" segment during Commonwealth Cleanup Week.

Nonprofit groups that register with their county solid waste coordinator and complete a Commonwealth Cleanup Week cleanup are eligible to win one of six \$100 cash prizes in a random drawing.

Visit the DWM's website at <http://www.ky.gov/RLA/Pages/CCW.aspx> for scheduled events and a listing of county solid waste coordinators in Kentucky.

UPike students to host benefit concert

PIKEVILLE — The University of Pikeville Student Government Association will host Sundry Best in concert to benefit victims of the recent tornadoes in Eastern Kentucky.

The concert will be held Wednesday, March 14, at 7 p.m. in Booth Auditorium. Sundry Best, composed of UPike alumni Nick Jamerson and Kris Bentley, both of Prestonsburg, are currently recording their first studio album.

Admission is \$5. UPike students are admitted free with UPike ID and a donated item. All proceeds and items will benefit tornado victims.

For more information, contact Kayla Bandy at (606) 218-5229.

WWW.KYPRIDE.ORG
888-577-4339 (TOLL FREE)

PRIDE provides funds for spring cleanup

SOMERSET — PRIDE will reimburse Floyd County, Prestonsburg, Allen, Martin, Wayland and Wheelwright up to \$7,250 for leading the local PRIDE Spring Cleanup Month in April.

Floyd County is eligible for \$6,000. Prestonsburg, Allen, Martin, Wayland and Wheelwright are eligible for \$250 each. The funding levels are based on the number of road miles in the county and cities.

The PRIDE funds will offset costs to the county and cities for removing litter and dumps and for offering free trash drop-off events. The funds also may help communities clean up debris from recent storms.

PRIDE also will give the county and cities T-shirts and cleanup supplies to distribute to Spring Cleanup volunteers.

"Volunteers have such a good time cleaning their community together, and they are really successful at picking up litter," said Tammie Wilson of PRIDE, the nonprofit organization that organizes the annual Spring Cleanup campaign in 38 counties of southern and eastern Kentucky.

"Disposing of the trash volunteers collect costs money, and that's where the Spring Cleanup Funds come in," Wilson continued. "The funds also help local governments pay contractors to remove dumps that are too big or dangerous for volunteers."

"This is the 15th anniversary of PRIDE, and we can celebrate a visible difference in our region," Wilson added. "PRIDE volunteers have picked up 699,442 bags of trash since 1997, and 2,869 illegal dumps have been eliminated from our landscape."

"It all starts with one cleanup and one volunteer you," Wilson said. "Please answer the call for volunteers as your local leaders announce Spring Cleanup events. Stay tuned to your local media and kypride.org."

During PRIDE Spring Cleanup Month in April, PRIDE works with communities to create a clean, healthy environment just in time for new recreation and tourism seasons. Local governments organize Spring Cleanup events, and PRIDE provides cleanup supplies, T-shirts and funding assistance.

All local governments in PRIDE's 38-county service area are eligible for Spring Cleanup funds, thanks to a grant from the National Oceanic and Atmospheric Administration. To qualify for its available funds, each local government must attend PRIDE training and comply with funding guidelines.

The region-wide Spring Cleanup is also made possible by these sponsors: Waste Connections of Kentucky (Gold Sponsor), Outdoor Venture Corporation (Silver Sponsor), New Horizon Graphics (Bronze Sponsor) and Lightyear Network Solutions (Bronze Sponsor).

To volunteer to pick up litter during PRIDE Spring Cleanup Month, please call your local PRIDE Coordinator. PRIDE Coordinators' names and phone numbers are available by calling PRIDE, toll free, at 888-577-4339 or by visiting www.kypride.org/service-area.

MSU West Liberty campus to reopen March 15

WEST LIBERTY — Morehead State University at West Liberty will reopen Thursday, March 15, for all classes and related activities.

The center had been closed since the March 2 tornado struck West Liberty.

Since the disaster, several Morgan County offices have relocated to West Liberty Academic Center. MSU has made changes to class schedules to accommodate the move-ins and an updated schedule of classes.

According to Brent Jones, executive director of MSU's distance education and regional campus system, "ITV classes will remain in the same location, but many face-to-face classes have been moved to the ITV rooms or room 105 (computer lab). Also be advised that the 105 computer lab will be operated as an open computer lab when it is not being used as a classroom, and a schedule will be posted by the door."

Jones also noted that MSU's Office of Information Technology will continue to record ITV classes through March 16, and after that date, will return to an as-needed basis for taping ITV classes.

MSU at West Liberty also is serving as a Volunteer Center (606-783-8756) to request assistance with property cleanup, relief efforts, or to volunteer.

MSU has set up a website at www.morehead-state.edu/msucare with information for students, faculty, staff, alumni and community with resources on how to assist and what to do if you are an MSU student or employee affected by the storms. Inquiries may also be made by phone to 606-783-9055.

Students, faculty and staff with questions about classes and other activities scheduled for MSU at West Liberty may call 606-783-5381.

Visit us online at www.floyd-countytimes.com

Kentucky ranked sixth in nation for obesity, fourth in high blood pressure, second for diabetes

A new report shows 29.5 percent of Kentuckians are obese, sixth highest in the nation. The state ranked second in the nation for the highest percentage of diabetes, with 13.7 percent of Kentucky residents diagnosed with the disease, and fourth in high blood pressure, at 36.3 percent.

According to the Gallup-Healthways Well-Being Index, West Virginia

had the highest rates of obesity (35.3 percent), diabetes (15.7) and high blood pressure (38.9) in the country. Colorado had the lowest, with 18.5, 6.8 and 22.6, respectively. Colorado "is the only state where fewer than 20 percent of adults are obese," reports Elizabeth Mendes for Gallup. West Virginia's obesity rate is the highest for any state since the study began in 2008.

The survey asked respondents if they had been diagnosed with diabetes or hypertension. To measure obesity, participants were asked to report their height and weight, allowing Gallup to calculate their body mass index," reports The Huffington Post. A person with a BMI of 30 or higher is considered obese.

The family of Shaun Michael Shelton would like to thank Nelson Frazier Funeral Home, Rev. Donnie Patrick, Faith Freewill Baptist Church and everyone who brought food. Perhaps you sent a lovely card, or sat quietly in a chair, perhaps you sent a floral piece, if so we saw it there. Perhaps you spoke the kindest words as any friends could say, perhaps you were not there at all, just thought of us that day.

Whatever you did to console our hearts, we thank you so much whatever the part.

The Family of Shaun Michael Shelton

The Point

Worth Repeating...

A liberal is a man who is right most of the time, but he's right too soon.

— Gregory Nunn

Amendment I

Congress shall make no law respecting an establishment of religion, or prohibiting the free exercise thereof; abridging the freedom of speech, or of the press; or the right of the people to peaceably assemble, and to petition the government for a redress of grievances.

HB 260: Good, but could be better

Paul E. Patton
President, University of Pikeville

Make no mistake about it, Speaker Stumbo, Representative Combs and I are still convinced that if there had been a state university in Southeastern Kentucky for the past 90 years as there has been in Northeastern Kentucky, our region and the Commonwealth would be a much different and much better place today. We will not give up on that goal but we will not let the perfect deny us the good. And that is what the revised HB 260 is. While a state university in any region has a multitude of positive impacts on that region, a major argument on behalf of taking the University of Pikeville into the state university system was, and still is, to give our students the opportunity to attend a quality university within the region and at the same cost as the students in the rest of the state pay to attend a state university.

HB 260 will bring us closer to that goal. The revised proposal will provide as much as \$6,000 to students from the region to attend one of the four bachelor-degree-granting colleges in the region. These colleges are Alice Lloyd, Union, the University of the Cumberlands and the University of Pikeville. Now, they must leave the region to attend the more economically sound universities and many of them never return. This \$6,000 will make the cost of attendance at one of the four institutions comparable to, but not less than, the cost of attendance at a state university. Students could also receive a \$2,000 scholarship to attend a state university extension campus that is located within the region.

The problem is not with the low-income students, although they will get a grant under the revised proposal. Currently, a student with an 18 ACT and a \$1,500 KES scholarship from a family of four with an income of \$30,000 a year will pay no tuition at the University of Pikeville and still have the \$1,500 KES scholarship available to buy books and other expenses. Any new grant they receive can be used to pay living or transportation expenses. That same student from

a middle class family with an income of \$61,000 will pay \$13,050 for tuition after receiving a \$3,200 institutional grant from the University. The maximum grant under the revised HB 260 will reduce that amount to \$7,050, almost exactly equal to the tuition at Morehead and Eastern. We desire no advantage over these two great universities, just equality.

If it is wrong to give grants to students from middle class families, then it is wrong to give \$1 billion to the state universities because that is a subsidy to every student enrolled there, poor and wealthy alike. The middle class should be served by government just like the poor. The University of Pikeville has served low income families for 123 years. Sixty-eight percent of our students from this region receive state and federal need-based grants but 32% do not.

No, this bill will not do as much as the original HB 260. It only devotes \$525,000 to helping high school and community and technical college students work towards a bachelor degree instead of the \$2 million the University of Pikeville planned to spend. But then it only anticipates half as much money. It will give our students the option to get a bachelor degree in our region at about the same cost as they will pay if they chose to attend one of the other good state universities outside the region but it won't hold them hostage to the region by forcing them to either come back or repay a forgivable loan.

This is not a cure-all. It is very narrowly focused on making the last two years of a four-year bachelor degree course of study in the region cost-competitive with the same course of study outside the region. It will not generate any more money to these in-region colleges than they will receive if the student chooses to pay the full amount to attend the school without the new grant. It will result in more of our students getting a bachelor degree and more of them will stay in the region. Only time will tell how many HB 260 is good, but could be better!

Guest View



KILLED BY THE TALIBAN AND INSURGENTS

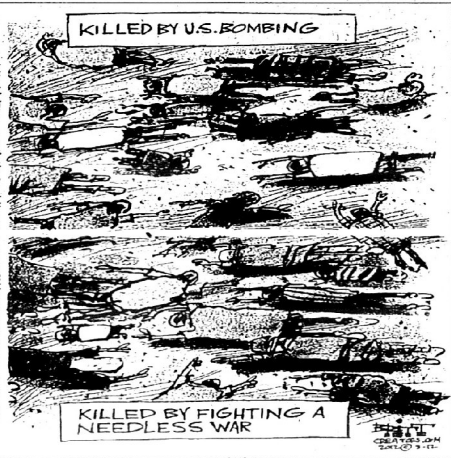

KILLED BY U.S. BOMBING

KILLED BY U.S. ARMY SERGEANT

KILLED BY FIGHTING A NEEDLESS WAR

A legislative perspective

Rep. Greg Stumbo
Speaker of the House

During each year's legislative session, no month is busier than March. The issues that have been debated for weeks begin moving toward their conclusion during this time, and the later we go in the month, the bigger the votes become.

Last week, the Kentucky House of Representatives put its stamp on what I think are the session's two most prominent issues when the chamber overwhelmingly approved its budget and the legislation I'm sponsoring in crack down on prescription drug abuse.

The budget is important, of course, because it dictates state government spending for the next two years. We have known for some time that this one, which will take effect in July and run through June 2014, would be the toughest any of us have seen.

That's because, over the last several years, we have already made about \$1.3 billion in cuts and are facing the prospect of reducing spending by several hundred million dollars more to keep the budget balanced, as we're constitutionally required to do.

It's important to note that, since this recession began, Kentucky has been able to avoid taking the drastic steps many other states have taken, some of which have laid off thou-

sands of teachers and state employees and raised taxes significantly.

The proposed budget that the Kentucky House of Representatives passed last week maintains that positive trend.

Our plan largely follows what Governor Beshear proposed when he presented his budget about two months ago. The House agrees that we must live within our means, but to do that, most state agencies would see cuts of 8.4 percent, though some areas would see less or even a modest increase.

For example, we don't cut the overall total for the per-pupil funding formula known as SEEK, but we understand a growing student population means schools would have to stretch that money a little further.

The House trims post-secondary schools by about six percent, and we also limit how many new facilities they would like to build with their own revenue. We want to make sure our debt level remains reasonable and the schools don't take on more than they can handle financially given the state's limited resources.

There are no proposed cuts to student financial aid in the House budget, and that includes the lottery-based KES scholarships that high schoolers earn for college.

The House budget differs slightly from the governor's

in a couple of key areas in education. We provide more money for schools' family resource centers and programs like gifted education, and more would be given to KES because further cuts could significantly hamper its ability to meet its statewide mission.

We also believe more money is needed for Meals on Wheels and other services helping the elderly, and we add more money to help better maintain our state parks.

The overall theme of this budget is fairness. We recognize that some areas, such as the classroom, need to be protected as much as possible, but in other cases, we tried to spread the cuts as broadly as possible. That means all three branches of government are taking the same reduction, and that state employees and their retirees alike will not see any raises.

The next two years will be difficult, but there is hope that, if state revenues continue growing, it's possible that the outlook will brighten in the months ahead.

In the other major vote last week, the House approved my two-pronged proposal to dramatically increase the number of doctors and pharmacists using KASPER, the state's prescription drug monitoring program, and moving KASPER from the Cabinet for Health and Family Ser-

vices to the Attorney General's office.

This approach will make it much easier for law enforcement to spot unwanted spikes in prescription drug use and then move quickly to stop it. KASPER has been very effective in telling us where the problem areas are, but it hasn't been used to its full potential. My bill, I believe, would fill that gap.

For now, the House awaits whatever changes the Senate might propose to that bill as well as the budget. If all goes as scheduled, compromises on both will be voted on by the end of the month.

On a more personal note, I want to add that the General Assembly is committed to doing all it can to help those victims who lost so much from the devastating storms on March 2nd. My colleagues in the House and I and the legislature's staff have raised more than \$20,000 to donate to those most affected (We're hoping to reach \$25,000), and we will do whatever it takes to help these communities get back on their feet.

As always, I value your opinion on legislative matters and would enjoy hearing your thoughts or suggestions on the issues of the day. You can leave a message for me or for any legislator at 800-372-7181. For those with a hearing impairment, the number is 800-896-0305.

House week in review

Rep. Hubert Collins

Heartbroken over the

loss of life and property in Kentucky counties ravaged by last week's tornadoes,

state lawmakers returned to Frankfort last week to face the hard, but necessary, task of voting on an Executive Branch budget bill that would represent yet another round of cuts from already stripped-bare state agency budgets over the next biennium.

The \$19.5 billion Executive Branch budget plan in House Bill 265—which passed the House 78-17 last Wednesday—closely mirrors the governor's proposal to cut an additional 8.4 percent from most agency budgets over the next two years. Like previous cuts approved in recent years, the new round results from the anemic economy, which has plagued the state since revenues bottomed out at a -2.7 percent "growth" rate in 2009. All this is tied to the terrible lingering recession that began in 2007. Kentucky has recently experienced an encouraging turnaround in growth and revenues, but the bottom line is, we're not

even back to even.

State agencies are as tired of budget cuts as the rest of us Kentuckians are tired of the slow economy and poor job market. And the agencies have a right to be stressed and weary. Over \$1 billion has been cut from agency appropriations in Kentucky over the last four years—yes, that's billion with a 'b'.

Now, with another 8.4 percent in planned reductions in the budget we passed last week, the overall percentage of cuts to Executive Branch services since the start of the recession is well over 30 percent for many agencies, with some seeing cuts as large as 38 percent since 2007.

Another round of cuts will be hurtful, to put it mildly. But our commitment to passing a responsible budget without any accounting trickery or further putting off the day of reckoning requires we do what we must this year to get our finances under control. It's bite-the-bullet time.

The Times

Published Wednesday and Friday each week

263 SOUTH CENTRAL AVENUE
PRESTONSBURG, KENTUCKY 41653
Phone: (606) 886-8506
Fax: (606) 886-3603
www.floydcountytimes.com

Entered as second class mailer, June 18, 1927, at the post office at Prestonsburg, Kentucky, under the act of March 3, 1879. Periodicals postage paid at Prestonsburg, Ky.

SUBSCRIPTION RATES PER YEAR:
In Floyd County: \$83.00
In Kentucky: \$84.80
Outside Kentucky: \$125

Postmaster: Send change of address to:
The Times
P.O. Box 330
Prestonsburg, Kentucky 41653

PUBLISHER: Joshua Byers
MANAGING EDITOR: John B. Davis
byers@heartlandpublications.com
web@floydcountytimes.com

ECT Poll

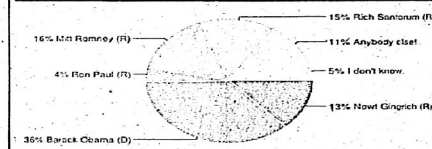

Who do you currently favor in the presidential race?

36 percent, Barack Obama (D)
16 percent, Mitt Romney (R)
15 percent, Rich Santorum (R)
13 percent, Newt Gingrich (R)
11 percent, Anybody else!
5 percent, I don't know
4 percent, Ron Paul (R)

Visit FloydCountyTimes.com to answer this week's question: After witnessing recent weather, do you feel like you are prepared for a natural disaster?

Disaster cleanup carries health risks

The Kentucky Department for Public Health is reminding Kentuckians about guidelines for safety during post storm clean-up regarding tetanus, mold cleanup and food safety. The guidelines come after Friday's severe storms and tornadoes that caused widespread damage, injuries and loss of life.

"Emergency situations like this one emphasize the importance of preparedness in the home," said Steve Davis, M.D., acting DPH commissioner. "Those without power in storm damaged areas should remember that public health safety measures such as food safety, mold cleanup and tetanus can be serious and, in some

cases, even life-threatening. By following safety recommendations, illnesses can be prevented."

Tetanus

- Avoid contact with flood waters. Flood waters are unclean and can be a risk for tetanus for those who have open wounds that come into direct contact with them. Contact your regular health care provider or your local health department if you believe you may need a tetanus shot.

Mold Cleanup

- Mold may be present in homes that were flooded. An air conditioner or dehumidifier may be used to lower the level of humidity to prevent mold growth. Use exhaust fans

when showering and cooking.

- When cleaning up small areas affected by mold, make sure the area has enough air by opening doors or windows. Use protective glasses or goggles, rubber boots and waterproof gloves. Wash clothing afterwards. If there is heavy mold growth, use a respirator or suitable mask to prevent breathing the mold.

- Remove all wet items that have been wet for more than 48 hours and are not able to be cleaned and dried.

- If mold is growing in your home, you will need to clean up the mold and fix the moisture problem. Mold growth can be re-

moved from hard surfaces with commercial products, soap and water, or a bleach solution of no more than 1 cup of bleach in 1 gallon of water. Severe mold cases may require an expert to clean up.

Food Safety

- If you have power outages keep freezers closed to help keep frozen food from going bad. A full freezer will keep the temperature for about 48 hours and for 24 hours if the freezer is half full.

- Refrigerated foods should be safe as long as power is out for no more than four hours. Throw away any perishable food in your refrigerator, such as meat, poultry, lunchmeats, fish, dairy products,

eggs and any prepared or cooked foods that have been above 40 degrees Fahrenheit for two hours. Fresh fruits and vegetables are safe as long as they are still firm and have no mold or slimy feel.

- To remove spills and refresh the freezer and refrigerator, DPH recommends washing with a solution of 2 tablespoons of baking soda dissolved in 1 quart of warm water. To get rid of any odors, place an open dish of baking soda in the freezer or refrigerator.

In addition to these common post-storm risks, cold winter temperatures can make staying warm and safe a challenge, especially during long-term

power outages. DPH strongly encourages residents to be aware of the dangers of carbon monoxide poisoning when using alternative heating sources such as portable generators and kerosene heaters. Kentuckians should also be aware that exposure to cold temperatures (whether indoors or outside) can also cause life-threatening health problems such as hypothermia, which occurs when the body's temperature drops below what is necessary for normal body functioning. For more information about cold weather risks, visit <http://healthalerts.ky.gov/Pages/WinterSafety.aspx>.

FEMA, AmeriCorps partner on disaster relief

WASHINGTON — The Department of Homeland Security's Federal Emergency Management Agency (FEMA) and the Corporation for National and Community Service (CNCS) on Tuesday announced an innovative new partnership designed to continue to strengthen the nation's ability to respond to and recover from disasters while expanding career opportunities for young people.

FEMA Corps is a historic collaboration which will create a new unit of AmeriCorps' National Civilian Community Corps (NCCC) whose members will be devoted solely to FEMA disaster response, and recovery efforts. The five-year agreement provides for a full service corps of 1,600 members annually who will be an additional workforce in support of FEMA's current disaster reserve workforce.

"The initiative we're launching today underscores our commitment to

shared responsibility and strong partnerships to help communities across the United States more effectively prepare for, respond to, and recover from disasters of all kinds," said Secretary Napolitano. "This new partnership will help us respond to disasters in a way that is cost-effective, and that draws on the strengths of our communities and our people."

This new effort will promote an ethic of national service and civic engagement by mobilizing corps members and community volunteers to provide critical disaster services. Once trained by FEMA and CNCS, members will provide support in areas ranging from working directly with disaster survivors to supporting disaster recovery centers to sharing valuable disaster preparedness and mitigation information with the public. The first members will begin serving in August 2012 and

the program will reach full capacity within 18 months.

"This new partnership is important for many reasons but none more important than the positive impact it will have on disaster survivors," said FEMA Administrator Craig Fugate. "FEMA Corps will strengthen the nation's disaster response by providing a dedicated, trained and reliable workforce—to support disaster survivors and impacted communities during their greatest time of need. At the same time, we hope to inspire a generation of young people to take up careers in emergency management."

"By opening up new pathways in emergency management, this partnership will give thousands of young people the opportunity to serve their country and gain the skills and training they need to fill the jobs of today and tomorrow," said Acting CEO of the Corporation for National and

Community Service Robert Velasco. "This is a historic new chapter in the history of national service that will enhance our nation's disaster capabilities and promote an ethic of national service while achieving significant cost savings for the taxpayer."

The NCCC members will strengthen the Nation's disaster response capacity and increase diversity of the disaster workforce, while providing educational and economic opportunities for young people as they consider their future careers. FEMA Corps members will serve for a 10 month term with an option to extend for a second year. The program will prepare thousands of young people for careers in emergency management and related fields. During their service, they will gain significant training and experience in disaster services and will provide important support to disaster survivors.

"President Obama has made it clear that government alone can't solve all our problems," said Director of the White House Domestic Policy Council Cecilia Muñoz. "But government has a vital role to play and the program we're announcing today is a perfect example of a government that's leaner, more efficient, and making a difference in people's lives."

"This new partnership between FEMA and the Corporation for National and Community Service (CNCS) will be crucial in supporting cities, counties and states in their time of need," said Tuscaloosa Mayor Walter Maddox. "I commend FEMA and CNCS for understanding that to effectively respond during a crisis, we have to extend beyond political, geographical and even bureaucratic boundaries to ensure all resources are made available to the citizens we serve."

While strengthening the nation's disaster response capacity with a trained and reliable resource, this initiative will achieve significant cost savings for taxpayers. When the program is at full operational capability, and in an average disaster year, the initiative is expected to see a savings of approximately \$60 million in a year. Moreover, as a partnership between CNCS and FEMA, the program represents a smart modernization of government operations. Rather than creating duplicative structures, this collaboration will advance the President's management goals of working across government, managing across sectors, and promoting efficiency.

To learn more about FEMA Corps or to apply (individuals aged 18-24), please see the AmeriCorps website at <http://www.nationalservice.gov> or FEMA's website at <http://www.fema.gov/>.



Joel A. Shapiro, MD, PhD

Bringing the Best in Cardiology to Eastern Kentucky!

Cardiac Services

- Cardiac Cath
- EKG
- Cardiac CT
- Holter Monitoring
- Echocardiography
- Nuclear Imaging
- Stress Testing
- Peripheral Arterial Disease



Now Accepting Patients

HIGHLANDS
HEART & VASCULAR CENTER

Highlands Medical Office Building | 3rd Floor | Prestonsburg, KY | (606) 889-6210 | hirmc.org



www.floydcountytimes.com

House passes Stumbo's bill to limit prescription drug abuse

FRANKFORT — House Speaker Greg Stumbo's legislation to make it easier to identify and stop prescription drug abuse easily passed the Kentucky House of Representatives last week, moving a top priority of his, Governor Beshear's, Attorney General Jack Conway's and many others a step closer to becoming law.

"Prescription drug abuse has long been a major problem for Kentucky, but it has gotten significantly worse in recent years," said Speaker Stumbo, D-Prestonsburg. "What is especially troubling is that most of these drugs are being prescribed right here in the Commonwealth. The one area where we should have the most control is the one area where the

ball has been dropped. Today, the House made a statement that this is going to change."

"House Bill 4 offers a broad range of essential improvements that will allow us to attack the prescription drug epidemic more effectively," Governor Beshear said. "From enhancements to KASPER to increased scrutiny of pill mills, House Bill 4 will give Kentucky a more muscular response to this scourge."

"I applaud Kentucky House members for recognizing the importance of enacting sweeping prescription drug legislation during this legislative session," said Attorney General Jack Conway, whose office would play a much more prominent role if House Bill 4 is

enacted. "I am proud to have worked with Speaker Stumbo and Gov. Beshear on this bill to give law enforcement increased access to KASPER data and to keep entrepreneurs out of the pill mill business," State Rep. John Tilley, who chairs the House Judiciary Committee and is playing a major role in curbing drug abuse this legislative session, said. "House Bill 4 would be a sizeable leap forward in getting prescription drugs out of the hands of those abusing them. It will help us put a stop to one of the key drivers behind the past decade's prison population growth."

The hallmark of House Bill 4 is moving the state's nationally recognized KASPER program — which stands for

Kentucky All Schedule Prescription Electronic Reporting — to the Cabinet for Health and Family Services, less than a third of prescribers and less than a fourth of pharmacists had accounts as of 2010. Once registered, prescribers will be required to run KASPER reports on all new patients and periodic checks on those they already see.

To help stop the proliferation of pain clinics, Speaker Stumbo's legislation would require these businesses to be owned by a licensed physician or an Advanced Practice Registered Nurse. Prescribers charged with abusing their prescription privileges would be barred from prescribing medicine, and those found guilty — either here or in another state —

would be required to register with KASPER. According to the Cabinet for Health and Family Services, less than a third of prescribers and less than a fourth of pharmacists had accounts as of 2010. Once registered, prescribers will be required to run KASPER reports on all new patients and periodic checks on those they already see.

To help stop the proliferation of pain clinics, Speaker Stumbo's legislation would require these businesses to be owned by a licensed physician or an Advanced Practice Registered Nurse. Prescribers charged with abusing their prescription privileges would be barred from prescribing medicine, and those found guilty — either here or in another state —

would see their prescription privileges stripped. Speaker Stumbo's legislation also limits Schedule II and III drugs to 30 day supplies, though prescriptions for these drugs — including such things as OxyContin — could still, in some cases, be written for 90 days.

"Prescription drug abuse has destroyed so many of our families, so the need to stop this as quickly as possible is an absolute necessity," Speaker Stumbo said. "I stand ready to work with the Senate, Governor Beshear and Attorney General Conway to continue to develop a comprehensive plan that will enable us to achieve this goal."

House Bill 4 now heads to the Senate for its consideration.

Pikeville SBDC to host seminar March 27

PIKEVILLE — "Creating Financial Projections for Planning, Financing and Goal Setting" is a free seminar to be presented by Morehead State University's East Kentucky Small Business Development Center Tuesday, March 27. The seminar for present and prospective small business owners will be conducted at the Big Sandy Community and Technical College, 120 S. Riverfill Drive from 5-7 p.m. The presenter will be Mike Morley, director of the MSU East Kentucky Small Business Development Center. Topics to be discussed will be: creat-

ing projected income statements, cash flow statements and balance sheets.

Training programs, sponsored or co-sponsored by SBDC, are available to all individuals without regard to race, color, sex, creed or national origin.

For a list of upcoming events, you may visit the MSU SBDC website at www.moreheadstate.edu/sbdc.

Additional information and preregistration are available from Linda Casebolt or Morley at (606) 432-5848 or visiting the website at www.kysbdc.org.

DFI warns of after-storm scams

FRANKFORT — This National Consumer Protection Week, it is important to beware of scams and frauds, especially in the wake of recent storm damage across the state.

Often after disasters, scams linked to charities, contractors and others seek to cash in on insurance settlements and potential financial relief from the government. The Department of Financial Institutions (DFI) reminds consumers to double check special storm damage "deals" and offers that sound too good to be true.

"Con artists pay attention to the headlines and don't hesitate to take advantage of a terrible situation in order to scam victims in need of food, clothing and shelter," said DFI Commissioner Charles Vice. "The best way to protect yourself is to recognize and avoid fraud."

Common scams after a storm include the following:

Charity scams — Many people are ready to give after a storm, and scammers are ready to cash in on sympathy for victims. Only donate to charities you know and trust. Ask what percentage of the donation goes to the charity. Check out a charity with the Better Business Bureau at www.give.org.

Home improvement fraud — Self-proclaimed contractors may go door-to-door offering to help victims repair their homes or clean up debris. Or they may claim to have supplies left over from doing another job and offer to work at a discount to you. Be suspicious if the price seems too good to be true or if the workers are not known in your area. Don't pay for services until the work is complete and always verify licensing of HVAC, electrical and plumbing contractors with the Department of Housing, Building and Construction at <https://kyjoportal.com/License/Search>. You can also check out your contractor with the Better Business Bureau at www.bbb.org.

Insurance fraud — Don't let anyone pressure you into filing a phony insurance claim. Lying to an insurance company in an attempt to get money is fraud and illegal.

Spam, phishing attempts — Emails that appear to come from your bank, creditor or a charity may actually be an attempt to steal your identity or account information. Remember

that financial institutions will never contact you requesting this information.

"If you suspect fraud, report it to local law enforcement, the Better Business Bureau or a state regulatory agency," said Vice. "Reporting fraud is the best way to keep others from falling victim."

The following are a few additional tips for protecting yourself from scams:

- Don't give out personal or financial information unless it's absolutely necessary. Ask for identification before doing so.

- Don't pay in cash. Using a check or money order will ensure your donation or payment goes to the correct organization and you have a record for tax purposes.

- Don't pay for service work until the service is complete and you're satisfied with the results.

- Get more than one estimate for repairs or service.

- Read and understand a contract before signing. All promises should be made in writing.

- Shop around, but be careful of "disaster" sales that may just be gimmicks.

- Be suspicious of great promises and fabulous offers.

The 14th annual National Consumer Protection Week is March 4-10, 2012 and is sponsored by the Federal Trade Commission and other government agencies and nonprofit organizations. The website www.nepw.gov offers a variety of free resources to help consumers protect their

privacy; manage money and debt; avoid identity theft; understand mortgages and other loans; and recognize fraudulent scams that target consumers.

Report suspected disaster fraud to the National Center for Disaster Fraud (NCDF), toll-free at 866-720-5721.

Also, you can find more information on avoiding scams on DFI's website at <http://kfi.ky.gov/public/Pages/scam.aspx>.

DFI, which traces its origin to the Banking Act of 1912, is an agency in the Public Protection Cabinet. For 100 years it has supervised the financial services industry by examining, chartering, licensing and registering various financial institutions, securities firms and professionals operating in Kentucky. DFI's mission is to serve Kentucky residents and protect their financial interests by maintaining a stable financial industry, continuing effective and efficient regulatory oversight, promoting consumer confidence, and encouraging economic opportunities.

Information on the disaster recovery, relief efforts, safety tips and important information is available at www.kyem.ky.gov.

The Commonwealth Joint Information Center is available for media inquiries from 7:30 a.m. ET to 11:00 p.m. ET, until further notice.

Kentucky Cares telethon raises over \$400K

Last Friday, the Kentucky Cares Telethon, in partnership with the American Red Cross, WKYT TV, Clear Channel Radio, the Lexington Herald Leader, and UK IMG Sports Marketing, raised \$404,682.

Money raised as part of the Kentucky Cares campaign will support Red Cross relief efforts in Eastern Kentucky.

"Financial support is critical as we begin tran-

sition our operation from immediate emergency relief to more long-term recovery," said Terry Burkhardt, CEO of the Bluegrass Chapter of the American Red Cross.

Over the next several days, Red Cross case workers will meet one-on-one with families to explain the recovery process, help with emergency medical needs and assist those who need help registering for other

relief programs such as aid from the Federal Emergency Management Agency. The Red Cross will also be providing direct financial assistance to people with verified, disaster-caused needs.

"This is a tremendous outpouring of support and we are excited to be able to help those Kentuckians who have been so greatly affected by this disaster," Burkhardt said.

Forget Reapplying!

Look Like Yourself Only Better With Permanent Makeup

Permanent makeup helps give back what time has taken away and saves you precious time you normally spend "putting on your face." You can save countless hours in a single year that were formerly spent struggling to draw eyebrows evenly or eyeliner half-way straight...that's a lot of extra free time! Plus, imagine the money you'll save not buying expensive cosmetics that rub off, smear, smudge and disappear during the day.

- Beautiful Eyeliner
- Lovely Eyebrows
- Fabulous Lipcolor
- Special Needs
- Finest Pigments
- Pain Control

FREE Touch-ups!
Gift Certificates
Available!

The
**Wellness Center -
Med Spa** of Pikeville

884 North Mayo Trail Unit B | Pikeville, KY 41501

432-4445

Your news ... Your newspaper

Floyd County Times

Community News, Sports Scores

Editorials, Church Events

and Breaking News

YOUR NEWSPAPER.

Story idea or news tip?

Call 606-886-8506

2012 GREAT EASTER EGG HUNT

The Floyd County Times

Brock McVey FIXTURE GALLERY

778 SOUTH LAKE DRIVE
PRESTONSBURG, KY 41653
606-886-6801

YOUR #1 CHOICE FOR EVERYTHING ELECTRONIC!

PAYMENT & RETAIL CENTER

OUR GEARHEART PAYMENT & RETAIL CENTER OFFERS YOU EVERYTHING THAT YOU NEED FOR YOUR DIGITAL WORLD:
WIRELESS ROUTERS • TABLETS • PHONES
• BLU-RAY PLAYERS • SO MUCH MORE!
ORDER ONLINE: WWW.GEARHEARTRETAIL.COM

1-800-635-7052

McDowell

McDowell, KY 41647
606-377-1000
mcdowellpharm@bellsouth.net

Hours:
Mon.-Fri., 8-6; Sat., 8-1

Put your trust in the fast, friendly, and experienced staff at McDowell Professional Pharmacy.

Medicine Market PHARMACY

Drive Thru • Free Delivery
"Most Prescriptions Filled in 15 Minutes or Less"

Business Hours:
Mon. - Fri. 8:30 am - 5:30 pm
Sat. - 10:00 am - 2:00 pm
606-285-3400

Located on Main Street in Martin - Across the street from St. Joseph Hospital

PARKVIEW PHARMACY

When time counts, Pharmacists Kristy Moore and Valerie Akers are there to help.

Even the Easter Bunny needs back-up!

Prestonsburg Gun and Pawn, LLC

1122 South Lake Drive
Prestonsburg, KY 41658
606-263-4311
Buy • Sell • Trade

MAC-ARTS

Big Sandy Idol 2012
March 9 - 10, 7pm
Legally Blonde
March 16 - 25, 7pm
Ralph Stanley
April 7, 7pm

TOLL-FREE 1-888-MAC-ARTS

PRESTONSBURG Walmart

Save money. Live better.

YOU CAN WIN \$500.00

No Leaping Tall Buildings in a single bound!
No Climbing Telephone Poles!

JUST FOLLOW THESE OFFICIAL RULES:

1. Follow the clues. A new clue will be printed in the Floyd County Times each publication day between now and Easter.
2. Each clue will be printed in paper only once. Previous clues can be found at Official Sponsor Locations. Clues are posted at Official Sponsor Locations 24 hours after each publication.
3. Discover the egg. The egg is located on public property in an easily accessible hiding place. No Fear Factor® stunts required!
4. Bring the egg and the enclosed certificate to the Floyd County Times Office at 263 S. Central Ave. Prestonsburg, between 9-5 weekdays, and you win \$500!
5. Employees of the Floyd County Times and their families are ineligible to win.
6. The Floyd County Times and the Official Sponsors are not liable for any injuries, damages, or losses resulting from your participation. Your attempt to locate the egg is acknowledgment that you agree and hold said parties harmless.

RENO'S ROADHOUSE

StoneCrest Golf Course

Honda of Prestonsburg

HideHonda.com

RIVERVIEW HEALTH CARE CENTER

79 Sparrow Lane
Prestonsburg, KY 41653
(606)886-9178

"Honoring our Community, one resident at a Time"

THE 2012 GREAT EASTER EGG HUNT!

WIN \$500

Details on page 10B

Prestonsburg Health Care

147 North Highland Avenue
Prestonsburg, KY 41653
606-886-2378 • 606-889-9438

ATTENTION

PRESTONSBURG AREA RESIDENTS

PIKEVILLE MEDICAL
Weight Loss Surgery Center

FREE WEIGHT LOSS SURGERY SEMINAR

with
Dr. Amy Johnson

Tuesday, March 27
6 pm - 7:30 pm
Mountain Arts Center
Prestonsburg

**Get the answers
you need**

**THERE IS HOPE
RECLAIM
YOUR
LIFE**

PIKEVILLE
MEDICAL
CENTER

Dr. Amy Johnson
Bariatric Surgeon

606-218-4811

Kentucky Horse Park opens 34th season with new attractions

LEXINGTON — The Kentucky Horse Park's 34th season is set to begin Thursday, March 15, when the park returns to its regular hours of 9 a.m. to 5 p.m. daily through Nov. 4. Visitors will be entertained and delighted as the park features special events and themed weekends throughout the season.

Highlights of this season will include the park's newest attraction, the Kids Barn, which features interactive exhibits, while the park's education department staff will host daily hands-on activities with the park's resident

horses in the Kids Barn each day.

Also new this season is a daily show called "Horses of the World," which is an updated and energized version of the traditional Parade of Breeds show. It's a perfect opportunity for park visitors to watch and learn about some of the horse breeds that may not be familiar and will include horses representing some of the park's many different breeds from as far away as India, Turkmenistan, Egypt, and Europe.

The park's latest blockbuster, "The Horse," will be in its final weeks of

exhibition in the International Museum of the Horse. It can be viewed through April 6, at which time it will move to San Diego, CA.

Another museum exhibit, "Where were you in '62? Saddlebreds, the Museum and the Sixties" will be on view through the end of the year in the Showplace for Saddlebreds at the American Saddlebred Museum & Gift Shop at the park.

In addition, the Kentucky Horse Park will host literally dozens of horse shows, dog shows, special breeds weekends, and other events, most of

which are included with park admission. Educational classes and youth riding programs will be offered once again through the park's education department.

Daily equine presentations will also include the Hall of Champions, where visitors can meet Kentucky Derby winners Go for Gin and Funny Cide. The always-popular Mare and Foal Show will be offered Memorial Day through July 31.

Events are scheduled every weekend, at the park, and a full listing of these events and their dates is available at www.KyHorsePark.com.

Admission is \$16 for adults and \$8 for children 7-12. Children six and under are always admitted free of charge when accompanied by a paying adult. Admission includes the International Museum of the Horse — a Smithsonian Affiliate — and the American Saddlebred Museum & Gift Shop.

The Kentucky Horse Park is a working horse farm/theme park and equine competition facility dedicated to man's relationship with the horse. The park is an agency of the Kentucky

Tourism, Arts and Heritage Cabinet and hosted more than 825,000 visitors and campers, as well as 15,000 competition horses in more than 200 special events and horse shows in 2011. The park is home to the National Horse Center which comprises more than 30 national and regional equine organizations. Located at Exit 120, Interstate 75, just north of Lexington, the Kentucky Horse Park is the place to get close to horses. Open daily March 15 to Nov. 4, and Wednesday through Sunday, Nov. 5 to March 15.

UK satellite camp set for JCHS

Times Staff Report

LEXINGTON — The University of Kentucky Men's Basketball program is pleased to announce the dates and information for the 2012 John Calipari Satellite Camp Tour.

The 2012 summer tour includes nine stops throughout the Bluegrass in five days during the month of June. These camps offer the unique opportunity for Kentucky Basketball fans to learn from and interact with Coach John Calipari, the UK Coaching staff and available Wildcat players. It is the goal of the

Men's Basketball program to bring the Commonwealth's team to different stops every summer, and allow campers to participate in drills and competitions within their own communities.

The cost for each camp is \$75 per camper, and includes Camp T-shirt, three hours of instruction with Coach Calipari and the Kentucky Basketball staff, competitions, autograph sessions along with question and answer sessions with Coach Calipari.

The 2012 Satellite Camp tour dates and locations are:

Monday, June 11

Morning Session (9-Noon EST) at Corbin HS - Open to grades K-12.
Afternoon Session (1:30-4:30 EST) at Boyle County HS - Open to grades K-12.

Tuesday, June 12
Morning (9-Noon EST) at Ryle HS - Open to grades K-12.

Afternoon (1:30-4:30pm EST) at Campbell County MS - Open to grades K-12.

Wednesday, June 13
Morning (9-Noon EST) at Johnson Central HS - Open to grades K-12.

Afternoon (2-5pm EST) at Montgomery County HS - Open to grades K-12.

Thursday, June 21
Morning (9-Noon EST) and Afternoon (1:30-4:30 pm) both at Christian Academy of Louisville - Both Camps open to grades K-12.

Friday, June 22
Morning (9-Noon CST) at Bowling Green HS - Open to grades K-12.

Afternoon (3-6pm EST) at Nelson County HS - Open to grades K-12.

Due to gym capacities there will be a limited number of spots available for all camps. Online registration is recommended as the fastest and most efficient form of registering campers.

All Satellite Camps are open to both boys and girls of the appropriate age/grade level, which may vary between locations. Camper's grade level is based on the grade in which the camper is enrolled during the 2011-12 school year.

On-Site camp registration will begin one hour prior to the designated start time. All pre-registered campers will receive a confirmation email for their specific camp that includes details of necessary paper work needed (Physical, Insurance, and Consent). It is important to insure the safety and

participation of all campers, that the basketball office receives all necessary paper work two weeks prior to the start of your specific camp date.

Walk up registration will be available at all camps unless noted on the UK Athletics website as closed. Once each individual camp has reached its maximum capacity, then that particular camp will be closed to all forms of registration (Online and Walk ups).

Any camp related questions can be called into the Men's Basketball Camp line at 859-257-9457.

Anthony Davis named USBWA Freshman of the Year

Times Staff Report

ST. LOUIS — The U.S. Basketball Writers Association (USBWA) has selected Kentucky freshman Anthony Davis as the men's National Freshman of the Year in conjunction with the 2012 Wayman Tisdale Award.

The Chicago, Ill., native was selected as a first-team All-American selection by the USBWA on Monday. He averaged 14.3 points and 10.0 rebounds per game en route to leading the Wildcats to a No. 1 overall ranking in the

NCAA Tournament and a perfect 16-0 record in Southeastern Conference action.

Davis is the second Kentucky player in three years to win the USBWA's National Freshman of the Year Award, joining John Wall, who won the award in 2010. Davis, the USBWA's District IV Player of the Year, is also a finalist for the Oscar Robertson Trophy, given to the National Player of the Year by the USBWA.

He has started all 34 games this season while shooting 64.2 percent

from the field, which ranks as the second best in the nation. Davis also leads the nation in blocks (157). In 28 of the Wildcats' 34 games, he has scored in double figures while recording 17 double-doubles. The 17 double-double efforts rank as the second-highest total in a single season by a UK freshman.

The other four finalists for the award this season were Davis' teammate Michael Kidd-Gilchrist, Duke's Austin Rivers, Washington's Tony Wroten, and Indiana's Cody Zeller.

The USBWA has chosen a national freshman of the year since the 1988-89 season when LSU's Chris Jackson was the recipient. Other previous winners of the award include Kevin Durant, Carmelo Anthony, Jason Kidd and Chris Webber. This season marks the

second year the award has been named in Wayman Tisdale's honor.

The late Wayman Tisdale was a three-time USBWA All-American at the University of Oklahoma. Following a stint on the 1984 U.S. Olympic basketball team, he played 12 seasons in the NBA

before retiring in 1997 to focus on a blossoming jazz music career. In March 2007, he was diagnosed with cancer and, following a courageous and difficult battle that included the amputation of his right leg in 2008, he passed away in May 2009.

Student's perseverance earns new career

PIKEVILLE — Sylvia Damron, a graduate from the medical billing and coding program at the Pikeville Campus, has a job she enjoys and lots of opportunity for career advancement as a physician's office assistant at the Pikeville Medical Center. "I've got a career that I can grow with and that's what everyone looks for," said Sylvia. "I was stuck," she said, "I wanted something more. It was time."

Although it was difficult working long hours and staying up late into the night completing homework while taking classes, Sylvia persevered and even earned an award for perfect attendance. "I was so motivated and so determined to do better that I didn't let it bother me. I just kept going," Sylvia said.

Sylvia worked closely with the career center at the campus during her job search. Career Center



Sylvia Damron gained a new career after studying at National College.

Director Kelly Raupach assisted her with her résumé and held mock interviews with her. "That was very, very helpful," said Sylvia. "Not many colleges have that at all."

Sylvia is proud to have earned her diploma at National College and to work for Pikeville Medical Center "When you put your mind to it nothing can stop you," she said.

John got in the game with a wide range of sports, movies and more & saved up to \$750!

Nicole went back to basics and saved \$312!

dish
Packages start at just **\$19.99/mo** for 12 months
Complete Price \$24.99/mo

Join Nicole and John and start saving today!

SIX PACKAGES UNDER \$50

Prices valid for 12 months. Requires 24-Month agreement.

BLOCKBUSTER @HOME
INCLUDED FOR 3 MONTHS
For the Blockbuster @Home, one disc at a time, \$19.99 value.

FREE
30 MOVIE CHANNELS
HBO **cinemax**
SHOWTIME **starz**
For 3 months.

FREE
SAME DAY
INSTALLATION
IN UP TO 6 HOURS
where available
CALL TODAY & GET IT INSTALLED TODAY!

NO ONE CAN COMPARE TO DISH Network!

THE COMPETITION DOESN'T STACK UP

BLOCKBUSTER @HOME included for 3 months. Get over 100,000 movies, shows and games by mail plus thousands of titles streamed to your TV & PC.

The most HD channels
Lowest All-Digital Prices Nationwide
Award-Winning HD DVR
FREE installation in up to 6 rooms

dish

DIRECTV

LARGEST CABLE PROVIDERS

YES	NO	NO
YES	NO	NO
YES	NO	NO
YES	NO	NO

Call Now and save over \$750 this year on TV!

1-888-476-0098

Call 7 days a week 8am - 11pm EST Promo Code: MB0112



Visit us online at
www.floydcountytimes.com

FELLOWSHIP TOURS

2012

TOUR SCHEDULE



CLIP & SAVE		PRICES START AT
Feb. 18	Valentine Special - 1-Day Mystery Tour	\$99.00 P/P
Mar. 12-14	Quilt Auction in Penn Dutch Country "Special"	\$179.00
Mar. 30-Apr. 1	Ohio Amish Country "Special"	\$189.00
Apr. 5-8	Azalea Trail/Historic Charleston/Carolina Opry	\$339.00
Apr. 10-12	Washington, DC/Cherry Blossom/Mount Vernon	\$299.00
Apr. 20-22	Pennsylvania Dutch Country/Hershey/Gettysburg	\$229.00
Apr. 21	Biltmore Mansion	\$80.00 P/P
Apr. 25-29	Branson, MO/JOSEPH/Eureka Springs, AR/Memphis	\$529.00
May 3-6	New York City "Economy"/Penn. Dutch Country	\$449.00
May 5	Smith Mountain Lake Cruise (Lunch Included)	\$129.00 P/P
May 12	"Mayberry RFD" (Lunch Included)	\$85.00 P/P
May 26-Jun. 9	Southwest/Grand Canyon/Hoover Dam/Kings Canyon, San Francisco/Hollywood/Los Angeles/San Diego Zoo	\$1649.00
Jun. 2	Great Smoky Mountains R.R. Excursion/Dillsboro, NC	\$99.00 P/P
Jun. 14-17	Ohio Amish Country/Longaberger Basket	\$349.00
Jun. 15-17	Washington DC/Mount Vernon	\$299.00
Jun. 16-17	Memphis/Graceland/Dinner Cruise	\$199.00
Jun. 16-19	Niagara Falls/Great Lakes/Henry Ford Museum	\$410.00
Jun. 16-20	Niagara Falls/Penn Dutch Country/Hershey/JONAH	\$459.00
Jun. 23-24	Renfro Valley Barn Dance	\$139.00
Jun. 23-Jul. 8	The Great Pacific Northwest	\$1879.00
Jun. 30	Tennessee Aquarium/Hamilton Place Mall	\$70.00 P/P
Jul. 6-8	Loretta Lynn's Ranch/Memphis/Graceland	\$329.00
Jul. 12-15	Niagara Falls/Great Lakes/Henry Ford Museum	\$410.00
Jul. 14	Great Smoky Mountains R.R. Excursion/Dillsboro, NC	\$99.00 P/P
Jul. 18-26	North Central U.S.A. - North Dakota, Montana, Wyoming, Minnesota, Wisconsin	\$1079.00
Jul. 21	"Trail of the Lonesome Pine" Drama/Natural Tunnel	\$59.00 P/P
Jul. 28-Aug. 12	Canadian Rockies/Columbia Ice Fields	\$7099.00
Aug. 4	"Mayberry RFD" (Lunch Included)	\$85.00 P/P
Aug. 11	Great Smoky Mountains R.R. Excursion/Dillsboro, NC	\$99.00 P/P
Aug. 13-16	"JONAH"/Pennsylvania Dutch Co./Hershey/Gettysburg	\$299.00
Aug. 16-22	Eastern Canada/Niagara Falls/Ottawa/Quebec City	\$799.00
Aug. 23-26	New York City "Economy"/Penn. Dutch Country	\$449.00
Aug. 29-Sep. 2	Branson, MO/JOSEPH/Eureka Springs, AR/Memphis	\$529.00
Sep. 4-6	Pennsylvania Dutch Country/Hershey/Gettysburg	\$229.00
Sep. 15-26	Nova Scotia and New England Fall Foliage	\$1349.00
Sep. 22	Shafley Springs Inn/Fresco Paintings/Cheese Factory	\$75.00 P/P
Sep. 27-30	Penn Dutch Co./Hershey/Gettysburg/Washington DC	\$359.00
Oct. 6	South's Largest Flea Market, Anderson, SC	\$65.00 P/P
Oct. 6-12	7-Day New England Fall Foliage	\$819.00
Oct. 13-21	9-Day New England Fall Foliage	\$1079.00
Oct. 22-25	Niagara Falls/Penn. Dutch Co./Hershey Washington, DC/JONAH	\$479.00
Oct. 27-Nov. 7	Southwest/Grand Canyon/California	\$1099.00
Nov. 9-11	Washington, D.C./Mount Vernon Off-Season	\$239.00
Nov. 10-11	Nashville/Opry Mills Mall/Grand Ole Opry	\$189.00
Nov. 17	Christmas at Dine's Stamped/Festival of Lights	\$79.00 P/P
Nov. 17	Hatfield's & McCoy's Dinner Show/Festival of Lights	\$75.00 P/P
Nov. 17-20	Niagara Falls "Festival of Lights"/Ohio Amish Country	\$459.00
Nov. 21-24	New York/Macy's Christmas Parade/Radio City Music Hall/Broadway Play (optional)	\$819.00
Nov. 24	Christmas at Biltmore Mansion	\$80.00 P/P
Nov. 24-25	Nashville Country Christmas/Grand Old Opry	\$189.00
Dec. 1	Christmas at Biltmore Mansion	\$80.00 P/P
Dec. 1-3	Williamsburg Grand Christmas Illumination	\$399.00
Dec. 6-9	New York City "Economy"/Penn. Dutch Country	\$469.00
Dec. 8	The Smoky Mountain Opry/Festival of Lights	\$75.00 P/P
Dec. 13	Christmas at Dine's Stamped/Festival of Lights	\$79.00 P/P
Dec. 30-Jan. 1	Ring in the New Year with Southern Gospel Singing in Pennsylvania Dutch Country	\$220.00

All tours include round trip by modern air conditioned, restroom-equipped motor-coaches. Also, all tours are fully escorted and include motel accommodations as well as admission to the listed attractions and many other extras.

FELLOWSHIP TOURS

Johnson City, Kingsport, Bristol TN

423-349-2300

For an individual brochure on any tour listed

Please Call Toll Free:

1-800-999-3156

www.fellowshiptours.com

Depart from: Johnson City • Kingsport • Bristol, TN & VA, Knoxville • Dandridge, & Bulls Gap, TN • Abingdon, VA • Wytheville, VA • Roanoke, VA, Chilhowie, VA • Asheville, NC



Elementary students take part in academic competition

Jack Latta
Staff Writer

Floyd County students continued to make improvements this year in the recent Jenny Wiley Academic Conference Elementary School Division.

Recent scores on various tests have shown improvement in various subjects. Floyd County Schools Supt. Henry Webb congratulated students on their work.

"As you are aware, we have raised the bar with our academic teams this year and are seeing our students and teams make more and more progress," said Webb. "Congratulations to May Valley Elementary for placing first and thanks to all our teams for a great season."

Final Standings
1. May Valley Elementary

2. Prestonsburg Elementary
3. McDowell Elementary
4. Duff Elementary
5. Betsy Layne Elementary

Quick Recall
1. Osborne Elementary
2. May Valley Elementary

2. McDowell Elementary
2. Wesley Christian

Written Assessment
1. May Valley Elementary
2. Prestonsburg Elementary

Individual Student achievement
Math

1. Brennan Mullins, McDowell Elementary
2. Kaitlyn Johnson, Prestonsburg Elementary

3. Kaylie Edwards, Osborne Elementary
4. Devin Parsley, Duff Elementary

5. Cole DeRossett, May Valley Elementary

1. Brennan Mullins, McDowell Elementary
2. Logan Turner, Duff Elementary
3. Cole DeRossett, May Valley Elementary

4. Andrew Burchett, Prestonsburg Elementary
5. Joshua Arttrip, May Valley Elementary

Social Studies
1. Camron McCormick, May Valley Elementary

2. Preston Crase, May Valley Elementary
3. Andrew Stratton, Betsy Layne Elementary

4. Andrew Burchett, Prestonsburg Elementary
5. Mason Compton, Prestonsburg Elementary

Language Arts
1. Preston Crase, May Valley Elementary

2. Savannah Price, McDowell Elementary
3. Lauren Hamby, May Valley Elementary

4. Gabbie Bates, Prestonsburg Elementary

tonsburg Elementary
4. Meredith Wells, Wesley Christian

5. Andrea Conley, May Valley Elementary

Arts and Humanities
1. Natalie Lester, May Valley Elementary

2. Logan Turner, Duff Elementary

3. Cassidy Clatworthy, McDowell Elementary

4. Amy Adkins, Wesley Christian

5. Caleb Gearheart, Betsy Layne Elementary

English Composition
1. Kara Jensen, May Valley Elementary

2. Andrea Conley, May Valley Elementary

3. Kaylie Edwards, Osborne Elementary

4. Lauren Hamby, May Valley Elementary

5. Kaitlyn Johnson, Prestonsburg Elementary

Grimm pitches Colonels past Wofford

Times Staff Report

SPARTANBURG, S.C. — Junior left-hander Shane Grimm turned in a quality outing on the mound while seniors Richie Rodriguez and A.J. Jamison, junior Austin Grisham and sophomore Sean Hagen all collected three hits apiece as the Eastern Kentucky University baseball team cruised past host Wofford, 10-2, on Sunday afternoon in the decisive game three of this weekend's series at King Field.

With the series win, ECU improves to 6-9 on the season. The loss drops Wofford to 8-8. Grimm (1-3), a Paintsville High School graduate, earned his first win as a Colonel on Sunday,

throwing seven innings and surrendering just one run on four hits while striking out three batters. Senior right-hander Matt Fyfe (Johnson Central HS), and junior right-hander Anthony Bazzani held the Terriers scoreless over the final two innings of the game.

Left-hander Pete Noordsy (1-1) picked up the loss for Wofford, although he did not get much help from his defense. Only one of the four runs Noordsy allowed was earned, as the Terriers committed four errors on the afternoon. Wofford committed 13 errors in the three-game series.

The Colonels collected 13 hits, stole three bases

and drew a season-high eight walks as their offense was clicking on all cylinders. Rodriguez finished the game 3-for-3 with a pair of doubles, three RBI and a run scored, while Jamison was 3-for-6 with two RBI and three runs scored. Grisham was 3-for-5 with a pair of RBI and Hagen, who batted a team-best .429 over ECU's five-game spring break trip, was 3-for-5 with three runs scored.

Stephen Cantrell paced the Wofford offense, going 2-for-3 with a run scored.

Rodriguez got the ECU offense going in the top of the third inning with a two-run double down the left field line that plated Jamison and fresh-

man Demetrius Mooror, who was making his first start in center field since Opening Day. Hagen also scored on an error in that inning to make the score 3-0.

Wofford got a run back in the home half of the third, but ECU added another in the top of the fourth and two more in the top of the seventh as Jamison singled home a run and then scored himself, on a wild pitch.

The Colonels then put the game away with four runs in the top of the ninth.

ECU has this week off before hosting Bowling Green State in a three-game series at Turkey Hughes Field over the weekend.

Freedom Ford raising money for Magoffin school repairs

IVEL — Freedom Ford and Magoffin Community High School are teaming up to help raise up to \$6,000 in support of the school, as part of Ford Motor Company's Drive One 4 UR School program.

Local residents will have the opportunity to raise money for storm repairs at the school by test-driving a Ford vehicle on Saturday, March 17. For every

vehicle who test-drives a new Ford vehicle at this one-day event, Ford Motor Company and Freedom Ford will donate \$20, up to a maximum of \$6,000.

In addition, the dealership is taking donations of toiletry items, clothes, shoes and food and other items for the

local community.

Freedom Ford & Honda will also be donating \$500 for every vehicle purchased between now and the end of the event on March 17, to Salversville Grade School, up to \$10,000.

The event will take place at Freedom Ford's dealership on U.S. 23, at Ivel, from 9 a.m. to 6 p.m.

McConnell pays tribute to storm victims

WASHINGTON, D.C. — U.S. Senate Republican Leader Mitch McConnell released the following statement Monday regarding Kentucky's continued recovery from the tornadoes that hit the state on Friday, March 2, 2012:

"The tornadoes that hit Kentucky were very severe, with at least 11 funnel clouds confirmed to have touched down in the Bluegrass State by the National Weather Service, blowing at wind speeds up to 125 miles per hour.

"We now know that these deadly storms claimed 23 lives in Kentucky, and more than 300 were injured. We've heard stories like that of Stephanie Decker, currently in stable condition at the University Hospital of Louisville, who raced home during the storm just in

time to hurry her 8-year-old son and 5-year-old daughter into the basement of their three-story, brick-and-stone house.

"The storm covered their tiny bodies with her own as the tornado crashed the house down on top of them. Stephanie has lost one leg and the knee and the other above the ankle, but her children survived without a scratch.

"The weekend immediately after the storm I visited the part of Kentucky that was arguably hardest hit by them, the town of West Liberty. The town is home to just 3,400 people—and all 3,400 lives have been thrown into chaos, as virtually the entire population had to be evacuated.

"Churches, homes, schools, and businesses are reduced to rubble. The town courthouse and city hall are both in ruins. Badly injured President Obama once visited the once-thriving, happy little community is now barely there.

"Scenes from West Liberty are repeated across the State in places like Magoffin, Menifee, Kenton, Morgan, Laurel, Lawrence, Martin, Pulaski, Johnson, and Trimble counties, which are among the hardest hit.

"And too many Kentucky families are mourning what was taken from them by the storms that can never be replaced.

"In Lawrence County, Joyce Chaffins, 65, and her granddaughter, 14-year-old Samantha Wood, died when a tornado struck their home. Samantha was a ninth-grader at Lawrence

County High School, where she played in the band and was a member of the National Junior Honor Society.

"The storm has also claimed the lives of James Gregory Brooks, 48, Donald L. Beemon, 78, and Linda Beemon, 73, of Kenton County.

"In Johnson County, in Middle Fork, a tornado ripped the home of Gregory Perry, 20, right off its foundation and carried it over a 25-foot embankment into rushing creek rapids, where, according to the county coroner, the house 'just disintegrated.'

"Gregory was killed, along with Sean Shepherd, a 16-year-old boy from Prestonsburg who had the misfortune of visiting Gregory at the time.

"More lives taken by this destructive force of nature include Sherman DeWayne Allen, 49, Debbie Allen, 49, Wilbur Pitman, 81, Virginia Pitman, 73, and Ethel Pruitt, 64, all of Laurel County.

"In Morgan County, husband and wife Charles and Betty Sue Endicott, both in their early 50s, were caring for Charles's mother, Elizabeth Endicott, 72, after her recovery from a stroke. A tornado struck their trailer home, killing all three of them. Charles's sister, Marita Moore, surveyed the scene of destruction and said this: 'There's not even a memory left down there.'

"More Kentucky families who don't deserve such a painful loss include the families of Beverly Bowman, 47, Anita Smith, 53, and Vershal Brown, 79, all of Menifee County; and Alex

Clayton Dulin, 86, Emma Dean Cecil, 87, and Wilmer Cecil, 90, all of Morgan County.

"In Pulaski County, 74-year-old Helen Placke was found dead in her home. She had sought shelter from the storms inside a closet—but to no avail.

"In Kenton County, in the town of Falmouth, Courtney Stephenson died when her car was suddenly lifted and catapulted across six lanes of traffic on I-75. She was 42 years old.

"It's sobering and humbling to think about the many wondrous technologies and abilities we have in this great country—from the medical advances that can place tiny tools into the smallest human capillaries, to our scientific discoveries that enable us to send cameras to the outermost edges of the solar system and actually take pictures of other planets and send them back to Earth."

"And yet human life is still so fragile when confronted with the powerful forces of the natural world."

"I would be remiss, if I didn't conclude with a note of gratitude—and that is gratitude for the many brave and heroic first responders and other Kentuckians who have rushed to the aid of those hardest hit by these storms."

"Over the last week, my office has been contacted by people throughout the country asking how they can help. We've pointed them to the resources in the Commonwealth where the people on the ground have coordinated incredible assistance to those in need."

Your news ... Your newspaper

Floyd County Times

Community News, Sports Scores

Editorials, Church Events

and Breaking News

YOUR NEWSPAPER

Story idea or news tip?

Call 606-886-8506



★ PAINTSVILLE, KY. ★
★ PRESTONSBURG, KY. ★

SPECIAL DISCOUNTS
ON KITCHEN CABINETS
AND VANITIES.

All sales strictly cash.
Delivery available
at slight additional cost.

Annual Spring Sale F. S. VANHOOSE & CO.

Serving the Area for 102 Years!

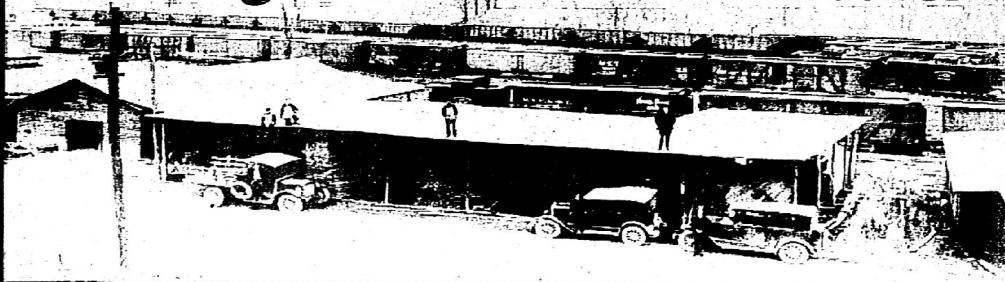

* FRAMING LUMBER *

Description	8'	10'	12'	14'	16'
2x4 *SPF* KD.	2.18	2.88	3.55	3.98	4.55
2x6 *SPF* KD.	3.55	4.44	5.55	6.44	7.55
2x8 *SPF* KD.	4.98	6.44	7.88	8.98	9.98
2x10 *SPF* KD.	6.77	8.44	9.88	11.98	13.55

Premium Spruce

2x4x92 5/8" Studs.....	\$1.89
2x4x104 5/8" Studs.....	\$2.58
2x6x92 5/8" Studs.....	\$3.65
2x6x104 5/8" Studs.....	\$4.09
1x12 Sheathing Per M.....	\$544.00
1x6 Beaded White Pine Lin Ft.	\$4.55

ENGINEERED LUMBER

24' Truss 4/12.....	\$36.77
28' Truss 4/12.....	\$52.88

LVL BEAMS

9 1/4"x24'	82.55
9 1/4"x40'	139.88
11 7/8"x24'	105.55
11 7/8"x28'	124.44
11 7/8"x40'	175.55
16"x28'	177.77
18"x24'	168.88
18"x36'	245.55

PRESSURE TREATED LUMBER

Description	8'	10'	12'	14'	16'
2x4 Treated	2.77	3.66	4.77	5.55	6.55
2x6 Treated	3.55	5.33	6.55	7.33	8.55
2x8 Treated	5.55	6.88	8.44	9.88	10.88
2x10 Treated	7.77	9.44	11.44	12.88	14.88
4x4 Treated	6.44	8.88	10.77	12.44	15.33
6x6 Treated	16.55	19.88	25.55	27.77	31.88
1x6 Treated	2.88		4.77		
5/4x6 Treated	3.33	4.33	5.44		7.55
5/4x6 Premium	4.88		7.77		10.88
2x2x32" .79 4 Step Riser					\$8.44
48" Colonial Post .99 36" Spindle					\$1.44
8" Grooved Handrail .74 Ball Top					\$3.77
4x4x8' Turned Column.....					\$33.88
4 x 8 Treated Lattice.....					\$11.55
4 x 8 White Vinyl Lattice.....					\$20.55

GALVANIZED ROOFING

8'	10'	12'	14'
26"-5V	10.66	13.66	15.66
17.66			

POWER GUN NAILS

#8 per carton 2,500 CT	29.88
#12 per carton 2,000 CT	34.88

PLYWOODS

7/16" O.S.B.....	\$6.77
19/32" Sturdy Floor...O.S.B.....	10.77
23/32" T & G Advantech.....	19.89
1/2" CDX Plywood.....	13.88
5/8" CDX	17.55
3/4" T & G Underlayment	22.89
1/4" Luan Exterior	9.55
3/8" One Side Ext.	17.88

ANDERSEN WINDOWS



Special Pricing
Anderson Distributor List



VINYL WINDOWS

WHITE INSULATED
- 1 1/2" - w/tilt & screen

Window	Rough Opening	Price
2030	24 1/2" x 36 1/2"	98.88
2830	32 1/2" x 36 1/2"	108.88
3030	36 1/2" x 36 1/2"	111.77
2840	32 1/2" x 48 1/2"	118.77
3040	36 1/2" x 48 1/2"	119.88
3052	36 1/2" x 62 1/2"	126.77

EXTERIOR DOORS

INSULATED EXTERIOR UNITS

6 Panel	9 Lite	15 Lite	Oval Zinc
116.88	148.88	188.88	288.88
Colonial Entrance with Sidelights \$447.77			
Oval Zinc Entrance with Sidelights \$855.55			

PATIO DOORS

*Hinge Type (See back & screen)

6/0 Metal Clad - 1 Lite	\$339.88
6/0 Metal Clad - 15 Lite	\$349.88

INTERIOR PREHUNG UNITS WITH CASING

	1/6	2/0	2/4	2/6	2/8	3/0
6 PANEL MOULDED	64.77	67.77	69.77	69.77	71.77	74.77
6 PANEL WPP-CLEAR	124.88	135.88	145.88	145.88	149.88	154.88
LAUAN F.J.	58.77	60.77	63.77	63.77	64.77	67.77
		4/0	5/0	6/0		
Moulded Panel Byfold		69.88	74.88	87.88		
Louvered Byfold		125.77	139.77	154.77		

SIDING

8" Cedar Bevel Siding LIN. FT.	88¢
8" #1 Log Siding LIN. FT.	77¢
Log Corners EACH	12.44
5/8" x 4 x 8 Pine, 4" or 8" O.C....	\$28.88
7" Cement Lap Siding	55¢ LIN. FT.

Vinyl Siding - White - Twin 4	per sq.	63.80
All stock colors	per sq.	64.80
White - D-5 Dutch Lap	per sq.	63.80
All stock colors	per sq.	64.80

INSULATION PRODUCTS



3 1/2" Fiberglass K.B. R-11.....	19 1/2¢
3 1/2" Fiberglass K.B. R-13.....	23 1/2¢
6" Fiberglass K.B. R-19.....	29 1/2¢
10" Fiberglass K.B. R-30.....	46 1/2¢



1/2" R-Max Sheathing. \$11.77

2" Insul Board 4' x 8'	\$33.33
9' x 100' House Wrap	\$55.55
Metal Building Insulation 6x100	\$179.88

ELECTRICAL

12-2 Wire with Ground 250' rolls...	\$79.88
2x3 Plastic Wall Box (code)	24¢
4x4 Plastic Ceiling Box (code)	\$1.09
200 AMP 32 Circuit Breaker Box	
(w/cover)	119.89
200 AMP 40 Circuit Breaker Box	
(w/cover & 12 Breakers.....	158.77
Vent & Fan	\$12.95
Vent & Light	\$34.88
Heat - Vent & Light	\$66.88

GALVANIZED CULVERT

	12"	15"	18"	24"	36"
12' Steel	127.77	152.77	188.88	244.44	
20' Steel	212.88	254.95	315.55	408.88	619.88

PLUMBING

AQUA GLASS

Fiberglass Tub Units	\$339.88
White Commode w/Seat & Seal - (A-Grade)	89.88
50 Gallon Electric Water Heater	284.88
Lavatory Faucet w/Pop Up	35.88
Sink Filler w/Spray	37.88
Tub & Shower Filler	54.88
1/2 HP Myers Submersible Pump	292.88
3/4 HP Myers Submersible Pump	358.88
1 HP Myers Submersible Pump	378.88

PAINTSVILLE

1-606-789-4075

1-800-722-4075

DAILY 7:30 A.M. - 5 P.M.
SATURDAY 7:30 A.M. - 1 P.M.

SALE STARTS

MARCH 10, 2012

SALE ENDS

MARCH 24, 2012

* DUE TO MARKET CONDITIONS,

WE DO RESERVE THE RIGHT
TO LIMIT QUANTITIES.

* No Sales To Dealers, Please! *

PRESTONSBURG

1-606-886-2746

1-800-538-2746

DAILY 7:45 A.M. - 4:30 P.M.
SATURDAY 7:45 A.M. - 1 P.M.

F. S. VANHOOSE & CO.



Saint Joseph Martin
KentuckyOne Health™

Committed to Creating Healthier Communities



Saint Joseph and Flaget facilities' commitment to community outreach continues to be at the center of everything we do. We provided more than \$48 million in charity care from July 1, 2010, through June 30, 2011. Combined with our various programs and services, we provided more than \$81 million in outreach care for which limited or no reimbursement was received.

This represents who we are as a faith-based organization dedicated to creating healthier communities and advocating on behalf of those who are disadvantaged and underserved.

As a Catholic organization, we believe that everyone, regardless of their ability to pay, has the right to health care – it is a basic human right, not a privilege. This was our founding Sisters' mission more than a century ago and one that we are still called to live out today.

Thank you for your support as we continue our journey to transform health care across the state of Kentucky.

Saint Joseph and Flaget Facilities Community Benefit - FY 2011

Community Health Program/Service	FY 2011
Cost of charity care provided	\$48,735,033
Unpaid cost of Medicaid	\$22,614,037
Unpaid cost of indigent programs	\$8,131,003
Non-billed services for the poor	\$78,993
Cash and in-kind donations for the poor	\$117,115
Other benefits provided to the poor	\$205,160
Total cost of community benefit provided to the poor	\$70,602,441
Costs to provide care to broader community	FY 2011
Non-billed services for the community	\$615,809
Education and research provided to community	\$931,127
Other benefits provided to the community	\$355,555
Total cost of community benefit provided to the community	\$1,902,491
Total cost of community benefit	\$81,054,932
Community benefit % operating expenses before restructuring	9.6%

Read the latest Saint Joseph Community Benefit Report at sjhes.org/cbr



Community Outreach For People Who Are Poor

Christmas Basket Program – Saint Joseph Martin (SJM) assisted the efforts of employees who donated 1,374 items for 63 families through the Christmas Basket Program. The program is organized through Social Services in collaboration with Martin First Baptist Church.

Other community outreach programs for the poor include social services programs and patient financial counselors.

Community Outreach For The Broader Community

School Programs – SJM's Community Health Outreach Department collaborates with all area schools and many community organizations to provide prevention programs. The following programs were presented to more than 4,000 students: Let's Talk About Drugs (primary), Tobacco Prevention (primary, middle and high schools), Nutrition (primary and middle schools), Heart Health/CPR Information (middle and high schools), CPR Heartsaver (middle and high schools), Student Self-Breast Exam (high schools).

SJM continues to be dedicated to Respect – an abstinence-based program for 5th and 7th grade females, which began in 1994. Real Care dolls are an integral part of the program. The program was conducted in six of the seven middle schools in Floyd County serving more than 100 students. A parent said the following about the program: "I think it should be that they have to do this, not optional. It was a great training experience for (my daughter). Thank you for having this program."

Other community outreach programs for the broader community include: the Dental/Oral Health Care Initiative, Floyd County Communities Against Drug Addiction (CADA), Relay for Life, Senior Health Fest, and community donations.

Collaborative Efforts To Improve Community Health

Floyd County Diabetes Coalition – SJM is a member of the Floyd County Diabetes Coalition, a branch of the Tri-County Coalition (Floyd, Johnson and Magoffin) that was created approximately three years ago by the Friedell Committee. The goal is to investigate and address the needs of people with diabetes in the three previously mentioned counties. According to *The Courier Journal* (2005), in the eastern Kentucky area, adult diabetes rises as much as 74 percent above the national average.

Other collaborative efforts to improve community health include: Healthy Floyd County, Floyd/Pike Agency for Substance Abuse Policy (ASAP), health professions education, and community building activities.

"We are honored to continue the legacy of care established by our Foundresses in 1917. Our mission is to build a healthier community and this guides us in the programs we provide and strengthens our partnerships with other organizations. It is our goal to serve all people with compassion and respect."

KAREN WILSON

VICEDENOMINATIONAL PRESIDENT

Flaget Memorial Hospital, Saint Joseph Berea, Saint Joseph East, Saint Joseph Jessamine, Saint Joseph Hospital, Saint Joseph London, Saint Joseph Martin, Saint Joseph Mount Sterling, The Women's Hospital at Saint Joseph East

WEDNESDAY,
MARCH 14, 2012

floydcountytimes.com
www.floydcountytimes.com

FLOYD COUNTY

SPORTS

INSIDE

Eagles travel
south for
spring break
B2



Bobcats win Jenkins Wood Bat Classic

STEVE LeMASTER
SPORTS EDITOR

JENKINS - The Betsy Layne High School baseball team opened the 2012 season 3-0 over the weekend, capturing the Jenkins Wood Bat Classic title. Betsy Layne defeated Phelps 14-2 and Harlan 8-3 in games played Saturday. The Bobcats defeated Jenkins 10-5 on Sunday.

Betsy Layne is under the guidance of head coach Bryan Dixon. More on Betsy Layne's early-season tournament triumph follows.

Betsy Layne 14, Phelps 2 (5 innings); Betsy Layne scored over a dozen runs on only seven hits, defeating Phelps 14-2 Saturday.

Jonathon Brock delivered a game-high five RBI for the Bobcats. Brock was the only Betsy

Layne player with two hits. Leadoff hitter Dustin Rogers had three RBI for the Bobcats.

Peyton Case and Landon Hale had two RBI apiece in Betsy Layne's win.

Cleanup hitter Andrew Roberts, reigning Floyd County Conference Boys' Basketball Player of the Year, scored a game-high three runs for the Bobcats.

Starting pitcher Kannon Newsome claimed the win for the Bobcats. Newsome pitched a complete game in the season-opener.

Phelps plated its two runs on four hits.

Betsy Layne 8, Harlan 3; Betsy Layne banged out 14 hits en route to an 8-3 win over Harlan Saturday.

Houston Hall, hitting out of the second spot in the batting order,

paced Betsy Layne with a game-high four hits.

Hall, Dustin Rogers, Michael Henson, Andrew Roberts and Jonathon Brock each had an RBI for the Bobcats.

Brock was the winning pitcher for the Betsy Layne club.

Betsy Layne 10, Jenkins 5: Visiting Betsy Layne scored three runs in two separate innings and made the most of 13 hits to beat Jenkins 10-5 on Sunday.

Houston Hall had a game-hit four hits for the Bobcats. Michael Henson added three hits and three RBI in Betsy Layne's victory over the Cavaliers.

Adam Roberts registered two RBI for the Bobcats.

Peyton Case earned the win on the mound for the Bobcats. Case registered nine strikeouts.

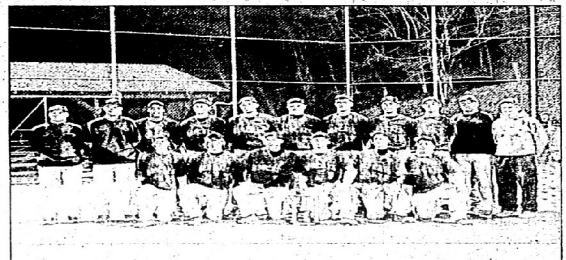

Betsy Layne was dominant over the weekend, winning the Jenkins Wood Bat Classic championship.

Hall honored as 15th Region Player of the Year

STEVE LeMASTER
SPORTS EDITOR

BOWLING GREEN

During halftime ceremonies at the girls' state basketball tournament on Friday, the Kentucky Association of Basketball Coaches presented awards to its region players and coaches of the year, including South Floyd senior Kiana Hall. One of the state's top hoopsters, Hall was named the 15th Region Player of the Year. Shelby Valley's Rodney Rowe and Magoffin County's Steve "Pup" Miller shared the 15th Region Coach of the Year honor.

Longtime Johnson Central head coach Phillip Wireman was inducted into the KABC Court of Honor.

A list of the award-winners from throughout the state follows.

Players of the year, by region: 1. Haley Armstrong (Murray); 2. Christy Soldo (Hickmanville); 3. Kelsea Wilson (Grayson Co.); 4. Caylan Bybee (Monroe Co.); 5. Micah Jones (Green Co.); 6. Christine Roush (Mercy); 7. April Wilson (Manual); 8. Rianna Gayheart (Owen Co.); 9. Jasmine Whitfield (South Oldham); 10. Sydney Moss (Boone Co.) and Jenna Crittendon (Ryle); 11. Sara Stricklen (Bracken Co.); 12. Ashley Mayes (Franklin Co.) and Kristen Jacob (Lexington Christian); 13. Megan Pittman (Casey Co.); 14. Miranda Davenport (Harlan Co.); 15. Peyton Wright (Owsley Co.); 16. Kayla Day (Fairview).

Coaches of the year, by region: 1. Roderick Thomas (Tilghman); 2. Taylor Sparks (University Heights); 3. Mike Harper (Muhlenberg Co.); 4. Steve Phillips (Todd Co. Central); 5. Tim Mudd (Elizabethtown); 6. Mark Evans (Mercy); 7. Stacy Pendleton (Manual); 8. Frank Wright (South Oldham); 9. Ron Dawn (Newport Central Catholic); 10. Scott Collins (Pendleton Co.); 11. Sarah Van Horn (Dunklin); 12. Brian Miller (Pulaski Co.); 13. James Burchell (Clay Co.) and Darren Mills (Knox Central); 14. Jeff Honeycutt (Knox Central); 15. Rodney Rowe (Shelby Valley) and Steve Miller (Magoffin Co.); 16. Bill Bradley (Ashland Blazer).

See HALL | B5



Prestonsburg finished first in the Region 11 NASP Archery Tournament held at Letcher County Central on Saturday.

PHS archery team wins regional championship

STEVE LeMASTER
SPORTS EDITOR

WHITESBURG - The highly-successful Prestonsburg High School archery program captured another regional championship on Saturday, prevailing in the 2012 Region 11 National Archery in the Schools Program (NASP) Tournament at Letcher County Central High School.

PHS archer McKinley Minix finished first in the High School Male division. His teammate, Colton

Shepherd, finished runner-up.

Prestonsburg's Alli Hopkins claimed first-place in the High School Female division, one spot ahead of teammate Alexis Younce.

Veteran head coach Sherman Holliday guides the Prestonsburg High School archery program.

Overall winners were Stumbo's Kelsey Smith and Allen's Zachary Patrick.

Other first-place finishers from Floyd County were Zachary Patrick (Allen, Middle School, Male); Kelsey Smith (Stumbo, Middle

School Female); Milton Mahan and (Stumbo, Sixth Grade Male).

A breakdown of the results from the 2012 NASP Region 11 Tournament follows.

High School Team: 1. Prestonsburg; 2. Letcher County Central; 3. Lee County.

Middle School Team: 1. Martha Jane Potter; 2. Stumbo; 3. Adams.

Elementary Team: 1. Martha Jane Potter; 2. Stumbo; 3. Adams.

Overall Female: Kelsey Smith (Stumbo).

See PHS | B2

Rebels beat Millard for second win

STEVE LeMASTER
SPORTS EDITOR

MILLARD - The Allen Central Middle School volleyball team, fresh off a conference win over Piatt, traveled to Millard to face the host Mustangs Monday night. Allen Central was successful on the road, defeating Millard for its second win.

Katie Kendrick paced the Rebels with six kills on .667 hitting. Kendrick also recorded five aces. Kelsie Jackson also had five aces and dealt out two assists for the Rebels.

Jannah Halbert scored three aces and dished up two assists in Allen Cen-

tral's win.

Breanna Thompson landed three aces for the Rebels. Chelsea Austin set up two kills, pounded in one kill and delivered an ace for the Rebels.

Sarah Grindrod also had an ace and Hayley Pinson landed a kill for the ACMS volleyball team.

Defensively, Kendrick had three digs and 11 returns for Allen Central Middle squad. Austin dug up one and had eight returns for the surging Rebels.

Haley Smith had seven returns and Breanna Thompson returned nine in the visiting

See REBELS | B3



Jamerson signs with UPIKE

Prestonsburg High School senior Joseph Jamerson made his college choice official on Thursday afternoon, signing to play football for nearby University of Pikeville. Jamerson was joined at the signing by his parents Tracie Jamerson and Dewey Jamerson (seated). Coaches attending the signing were John DeRossett (PHS head coach), Dudley Hilton (UPIKE head coach), Justin Lamb (UPIKE assistant coach) and Jim Tom Allen (PHS assistant coach).

Hodge signs with UPIKE

Times Staff Report

EASTERN - A member of the 2011 15th Region champion has signed a scholarship agreement with the University of Pikeville.

Amanda Hodge of Allen Central High School has signed to continue her education and play volleyball at UPIKE beginning this fall.

Hodge helped the Lady Rebels to a 30-11 record en route to an Elite Eight berth in last year's state tournament, which was the second tournament in her four-year career at Allen Central. In addition, Hodge helped her team to three 15th Region All "A" Classic championships where, in 2011, they reached the semifinals of the event with four wins in the state tournament.

A two-time all-conference and all-district selection, Hodge helped her team to four straight district titles. She was named blocker of the year in 2009 and blocker and hitter of the year in 2008.

She is a member of the Beta Club, History Club, STLP, RADD, Senior Leadership Program, Work Program and Unite at Allen Central.

When she enrolls at Pikeville, Hodge will join her sister Brittany, who will be a senior next season.

See UPIKE | B2

PREMIER POND SPA

HotSpring
FREE Delivery and Setup!
Portable Spas

Winter Clearance
The World's #1 Selling Brand of Hot Tubs
Feel Better. Sleep Better. Feel younger.
606-432-7127

PHS

From Page B2

Overall Male: Zachary Patrick (Allen).
 Fourth Grade Female: 1. Emily Bentley (Mary Jane Potter); 2. Emileigh Boggs (Mary Jane Potter); 3. Kaylee Hash (Fleming-Neon); 4. Isabella Hampton (Martha Jane Potter); 5. Abbey Estep (Wesley Christian).
 Fourth Grade Male: 1. Jeb Keel (Martha Jane Potter); 2. Brance Spradlin (Stumbo); 3. Caleb Ashley (Harlan County Christian); 4. Dawson Fleming (Fleming-Neon); 5. Dalton Hall (Stumbo).
 Fifth Grade Female: 1. Bella Back (Martha Jane Potter); 2. Taylor Herrell (Martha Jane Potter); 3. Emily Craft (Martha Jane

Potter); 4. Lindsey Nelson (Wesley Christian); 5. Alyssa Brandenburg (Beat-tville).
 Fifth Grade Male: 1. Kanaan Johnson (Fleming-Neon); 2. Wesley Depoy (Allen); 3. Jordan Slone (Stumbo); 4. Harrison Ward (Wesley Christian); 5. Cameron Richardson (Fleming-Neon).
 Sixth Grade Female: 1. Makaya Witt (Fleming-Neon); 2. Brook Hamilton (Stumbo); 3. Olivia Foley (Allen); 4. Emily Roberts (Allen); 5. Danika Riddle (Leatherwood).
 Sixth Grade Male: 1. Milton Mahan (Stumbo); 2. Dakota Hughes (Adams); 3. Blake Cook (Martha Jane Potter); 4. Ian Collins (Stumbo); 5. Seth Hammonds (Adams).

Middle School Female: 1. Kelsey Smith (Stumbo); 2. Amanda McKinney (Stumbo); 3. Hannah Depoy (Prestonsburg); 4. Deanna Kidd (Stumbo); 5. Victoria Bates (Martha Jane Potter).
 Middle School Male: 1. Zachary Patrick (Allen); 2. Camron Price (Prestonsburg); 3. David Stratton (Wesley Christian); 4. Calvin Gross (Green Hills); 5. Brody Chaffins (Prestonsburg).
 High School Female: 1. Ali Hopkins (Prestonsburg); 2. Alexis Younce (Prestonsburg); 3. Haley Mahone (Letcher County Central); 4. Ashley Kidd (Lee County); 5. Morgan Dixon (Letcher County Central).
 High School Male: 1.

KNAMENI
sp.org

Prestonsburg archer McKinley Minix finished first in the High School Male division of the Region 11 tournament.

McKinley Minix (Prestonsburg); 2. Colton Shepherd (Prestons-

burg); 3. Tyler Charles (Lee County); 4. Austin Eversole (Letcher County

Central); 5. Makenzie Fox (Letcher County Central).

Upike

From Page B1



Allen Central High School senior Amanda Hodge signed with the University of Pikeville volleyball program, joining her older sister Brittany.

Bears split doubleheader with Taylor

Times Staff Report

PIKEVILLE - The University of Pikeville softball team improved to 5-3 overall with a split of a doubleheader with Taylor University on Friday night.
 The Bears dropped the first game 12-7 before winning the nightcap, 9-6.
 The split dropped Taylor to 8-2 overall.
 Pikeville will open league play on Saturday when it visits the University of Rio Grande for a twinbill.
 Taylor 12, UPIKE 7: The Bears overcame a four-run first to take a three-run lead but gave Taylor a six-run sixth and two more in the

seventh for the win.
 Junior Hannah Vinson had two hits, drove in three and scored a run for the Bears. Kayla Morgan had three hits and a walk in four plate appearances, and freshman Shamy Williams had a pair of singles, runs and RBIs from the leadoff spot.
 Sophomore Kayla Cantrell singled, scored and had a pair of sacrifice bunts in the loss.
 UPIKE 9, Taylor 6: Taylor posted another four-run first but saw Pikeville rally for five in the bottom of the frame and take a lead it would never relinquish.
 The Bears won the game

with only six hits thanks to working three Trojan pitchers for nine walks. Vinson had another two-hit, three-RBI game with a double and a walk. The other four hits were singles by Cantrell, senior Mallory George, sophomore Emily Castle and senior Chanae Bledsoe. Both Cantrell and Williams scored two runs in the win.
 Junior Emily Pointer pitched into the seventh to earn her record at 1-1 on the season. She struck out four and allowed all six runs, only three of which were earned. Sophomore Caitlin Conkey earned her first save of the season.

Fondelius named MSC Men's Tennis Player of the Week

Times Staff Report

PIKEVILLE - University of Pikeville's Marcos Fondelius is the Mid-South Conference Men's Tennis Player of the Week, conference officials announced on Monday.
 The weekly award is Fondelius' first of the season and the first of his career.
 Fondelius finished the week with a 2-1 singles record and a 3-0 doubles record as the Bears participated in the Auburn University Montgomery (Ala.) Invitational over the weekend.

The Magaluf, Spain, freshman teamed with Sven Rodenbusch to win 9-8 (5) over No. 9 Xavier (La.) University's No. 2 doubles team of Viktor Svoboda and Corey Huggins. Fondelius dropped his only match of the week at No. 5 singles with a 1-6, 6-1, 7-5 setback to Xavier's Amir Rahbar.
 Against No. 10 Shorter (Ga.) University, Fondelius and Rodenbusch swept Cody Carr and Colt Kelleigh 8-0 in doubles action. Fondelius dominated his singles match as well with a 6-0, 6-3 win over Grayson Jones.

Fondelius closed out his weekend with two more wins in Pikeville's win over No. 21 Tennessee Wesleyan College.
 He started with partner Rodenbusch to beat David Escobosa and Rodney Pineros 8-5 and completed the match with a 6-4, 6-0 win over Pineros at No. 5 singles.
 The Bears finished the weekend with a 1-2 team record. They lost to Xavier 7-2 and Shorter 5-4 and beat Tennessee Wesleyan 6-3.
 Pikeville is 2-4 overall this season and 1-1 in the MSC.
 The next men's tennis player of the week award is scheduled to be announced on Monday, March 19.

Times Staff Report

PIKEVILLE - A member of the last two regional champion golf teams will advance his career at the University of Pikeville.
 Will Boyd helped Pikeville High School to the regional championship each of the last two seasons and has now signed a scholarship agreement to play golf and continue his education at UPIKE.
 Boyd was the individual runner-up in the 2011 All "A" Classic tournament and the

Boyd signs to golf for UPIKE

Times Staff Report

PIPPA PASSES - The Alice Lloyd College baseball team traveled to Florida during Spring Break to face Clearwater Christian College in three contests. More on each game follows.
 CCC 19, ALC 6: The Eagles opened up play against a hard-hitting Clearwater club on Friday and fell in a slugfest. The contest was tied after four innings and remained tight until CCC exploded for eight runs in the bottom half of the eighth inning. Clearwater pounded out 19 hits while the Eagles rapped 15 of their own.
 Defensively, ALC committed four errors. The host team played error-free in the field.
 Six different ALC players turned in a multi-hit game. Jeff Cyrus paced ALC with three hits. Kevin Smith, Shane Pack, Brandon Arnold, Devon Pelfrey and Trey King each added two hits for the Eagles. Both Cyrus and Smith smacked long homers.
 Pitcher Cory Brewer allowed eight hits and gave up five earned runs and suffered the loss.
 March 10 - CCC 3, ALC 1: Alice Lloyd's bats cooled off



ALC pitcher Corey Brewer suffered a loss against Clearwater Christian College.

considerably after a night in the Florida air. Cody Hyden had the lone hit for the visiting team as CCC prevailed 3-1 over the Eagles on Saturday in the opening game of a doubleheader. Pitcher Neil Dillion tossed a solid game, holding CCC at bay until the bottom half of the sixth inning. The host team scored all of its runs in a last at-bat. Homestanding Clearwater Christian manufactured three runs on seven hits.

CCC 8, ALC 5: ALC battled hard before once again falling in the closing innings. CCC claimed the victory, winning 8-5.
 The Eagles were out-hit 11-8 and committed five costly errors.
 Will Leonard led ALC with two hits. Shane Pack delivered two RBIs for the Eagles.
 ALC pitcher Trevor Corns allowed five earned runs, picking up the loss on the mound.

Hall, Host headed into College Basketball Hall of Fame

Times Staff Report

KANSAS CITY - Former University of Kentucky men's basketball coach Joe B. Hall, along with UK graduate and lifetime contributor Jim Host have been selected as members of the National Collegiate Basketball Hall of Fame induction class of 2012.
 As a Kentucky assistant coach in 1972, Hall had the unenviable task of succeeding Adolph Rupp. Unfazed by the task, Hall guided the Wildcats to 13 seasons, winning 75 percent of 397 games. Within three years, he reached the NCAA championship game and, in 1978, he earned National Coach of the Year honors while coaching Kentucky to its fifth national title with a 30-2 record. His Wildcat teams won eight SEC championships and earned a Final Four berth for the third time in 1984. He was named SEC Coach of the Year four times.
 Host a former letter winner for the

Kentucky baseball team is the founder and principal of Host Communications. He played baseball for the Wildcats from 1957-59. Host realized the potential growth of men's basketball and partnered the NCAA with major corporations like Gillette, Valvoline and Pizza Hut. Host, who also had a background in broadcasting, went on to create a model for multimedia rights, bundling everything from coaches' radio and TV shows, promotional appearances, endorsements and publishing into a single package for some of the nation's top programs. He has been recognized as one of college athletics' most influential people.
 The Class of 2012 will be inducted into the National Collegiate Basketball Hall of Fame Sunday, November 18, 2012, at the Midland Theatre in Kansas City as part of a three-day celebration of college basketball. The hall of fame is located in the College Basketball Experience, a world-class

entertainment facility that provides a multi-faceted interactive experience for fans of the game. On November 19-20, Kansas, Saint Louis, Texas A&M and Washington State will compete at Sprint Center in the CBE Classic.
 Hall and Host will be joined by Patrick Ewing, Joe Dean, Phil Ford, Clyde Lovellette, Earl Monroe, Willis Reed, Dave Robbins and Kenny Sailors as additional members of the 10-person 2012 class.
 Each year, a Blue Ribbon committee, composed of long-time coaches, administrators, former players, broadcasters and basketball writers selects a class of inductees including players, coaches and contributors. The Founding Class of the National Collegiate Basketball Hall of Fame includes all individuals who have been previously inducted for men's college basketball into the Naismith Memorial Basketball Hall of Fame.

Smoking is not only
killing us,
it's bankrupting us.

- Smoking costs Kentucky \$1.7 billion annually in health expenditures.
- Lost productivity due to smoking costs Kentucky employers \$2.6 billion per year.

Support a statewide smoke-free law
for indoor public places.

Good for health
Good for taxpayers
Good for bottom lines
Good for Kentucky

Call your legislator
1-800-372-7181

Kentucky Chamber
Uniting Business. Advancing Kentucky.

Visit us online at
www.floydcountytimes.com

Kentucky to make 52nd appearance in NCAA Tournament

Times Staff Report

LEXINGTON — The University of Kentucky has received the NCAA Tournament's No. 1 overall seed and will serve as the top seed in the South Region. UK will play the winner of the first-round game of Mississippi Valley State (21-12) and Western Kentucky (15-18) on Thursday, March 15 in Louisville, with a 6:50 p.m. ET tip. The game will air live on TBS with Verne Lundquist and Bill Raftery on the call.

The No. 1 seed is the 11th in school history for the Wildcats, who will play their second and third round games in Louisville.

This is just the third time in school history UK will play in the Derby City during the NCAA Tournament. In its last appearance in Louisville, Kentucky defeated Morehead State before losing to Ohio State during the 1961 tournament.

Kentucky has played in its home state on seven previous occasions. UK was last in the Bluegrass State during the 1984 tournament when the Wildcats appeared on their home floor, defeating Louisville and Illinois.

Western Kentucky won the Sun Belt Conference Tournament Championship this year, claiming an automatic bid into the

NCAA Championship. UK is 3-2 all-time versus Western Kentucky with the last meeting coming in 2001 when WKU defeated the Wildcats 64-52.

Kentucky and the Hilltoppers have met twice before in the NCAA Tournament with the squads splitting the two meetings. WKU captured a win over the Wildcats during the 1971 tournament, with UK prevailing 71-64 in 1986.

The Mississippi Valley State Delta Devils, coached by former UK letter winner Sean Woods, won the 2012 SWAC Tournament Championship, claiming an automatic bid into the 2012 NCAA

Championship. The Wildcats are 3-0 all-time vs. the Delta Devils including an 85-60 win a season ago. A matchup with the Delta Devils during the post-season would be a program first.

If UK prevails over Mississippi Valley State or Western Kentucky, it will face the winner of eighth-seeded Iowa State (22-10) and ninth-seeded UConn (20-13) on Saturday, March 17.

Kentucky is 1-0 during the NCAA Tournament against the Cyclones with the lone victory coming during the 1992 season. UK owns an all-time mark of 2-0 against Iowa State. In addition to the 1992

Tournament game, Kentucky earned a home victory in 1965.

UK has faced the Huskies twice before, dropping both matchups including last season's 65-55 loss in the Final Four. Connecticut owns an all-time record of 4-1 against Kentucky. UK's lone victory came during the 2009 season.

Also joining Kentucky in Louisville will be four teams from the West Region including Murray State, Colorado State, Marquette and the winner of the BYU/Iowa play-in.

Should the Wildcats advance past the second and third rounds, they will play in Atlanta, in the

South Regional Semifinals on March 22-23. If UK continues to win, it will play in the South Regional Finals on March 24-25 with a victory moving the Wildcats to the National Semifinals on March 31. The National Championship game is scheduled for April 2 in New Orleans.

Tickets for the first and second round games in Louisville are sold out with the exception of All-Session packages. However, tickets for Regional Semifinal and Regional Final in Atlanta are available online at ticketmaster.com or available through the host site.

MSU men's basketball team assists area tornado victims

Times Staff Report

MOREHEAD — The Morehead State University men's basketball team handed out 394 assists this past winter, but its most notable assist was the work it did to help Kentucky's tornado victims last week. The Eagles travelled to WKYT-TV in Lexington

to take phone calls for the "Kentucky Cares" campaign, which supports efforts by the American Red Cross.

According to Kentucky.com, the "Kentucky Cares" campaign has already raised more than \$400,000 for those in need throughout Eastern Kentucky. Morehead State has also

put together its own plan, called "MSU Cares," and the university strongly encourages Eagle fans to assist in any way they can (financial contributions, volunteering time, etc.).

"The events of March 2 were certainly tragic, and we want to do anything we can to assist those people in need," Morehead State

Head Coach Donnie Tyndall said. "Over 1,500 MSU students have been impacted directly by this terrible event. It's our hope that we can help a life get a little bit better and help a community grow a little bit more."

United States President Barack Obama issued a major disaster declaration for Kentucky last week,

triggering the release of federal funds to help people recover from the awful storms. The action made federal funding available to businesses and residents in Johnson, Kenton, Laurel, Lawrence, Menifee, Morgan and Pendleton counties.

To have Coach (Donnie) Tyndall and the (MSU

men's basketball) team give of their time, and come to Lexington to answer phones for the Kentucky Cares campaign, is truly remarkable," WKYT-TV News Anchor and MSU Alumnus Amber Philpott said. "It's been amazing to see what the university has been able to do in a short amount of time."

TOP-TWO FEMALE ARCHERS:

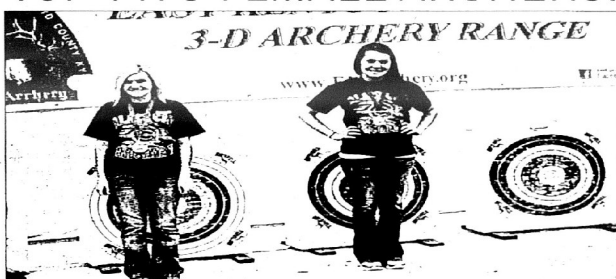

Prestonsburg High School's Alexis Younce finished runner-up and Ali Hopkins claimed first-place in the Female Division of the Region II NASP Tournament at Letcher County Central High School.

REGION RUNNER-UP:



Prestonsburg High School's Colten Shepherd finished runner-up in the High School Male division of the Region II NASP Tournament.

Rebels

From Page B1
team's victory.

Allen Central was hosting South Floyd Tuesday night. The Allen Central

South Floyd match ended too late to make this edition.

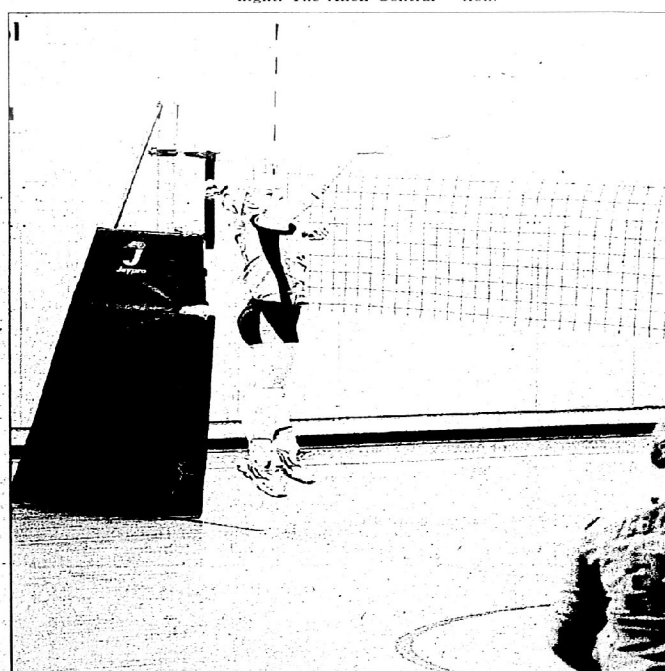

The Allen Central Middle School volleyball team improved to 2-0 Monday night.

Medicare Part B deadline approaching

Michael W. Grochowski
Social Security Regional Commissioner in Atlanta

If you didn't sign up for Medicare Part B medical insurance when you first became eligible for Medicare, you now have an opportunity to apply — but time is running out. The deadline for applying during the general enrollment period is March 31. If you miss the deadline, you may have to wait until 2013 to apply.

Medicare Part B covers some medical expenses not covered by Medicare Part A (hospital insurance), such as doctors' fees, outpatient hospital visits, and other medical supplies and services.

When you first become eligible for hospital insurance (Part A), you have a seven-month period in which to sign up for medical insurance (Part B). After that, you may have to pay a higher premium — unless you were covered through an employer's group health plan or a group health plan based on a spouse's employment. You are given another opportunity to enroll in Part

B during the general enrollment period, from January 1 to March 31 of each year. But each 12-month period that you are eligible for Medicare Part B and do not sign up, the amount of your monthly premium increases by 10 percent.

There are special situations in which you can apply for Medicare Part B outside the general enrollment period. For example, you should contact Social Security about applying for Medicare if:

- you are a disabled widow or widower between age 50 and age 65, but have not applied for disability benefits because you are already getting another kind of Social Security benefit;
- you worked long enough in a government job where Medicare taxes were paid and you meet the requirements of the Social Security disability program and became disabled before age 65;
- you, your spouse, or your dependent child has permanent kidney failure;
- you had Medicare medical insurance (Part B) in the past but dropped the

coverage; or
you turned down Medicare medical insurance (Part B) when you became entitled to hospital insurance (Part A).

You can learn more about Medicare by reading our electronic booklet, Medicare at www.socialsecurity.gov/pubs/10043.html. Or visit the Medicare website at www.medicare.gov. You may also call Medicare at 1-800-MEDICARE (1-800-633-4227; TTY 1-877-486-2048).

Social Security News

AARP TAX-AIDE
Tax-Aide® People Helping People



AARP TAX-AIDE VOLUNTEERS
will begin working EVERY TUESDAY BEGINNING FEB. 7

9 a.m. - 3 p.m.

at the
FLOYD COUNTY LIBRARY
IN
PRESTONSBURG

Bring your 2010 income tax form and all current tax information for 2011

A Free Service for
Senior Citizens and
low-income taxpayers.

Visit us online at
www.floydcountytimes.com

Replacement Windows

Any Size - \$189 Installed

White Vinyl Double Hung Insulated

Max Size 4 ft. x 6 ft. Call for details

Window World "Guaranteed Lowest Pricing!" Local Owner, J.J. Hart

FREE In-Home Estimate
606-258-1774 • 1-800-353-4313
142 American Greeting Rd., Corbin • WindowWorldInc.com

TOPS helps members build nutritious meals

MILWAUKEE, Wis. — Spring is on its way, and many people are focusing on weight loss. March is National Nutrition Month, an opportunity for individuals to focus on nutrition, receive information, and make wise food choices. TOPS Club, Inc. (Take Off Pounds Sensibly), the nonprofit weight-loss support organization, offers tips to assemble healthy meals and think about nutrition year-round.

This year's National Nutrition Month theme is "Get Your Plate in Shape," a philosophy that TOPS has continually advocated. Successful weight loss stems from lasting lifestyle changes. MyPlate, a plan introduced by the United States Department of Agriculture (USDA), reminds consumers that it's important to fill half of their plate with fruits and vegetables. The remainder of the plate should include lean protein and grains. How should you fill your plate? Here are

some tips for balanced meals from ChooseMyPlate.gov:

- **Vegetables** — Vegetables should have a large presence on the plate because they provide vitamins and minerals. There are many options to make sure you get in enough servings each day — fresh or frozen vegetables, vegetable soup, and canned vegetables labeled "low sodium" or "no salt added," such as tomatoes, garbanzo beans, or mushrooms. When dining out, consider swapping a side of French fries with vegetables or salad.
- **Fruits** — Fruits offer essential nutrients, including potassium, fiber, vitamin C, and folate. To incorporate more fruits into your diet, keep a bowl of fruit on the counter, purchase dried or frozen fruits, top your cereal with bananas, peaches, or strawberries, or toss some with a salad.
- **Whole-grain** — Choose whole grains rather than refined grains. Barley, quinoa,

plaf, brown rice, whole-wheat pasta, and bulgur are great options. When choosing products, select options that include whole-grain listed first on the ingredient list. Don't let foods labeled "multi-grain" or "100% wheat" fool you. Many of these products don't contain any whole grains.

- **Fat-free or low-fat dairy** — Pair your nutritious meals with skim or one percent milk. These options offer calcium, vitamin D, potassium, and more. Include more low-fat dairy by substituting ingredients — plain yogurt instead of sour cream, fat-free milk instead of cream, and ricotta cheese instead of cream cheese. Also, be careful with sweet dairy options, such as flavored milks, frozen yogurt, and pudding, because these items contain added sugar.
- **Protein** — Variety is the key to incorporating protein into your diet. Choose proteins — such as lean beef and pork, chicken, turkey, nuts, eggs,

beans, peas, and soy products. Prepare a seafood meal twice a week. Limit your intake of sodium and processed foods, including hot dogs, ham, and sausage.

- **Shop smart** — Be seasonal. Produce can be expensive, so buy items that are in season or on sale to help save money and get the best flavor.
- **Stick to the list** — Plan your meals in advance and make a list of groceries. Stick to the list and don't shop on an empty stomach, so you aren't tempted to purchase extra foods.
- **Buy larger amounts of staple items** — Divide the food into smaller portions and freeze the ingredients that aren't being used right away.
- **Plant your own** — Start an outdoor or kitchen garden to save money. Grow herbs, cucumbers, tomatoes, and peppers.
- **Save time, cook wisely** — Prepare meals ahead of time. Prep dinner in-

redients on the weekend and freeze them. Or get them ready in the morning and store them in the refrigerator.

- **Make big batches** — Cook larger quantities of chicken, sauces, vegetable stews, and other foods. Freeze the meals for a busy day in the future or eat them as leftovers.
- **Use overripe fruit** — Instead of throwing away food, repurpose it. Mushy bananas are perfect for banana bread, and soft berries can be used in smoothies.
- **Try new foods** — Keep meal time interesting and cook foods you haven't tried. Mango, lentil, and kale are delicious and nutritious.
- **Watch portion sizes** — Use a smaller plate to "trick" yourself into thinking you have consumed more food.

TOPS Club Inc. (Take Off Pounds Sensibly) is the original weight-loss support and wellness education organization. Founded more than 64

years ago, TOPS is the only nonprofit, noncommercial weight-loss organization of its kind. TOPS promotes successful weight management with a "Real People. Real Weight Loss." philosophy that combines support from others at weekly chapter meetings, healthy eating, regular exercise, and wellness information. TOPS has about 170,000 members — male and female, age seven and older — in nearly 10,000 chapters throughout the United States and Canada.

Visitors are welcome to attend their first TOPS meeting free of charge. Membership is affordable at just \$28 per year in the U.S. and \$32 per year in Canada, plus nominal chapter fees. To find a local chapter, view www.tops.org or call (800) 932-8677.

Kentucky's jobless rate drops below 9 percent in January

FRANKFORT — Kentucky's seasonally adjusted preliminary unemployment rate fell below 9 percent for the first time in three years as it dropped to 8.8 percent in January 2012 from a revised 9 percent in December 2011, according to the Office of Employment and Training (OET), an agency of the Kentucky Education and Workforce Development Cabinet.

The preliminary January 2012 jobless rate was 1.1 percentage points below the 9.9 percent rate recorded for the state in January 2011. The state's January 2012 rate is the lowest since the January 2009 rate of 8.9 percent. The U.S. seasonally adjusted rate fell to 8.3 percent in January 2012 from 8.5 percent in December 2011, accord-

ing to the U.S. Department of Labor.

Labor force statistics, including the unemployment rate, are based on estimates and are compiled to measure trends rather than actually to count people working.

In January 2012, Kentucky's civilian labor force was 2,066,349, a decrease of 2,694 individuals compared to the previous month.

"For the first time since January 2009 Kentucky's unemployment rate is below the 9 percent mark after having peaked at 10.7 percent just two years ago in January 2010," said economist Manoj Shanker of the OET. "Overall the employment indicators are moving in the right direction. An employment gain of nearly 1,300 from

the previous month and a drop in unemployment of around 4,000 easily offset the net decline in the labor force."

Preliminary estimates show that since January 2011 the state has added about 19,600 jobs for an employment level of 1,884,484. The number of unemployed has fallen by more than 22,800 over the same period, said Shanker.

Seven of the 11 major nonfarm North American Industry Classification System (NAICS) job sectors reported an employment increase in January 2012, while three decreased and one stayed the same, according to OET.

According to the seasonally adjusted employment data provided by the Bureau of Labor Sta-

tistics' Current Employment Statistics (CES) program, Kentucky's professional and business services sector jumped by 3,700 positions in January 2012. This area includes professional, scientific and technical services; management of companies; and administrative support and waste management, including temporary help agencies. Since last January, jobs in the sector have grown by 13,100 or about 7 percent.

"The prolonged recession has made primary employers wary about the signs of recovery. Instead of expanding their core workforce, these employers first contract with employment service companies. Employment for business and technical consultants, as well as temporary help agencies have surged because of this wait-and-see attitude," said Shanker.

Construction sector jobs rose by 1,800 in January 2012. Since January 2011, employment in the construction sector has increased by 1,300 jobs. "The unusually mild winter has caused traditional spring construction activities to move into December and January," said Shanker.

Kentucky's manufacturing sector gained 1,100 jobs in January 2012. Since January 2011, employment in the manufacturing sector has climbed by 5,800 positions.

Within manufacturing, employment in the durable goods industries was up by 7,300 jobs from a year ago. "The broad-based improvement in the national economy has resulted in an increase in consumer confidence and consumer spending. As a result, the demand for durable goods including automobiles has increased," Shanker said.

The trade, transportation and utilities sector rose by 900 jobs in January 2012. This area

includes retail and wholesale trade, transportation and warehousing, businesses, and utilities. It is the largest sector in Kentucky with 369,100 positions. Since January 2011, the number of jobs in this sector has jumped by 5,900.

"This sector has had 18 months of continuous year-over-year growth and is just about 4 percent short of returning to its pre-recession peak of 386,900 in October 2007," said Shanker.

Employment in the other services sector, which includes such establishments as repair and maintenance businesses; personal and laundry services; religious organizations; and civic and professional organizations, increased by 500 positions in January 2012. This sector had 100 more positions than in January 2011.

The state's leisure and hospitality sector gained 400 jobs in January 2012 compared to a month ago. Since January 2011, the sector has grown by 3,900 positions. The leisure and hospitality sector includes arts, entertainment and recreation, accommodations, and food services, and drinking places industries.

The information sector had 200 more jobs in January 2012. This segment, which includes firms involved in publishing, Internet activities, data processing, broadcasting and news syndication, has lost 400 positions since January 2011.

Employment in the mining and logging sector remained steady from December 2011 to January 2012. The number of jobs in the sector dropped by 400 from January 2011.

The government sector, which includes public education, public administration agencies and state-owned hospitals, recorded a decline of 100 jobs in January 2012.

The sector had 4,300 fewer jobs than in January 2011.

The educational and health services sector fell by 400 jobs in January 2012. The sector has gained 4,700 jobs since January 2011. This sector includes private and nonprofit establishments that provide either education and training or health care and social assistance to their clients.

"For the second month in a row, the educational and health services sector has lost employment, which is unusual. At this point, it appears that the nursing and residential care facilities have reduced jobs," Shanker said.

The financial activities sector decreased by 500 jobs from a month ago. This segment, which includes businesses involved in finance, insurance, real estate and property leasing or rental, had 1,900 fewer positions than in January 2011.

Civilian labor force statistics include nonmilitary workers and unemployed Kentuckians who are actively seeking work. They do not include unemployed Kentuckians who have not looked for employment within the past four weeks.

Kentucky's statewide unemployment rate and employment levels are seasonally adjusted. Employment statistics undergo sharp fluctuations due to seasonal events, such as weather changes, harvests, holidays and school openings and closings. Seasonal adjustments eliminate these influences and make it easier to observe statistical trends. However, because of the small sample size, county unemployment rates are not seasonally adjusted.

Learn more about the Office of Employment and Training at www.workforce.ky.gov.

Winter heating cost savings

STEPS TO HELP SAVE ON YOUR ELECTRIC BILL

It happens every winter. Customers open their electricity bills and see higher-than-expected amounts due. While increasing energy costs are, unfortunately, becoming a bigger part of daily living, there are some actions you can take to reduce and control your electricity costs. First, remember you only pay for what you use. Any step you take to reduce your electricity usage will save you money. The following are some energy and cost savings tips.

- Set your thermostat between 66-72 degrees
- Turn lights off when you leave a room; don't burn lamps and overhead lights unnecessarily
- If you are not watching TV, leave the set off
- Install energy efficient light bulbs such as compact fluorescent bulbs (CFLs)
- Properly insulate your home, windows and water heater
- Unplug cell phone chargers and other recharging/transformer devices when not in use

You can find more energy saving tips and information about energy saving programs offered by Kentucky Power at: Kentuckypower.com/save/.

If you have questions about your electricity bill, contact Kentucky Power toll free, 24-hours a day, at (800) 572-1113.

KENTUCKY POWER
A unit of American Electric Power
KentuckyPower.com

Hall

From Page B1

Girls' Court of Honor; Regions 1-4 — Lex

Lindsey (Franklin-Simpson); Regions 5-8 — Jim Wright (Shelby Co.); Regions 9-12 — Ralph Sal-

lee (Lexington Christian/East Jessamine); Regions 13-16 — Phillip Wireman (Johnson Central)

Your news ... Your newspaper

Floyd County Times

Community News, Sports Scores

Editorials, Church Events

and Breaking News

YOUR NEWSPAPER

Story idea or news tip?

Call 606-886-8506

WEDNESDAY,
MARCH 14, 2012

email: fctfeatures@floydcountytimes.com
www.floydcountytimes.com
Phone: 606-886-8506
Fax: 606-886-3603

Lifestyles

Country Wildfire Band heats up Rural Roots Series

PAINTSVILLE — Appalachian Artists Inc. will present the sixth in a series of eight concerts in the Rural Roots Series, as the Country Wildfire Band, of Scottsville, is set to entertain at 7 p.m. Saturday.

With a vast repertoire of songs that span the ages, this exciting group burns up the stage with outstanding musicianship and heart-felt harmonies. Best known for their multi-instrumentation and strong vocals, these talented musicians have

successfully melded the genres of Classic Country and Southern Rock into a unique sound of their own. They perform an exciting mix of both old and new country, with heavy emphasis on traditional tunes. You'll hear everything from Loretta Lynn, Merle Haggard, Patsy Cline and Johnny Cash, to the modern sounds of Sara Evans and Toby Keith.

The Country Wildfire Band includes Jimmy Mandrell, lead guitar and vocals; Melissa Mandrell,

female vocalist; Gary Mandrell, keyboards; rhythm guitar and vocals; Craig Dillard, bass guitar; and James "Catfish" Reed, from Flat Gap, on drums.

Musical talent runs deep in a family group that's distantly related to the famous Lynndell Sisters. Their motto is Family, Love, Life & Music. "We can't go a day without it," said Melissa. "We're just good, old-fashioned country musicians with Southern ways."

Participating sponsors in the Rural Roots Series

include U.S. 23 Country Music Highway Museum; Appalachian Wireless; Citizens National Bank; Hutch Buick/Chevrolet; GMC; McDonalds of East Kentucky; and Ramada Inn. The series will continue through the spring of 2012.

Concert tickets at \$15 per person are available at the U.S. 23 Country Music Museum in Paintsville, the Johnson County Public Library, Paintsville City Hall, and at the door. For further ticket information,



contact Tyler Stephens, 606-205-9644. For band information, call Melissa

Mandrell at 270-622-1703 or Gary Mandrell at 270-618-0105.

Pests in paradise

Sandy Miller Hays
Agricultural Research Service

At my house, we have what's known as "The Sandy Curse."

You know how it goes; whatever checkout line Brian and I choose at the grocery store, that line grinds to a halt five people ahead of us. If we switch to a different line, our second-choice line grinds to a halt, and the previous line starts zipping along like that famous chocolate-factory conveyor belt in "I Love Lucy." Sometimes I tell Brian, "Next time you hear me say the words, 'Hey, I've got a good idea,' just run!"

So I was totally sympathetic when I read recently that in some of the most beautiful places on the face of the earth, they have some of the most horrendous insect pests...but I've never even been there, I swear it!

Seriously, wouldn't you jump for joy if you found out you'd just won a trip to, oh, say, French Polynesia? Or the Azores? Unfortunately, the pests in question have already beaten you there.

The good news, though, is that the scientists of

the Agricultural Research Service (ARS) are using Mother Nature to keep things naturally beautiful in those luscious spots. Even if we don't ever get to go there ourselves, the ARS scientists' efforts could also benefit us, because the pests in question are also invasive in the United States (just think of this as an ounce of prevention being worth a pound of cure).

Let's start with the Azores (yes, please). In case you're unfamiliar with them, they're a group of nine volcanic islands off the coast of Portugal some 930 miles west of Lisbon. People flock there to take in the lush scenery, splash in the blue and green lagoons, and partake of the laid-back island lifestyle.

Unfortunately, people aren't the only species that has flocked there. In the early 1970s, the Japanese beetle was accidentally introduced onto the island of Terceira. Over the next 40 years, the beetle population has exploded, causing major agricultural damage and threatening Terceira products. Because of frequent travel between the islands, the pest has now spread through most of the

other islands in the archipelago.

But there's bad news for the beetles! Starting in the late 1980s, an ARS entomologist conducted research on development of a fungus called *Metarhizium anisopliae* as a biological control against the marauding pests. After his retirement, another ARS entomologist picked up the reins and has been collaborating with the Azoreans to further develop the fungus to control the beetle.

In 2008, that entomologist traveled to the Azores to teach the Azorean scientists how to mass-produce spores of the fungus. He describes the fungus' effect on the beetles as being "like fatal athlete's foot," since the fungus infects the bug by penetrating through its hard shell, often via the feet. Once the fungus gets inside, it begins to grow, and within a week, that beetle is dead. With any luck, the dead beetle also is covered with fungal spores which then spread to other beetles to repeat the cycle.

Now, let's island-hop (a very long way) over to French Polynesia, another archipelago whose six island groups are considered a tropical paradise. The fly

in the oftment there actually is a fly: the Oriental fruit fly, a pest well-known to the United States, and now busy causing severe damage to French Polynesian agriculture, a major industry with exports of tropical fruits and vegetables.

In 2003, an ARS scientist based in Hawaii introduced into French Polynesia the parasitic wasp *Fopius arisanus*, a natural enemy of the Oriental fruit fly that's already proven highly successful in biocontrol programs in Hawaii.

The wasp attacks the fruit fly by laying its eggs inside the fruit fly egg. The wasp egg continues to develop during the fruit fly larval and pupal stages. However, before the adult fruit fly can emerge, the wasp comes out first, killing the fruit fly.

More recently, the ARS scientist has introduced a second species of beneficial parasite, *Diachasma longicauda*, in Tahiti. The program is continuing its success against not only the Oriental fruit fly, but also the Queensland fruit fly.

This is great news for these island paradises—

but I think I'll postpone making my vacation plans, because I don't want to jinx things with The Sandy Curse!

The Agricultural Research Service is the chief

in-house scientific research agency of the U.S. Department of Agriculture. You can read more about ARS discoveries at <http://www.ars.usda.gov/news>. Everybody's Science.

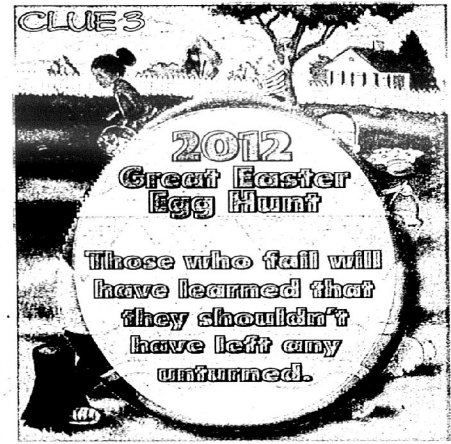

FAN

fever...catch it!



BUNDLE NOW & SAVE WITH IMC!

1.800.635.7052
www.imctv.com



606-358-4800
Refills at www.howardfamilypharmacy.com

Get your game on at
www.floydcountytimes.com
with our online
college basketball
bracket contest!

The Floyd County Times

To become a
Fan Fever Sponsor
of this space:

call Jessica or Brian
@ 606.886.8506

OUR YESTERDAYS

(Items taken from
The Floyd County
Times, 20, 30, 40, 50
60, 70 years ago.)

20 years ago
(Mar. 11 and Mar. 13,
1992)

A Pike County man was found not guilty by a Floyd County jury, Tuesday in the March 1991, shooting death of a Floyd County man. Jurors deliberated just an hour and twenty minutes before returning a not guilty verdict for Ralph Gerald Newsome, 27, of Virgie, Newsome was charged with first degree murder in the March 9, 1991, shooting of Greg Perry of Printer. The two-day trial began one year to the date, after the shooting.

With little fanfare and only limited opposition, Prestonsburg's City Council approved annexation measures, Monday, that set the stage for the start of parimutual wagering in Floyd County. Council adopted four ordinances, Monday, that incorporate a section of Route 3 and the proposed site of an intertrack wagering (ITW) facility into the city limits, also authorizing the sale of liquor by the drink at the ITW development.

A Prestonsburg police officer has denied the allegations made by his 18-year-old daughter in a civil suit filed February 28. In the suit, Virginia Slone alleged that she was brutally beaten by her father, Anthony Case, three years ago while Prestonsburg police officers ignored her pleas for help.

The Floyd County Board of Education unanimously approved a recommendation from superintendent Ronald Hager, Tuesday, evening to proceed on developing one of four alternate sites proposed as the location of a new Prestonsburg High School. Hager's site recommendation was part of a series of proposals to be made by the superintendent during Tuesday night's regular meeting of the board.

Floyd County will play host to at least 92 Kentucky county treasurers and finance officers, this week, when the organization meets for its spring conference

at Jenny Wiley State Park. Floyd County Treasurer Deloris Dings said the local meeting is the first ever, east of Lexington, for the organization.

Kentucky Education Commissioner Thomas Boysen began ouster proceedings against Floyd County School Superintendent Ron Hager, Thursday, by accusing Hager of willful neglect of duty and misconduct in office. The written charges were presented to the State Board of Elementary and Secondary Education, Thursday morning, when they resumed their March meeting.

All but about a dozen of Wheelwright High School's 218 students walked out of their classrooms, Thursday, in a show of support for their principal, who has been charged with sexually abusing a female student. The students left school at 8:55 a.m., Thursday, setting up a picket line outside the school, and vowing not to return to classes until principal Lewis Berkheimer is reinstated to his position.

A Floyd County truck driver was injured, Tuesday, in a traffic accident on the Mountain Parkway that left one person dead. James B. Hays, 43, of Betsy Layne, was driving an oil tanker truck east of the intersection of Wolf Creek when it collided head-on with a car driven by Betty Jo Sluss of Inez. Sluss was pronounced dead at the scene.

Prestonsburg Housing Authority members voted, Wednesday, to hire a consulting firm to oversee an \$850,000 renovation project at Indian Hills. Sassie, a Paducah management consulting firm, was picked to oversee the project and the company scored a 92 on a Department of Housing and Urban Development (HUD) evaluation form.

There died: Herman Joseph, 48, of Prestonsburg, Friday, at the V.A. Medical Center Hospital in Louisville; Tive Daniel, 84, of Paintsville, Saturday, at his home; Alison Rosetta M.

cal Center; William Charlie Johnson, 71, of Wheelwright, Monday, at Central Baptist Hospital in Lexington; Philip Delmar "Dude" Hagans, 63, of Langley, Sunday, at Highlands Regional Medical Center; Roger Lee Coleman, 48, of Louisa, Saturday, at the Humana Hospital in Louisa; Ronald David Blair, 47, of Staffordville, Wednesday, at Highlands Regional Medical Center; Wilmer Stapleton, 66, of Hager Hill, Sunday, at his home; Aney Hicks Bolen Martin, 76, of Wapiconeta, Ohio, formerly of Mousie, Thursday, at her home; Melba O. Dyer, 88, of Abingdon, Virginia, formerly of Allen, Monday, at the Johnstown Memorial Hospital in Abingdon; Lloyd Cox, 70, of Louisville, Saturday, at Louisville; Dave Rowe, 72, of Belleville, Mo., formerly of Pike County, Tuesday, at Beyer Hospital in Michigan; Rudy Parsons Jr., 35, of Martin, Wednesday, at his residence.

(March 17, 1982)

Denver Patrick pleaded guilty to murder, and arson charges in Boyle Circuit Court, and was sentenced to life in prison for the murder of James Neimi and 20 years for arson.

Glen Hicks, 21, of Johnson County, was convicted of the murder of two men, Steven Sharkey and Raymond Holbrook.

Two short roads and three new bridges represent this county's share of about 564 projects included in an upcoming five-year state construction program.

There died: Olga May Latta, 79, Tuesday, at Beyer Hospital; Mary Ann Hays, 79, of Manor Nursing Home; Bryan D. Hall, 6, of Banner, last Thursday, at UK Medical Center; Ulysses Wright, 69, of Milford, Indiana, formerly of Eruma, last Wednesday, at Goshen General Hospital; Delilah Osborne, 75, of Hunter, Saturday, at her home; Polly Oiler, 65, of Galveston, Monday, at Pikeville Methodist Hospital; James Roberts, 64, of Harold, Tuesday, at his home; Alison Rosetta M.

Hecker, five-week-old daughter of Connie Miller and Mark Hecker, of Prestonsburg, Tuesday, at UK Medical Center; Tilda Hamilton, 66, of Teaberry, last Tuesday at Pikeville Methodist Hospital; Troy Hicks, 82, of David, Sunday, at Paintsville Hospital; Jenny Stephens, 84, of Prestonsburg, Tuesday, at Riverview Manor Nursing Home.

40 years ago
(March 16, 1972)

Flood control dams in the Big Sandy River watershed saved the valley an estimated \$1,466,000 flood damage during late February, the U.S. Army Corps of Engineers said this week.

"Surface mining is not a problem at Dewey Lake at this time, and the lake is not in bad shape at all," James Lynch, of the Huntington district office, U.S. Army Corps of Engineers, said last Friday. More than a year ago, a Kentucky Parks official reported 60 or more surface mining operations in the Johns Creek (Dewey Lake) watershed. Before a plumber could arrive and repair a gas leak detected earlier in the day, the home of Mrs. Liddie Miller on Highland Avenue here "blew up" last Thursday afternoon.

Miss Susie Meador, daughter of Mr. and Mrs. John H. Meador, of Prestonsburg, won the title of Junior Secretary of 1972 in the state conference of PBS, held recently at Cumberland Falls. Born: A daughter, Kristi Lynn, on February 25, to Mr. and Mrs. William Jarvis May, of Prestonsburg; a son, William Ronald, on March 9 to Mr. and Mrs. Ronnie Newsome, of Water Gap.

There died: George W. Hale, Sr., 77, of Kermit, W. Va., formerly employed by the First National Bank here; Cesco Slone, 76, of Wayland, Sunday, at a Martin hospital; Mrs. Callie Paige, 94, of Dvale, Sunday, at a Martin hospital; Woodrow Meade, 54, of Prestonsburg, Saturday, at the Prestonsburg General Hospital; Fred Cottrell

Burchett, 60, native of Prestonsburg, Friday, at Kent, O.; Mrs. Martha A. Bentley, 53, of Albion, Ind., formerly of the Hi Hat area, last Tuesday, in a Columbia City, Ind., hospital; Floyd Hampton, 61, of Puncheon, last Wednesday, in a Jenkins hospital; Mrs. Victoria Hall, 68, last Tuesday, at her home at Tompost; Farley Gibson, 49, formerly of West Prestonsburg, February 14, in Ypsilanti, Mich.; C.C. Lum Parker, 66, Friday, at his home at Minnie; Mrs. Mary Alice Hall, 93, of Catlettsburg, formerly of this county, last Tuesday, at King's Daughters' Hospital, Ashland.

50 years ago
(March 15, 1962)

The Prestonsburg City Council, faced with a big fiscal problem, met with the taxpayers in a town hall meeting, Monday evening, to present a budget of \$107,628, approximately \$40,000 greater than the revenue last year. The Small Business Administration office temporarily set up here, Monday morning, closed at noon Wednesday.

Services which otherwise would cost many thousands of dollars were rendered without charge to 31 children at the pediatric clinic held Tuesday, at the Floyd County Health Department.

The district community development contest has been won by Prestonsburg, and the city is one now being considered for state honors.

Contractors' bids on the construction here of 40 low-rent public housing units will not be opened March 26, as originally scheduled, it was said here this week by Joe Hobson, executive director of the Municipal Housing Commission. The bids will be opened April 3.

Announcement was made this week that the Spurlin Insurance Agency, here, has been purchased by C.R. Hatton.

J.B. Clark, disaster chairman of the Floyd County Chapter, American Red Cross, announced that, as

of Monday, 73 families have applied for Red Cross assistance because of the recent flood.

Born: A daughter, Kathleen, on February 28, to Mr. and Mrs. Randall Hall Leslie, of Louisville.

There died: Jake Walters Jr., 39, of Drift, Sunday, near his home; Mrs. Angeline Bates, 96, of Kite, at her home, last Wednesday; Steve Pieratt, 90, retired Mt. Sterling banker, farmer, and former legislator, last Tuesday, in Mt. Sterling; William T. Hatcher, 76, of Lacey, former Floyd County tax commissioner, last Wednesday at a Huntington, W.Va., hospital; Mrs. Lily May Gibson, 46, formerly of East, Friday, in Rochester, Mich.; Alto Bradley, 38, of Auburn, Ind., formerly of Martin, February 26, in an Auburn hospital.

60 years ago
(March 13, 1952)

County Judge Henry Stumbo said this week, that a recent conference with Dr. Bruce Underwood, state health commissioner, have convinced him that the only possibility of construction of the proposed, and much argued, Floyd County War Memorial Hospital rests on selection of a site at or near Martin, and he is not certain even agreement on that location will result in the hospital being built.

Lexia Potter and Ira Fields, Jr., assumed the charge, Tuesday, of the Grapette Bottling Company plant here which they purchased from Orville Howard, Harlan, and H. K. Howard, of Prestonsburg.

Approximately 75 persons were busy this week as volunteer workers, soliciting funds from Floyd Counties in an all-out drive to reach the county's \$8,730 Red Cross quota this year, L.B. Breashear, Fund chairman said Tuesday.

Among the new shows billed at the Martin Theatre in coming days is "Stage to Blue River," with Whip Wilson and Fuzzy Knight.

There died: Russell Smith, 56, Glo miner, following a mining accident last week in which his leg was mangled by a coal-cutting machine; Martha Newsome Tackett, 40, Monday, at her home at Dony; Joe Cole, janitor at Eastern Gas & Fuel Associates (Koppers), Sunday afternoon.

70 years ago
(March 12, 1942)

Prosperity in the Eastern Kentucky coal fields is not around the mythical "corner" but is only a matter of a week or two away, was the opinion expressed here this week by observers of trends in the industry. Full operation of the National Youth Administration's machine shop here began Wednesday, with 96 boys at work in three separate experience units.

B. F. and A. B. Conbs, Prestonsburg attorneys, Wednesday, purchased from S. R. Auxier, the Auxier Hotel property on First avenue here at a reported price of \$18,000.

Although defeated twice during the regular playing season by the Betsy Layne Bob Cats, the Prestonsburg high school Black Cats are the twice-crowned champions of Floyd County by virtue of tournament victories over the selfsame Bob Cats.

An automobile battery complete with two-year guarantee, was advertised this week by Ernest Evans' Western Auto Store here at a price of \$5.95.

Born: to Mr. and Mrs. John Delong, of Banner, a son, Feb. 11; to Mr. and Mrs. Ervin Conley, of Auxier, a daughter, Vanda Sue.

There died: Mrs. Will Rowe, 60, Saturday, at her home at Myrtle; Lewis Merritt, 89, formerly of Prestonsburg, recently in Searcy, Arkansas; Mrs. Mary Adams Stratton, 77, Friday, at her home at Ivel.

Floyd County Clerk - Chris Waugh 2011 Account Statement of Receipts and Expenditures For the Twelve Months Ending December 31, 2011

RECEIPTS		EXPENDITURES	
Tax Bill Preparation	\$ 3,552.00	Licenses & Transfers	1,117,483.82
Election Personnel Reimb.	12,615.87	Usage Tax	4,748,954.00
Registration of Voters	2,282.72	Tangible Personal Property	1,369,705.97
Tax Bill Preparation	3,530.50	Affordable Housing Trust Fee	33,330.00
Calculation of Taxes	6,444.60	Fish & Game	14,769.00
Board of Elections Commission	1,000.00	Delinquent Tax	158,463.71
Election Cost Reimb.	82,160.70	Legal Process Tax	32,771.31
Licenses & Transfers	1,588,786.40	Tangible Personal Property	465,540.34
License & Transfers Refund	(221.50)	Occupational	447.01
Usage Tax	4,898,179.59	Beer & Liquor	7,980.00
Usage Tax Refund	(3,060.69)	Delinquent	127,639.49
Tangible Personal Property	3,760,527.72	Fire Acreage	305.99
Tangible Personal Property Ref	(1,587.65)	Deed Transfer	39,823.42
Fish & Game	16,021.00	Tangible Personal Property	1,762,907.62
Marriage	11,111.50	Delinquent	796,447.40
Occupational	493.50	Delinquent Taxes	96,023.70
Beer & Liquor	8,400.00	Delinquent Taxes	184,824.70
Deed Transfer Tax	41,814.53	Official Maximum Compensation	88,277.38
Delinquent Taxes	1,567,359.10	Official Expense Allowance	3,600.00
Delinquent Taxes Ref	(73,080.23)	Deputies Salaries	576,954.54
Del Tax Reg Account	2,230.00	Social Security	39,636.60
Fixture Filings	1,513.00	Medicare	9,269.74
Releases (Mrtgs / Deeds)	14,625.00	Life & Health Insurance	41,749.69
Deeds, Easements, Contracts	27,696.00	Vision Insurance	907.29
Real Estate Mortgages	39,526.00	Unemployment Insurance	5,737.38
Chattel Mortgage/Financial St	110,010.00	Train Fringe Benefits (HB 810)	3,678.60
Chattel Financial Statements	(22.00)	Advertising	496.92
Power of Attorney	2,576.00	Img, Index, Internet Website	8,426.95
Notary Bonds	3,159.00	Audit & Accounting	7,481.85
Property Bail Bonds	840.00	Tax Bill Preparation (PVA)	11,684.50
Wills	1,160.00	Office Utilities	8,344.85
Leases	3,086.00	Office Supplies	40,857.52
Articles of Incorporation	281.00	Office Expenses	45,951.15
Mechanics Liens & LIS Pending	25,738.00	Conventions & Travel	6,183.55
Mechanics Liens lis Pend Ref	(69.00)	Fees, Dues & Subscriptions	1,650.00
All Other Recordings	4,732.39	Postage	13,352.63
Copy Work	2,719.13	Errors & Omissions Ins.	1,429.78
Postage	1,630.66	Rental Fees	36,746.49
Candidate Filing Fees	0.00	Lease Fees	9,952.00
Miscellaneous	(342.16)	Election Expenses	81,970.70
Bank Interest Income	3,197.20	Office Equipment	3,678.00
Overage / Shortage	539.71	DRIVE THRU PROJECT	3,630.00
		Web Renewals	1,524.92
		NSF Expense	4,555.25
TOTAL RECEIPTS	12,169,175.59	TOTAL EXPENDITURES	12,015,145.76
		EXCESS FEES	\$ 154,029.83

Calendar

Calendar items will be printed as space permits.

Editor's note: To announce your community event, you may hand-deliver your item to The Floyd County Times office, located at 263 S. Central Avenue, Prestonsburg, or mail to: The Floyd County Times, P.O. Box 390, Prestonsburg, KY 41653; or fax to: 606-886-3603; or email to: features@floydcountytimes.com. Information will not be taken over the telephone. All items will be placed on a first-come, first-served basis as space permits.

Floyd County Senior Citizens Board
The regularly scheduled meeting of the Floyd County Senior Citizens Board will be at 4 p.m., Thursday, March 15, at the courtroom of the Fiscal Court.

AARP to meet
Jenny Wiley Chapter (#3528), AARP will meet at 5:30 p.m., Tuesday, March 20, at First Presbyterian Church, in Prestonsburg. Speakers for the meeting will be representatives of Aging Services of Big Sandy ADD.

Scottish Rite reunion
The Sandy Valley Scottish Rite Club will be having a reunion March 24, at the Paintsville Country Club. This event is open to all Masons in Eastern Kentucky.

Free clothes and household giveaway
The Middle Creek Volunteer Fire Department Ladies' Auxiliary will be giving free clothes and household items to anyone in need on Friday, March 23, from 9 a.m. to 6 p.m., and on Saturday, March 24, from 10 a.m. to 4 p.m. The giveaway will take place at the Old Middle Creek Fire Department on Route 114.

Donations of any kind will also be accepted.
For more information, call Daryl Faye Holbrook at (606) 886-8481 or (606) 226-3525.

Johnson reunion
The Mary and Green Johnson family reunion will be held Saturday, May 26, at the Weebury Community Center Park. Please bring a covered dish. For more information, call (270) 737-2629 or (937) 866-7937 or locally (606) 452-2473.

Maytown Homecoming

The Maytown Community Homecoming will be held Memorial Day weekend, May 25 and 26. Registration will begin Friday, May 25, at 10 a.m., in the old school building. There will be a gospel sing at 7 p.m., Friday night, at Graceway Church. Saturday, May 26, will begin with breakfast from 8 to 11 a.m. and an afternoon meal from 2 to 4 p.m. Meals will be catered and the \$22 per person fee must be paid in advance. Saturday activities will take place in the old lunchroom. On Saturday night, the evening program will feature the Valentinos, from Lexington. Admission will be \$5 at the door.

Send meal reservations by May 2 to Betty May, 363 Union Creek, Langley, KY 41645. For more information, call (606) 285-3362.

Floyd County Job Club

The Floyd County Job Club meets every Thursday, from 11 a.m. until noon, at the Children County Public Library, in Prestonsburg. This free job club is sponsored by Eastern Kentucky Concentrated Employment Program, Big Sandy Area Community Action Program and the Office of Employment and Training. At the club, you will get job leads, job search advice and networking opportunities that will help you get hired. All are welcome and first-time visitors are encouraged to come 30 minutes early for a new member orientation. Call (606) 886-2948, for more information.

Allen VFD membership drive
Allen Volunteer Fire Department is now holding a membership drive. Meetings are held every Monday night, at 6:30 p.m., at the station. Please stop and help your volunteer fire department or Roy Compton at (606) 791-1790.

Volunteer mentors wanted

Mentoring for a Second Chance is a jail-based service program designed to help reduce recidivism and promote positive growth, by linking nonviolent offenders with a mentor from the local community. M2C is looking for local men who are motivated to make a difference in the life of an individual while having a positive impact on the community.

If you or someone you know is interested in becoming a mentor, contact mentor coordinator Joshua Kinzer, (606) 886-4435, (606) 339-8878, or Jkinzer@M2Comp.org.

Veterans service officer

VFW Post 5339 in Lancer will have a service officer available every Wednesday, from noon until 4 p.m. Some services offered will be initial claim filing, upgrades, appeals, permanent and total claims and others. Contact (606) 886-9428 or (606) 297-1973 for more information.

Free Parenting Classes

To determine eligibility, call John 791-9887.

Communities Against Drug Addiction

Floyd County Communities Against Drug Addiction meets at 5:30 p.m. the third Thursday of each month, at Allen Baptist Church.

Autism Awareness & Support Group

2nd Monday of each month, Calvarys Church, Lancer, (6-7 p.m.). Contact: Billie Chain, eastautismawareness@gmail.com.

Autistic Children Support Group plans monthly meeting

Support group for Guardians of Autistic Children will meet the first Thursday of every month at the Haven of Rest, 1601 Airport Road, Inez. Call 606-298-0520 for information.

Non-profit agency needs foster parents.

Non-profit agency in need of foster parents in your

area. Financial compensation/bonuses, free foster parent trainings, mileage reimbursement, and 24-7 support are available. All foster children get a medical card, free school lunches, and clothing vouchers/other reimbursements. Call for more information at 606-886-0163 or visit our website at www.benchmarkfamilyservices.org/.

Auxiliary Learning Center offers home repair aid

Need help with home repairs? The Auxiliary Lifetime Learning Center can help. We are now taking applications for home repairs. If you or someone you know are low income and need help with repairs on your home, please call 606-886-0709 for your application, or stop by the office at 21 South River Street, Auxilium. Office hours: Monday-Friday, 8:00-4:00. Must provide proof of income and ownership.

FCHD offers Body Recall exercise classes

The Floyd County Health Department offers Body Recall gentle exercise classes every Monday, Wednesday, and Friday, at 9:30 a.m., at May Drive, just off 1428, and at 10:30 at the First Presbyterian Church in Prestonsburg.

Classes are free and open to the public. Call 886-2788 for more information.

Become a volunteer with Victim Services Program

You are more likely to be hurt by someone whom you know rather than be assaulted on Kentucky's streets by a total stranger. Learn to assist victims of sexual assault, child abuse and domestic violence by becoming a volunteer with Victim Services Program. Call today to receive an application for our free training program.

Call the Volunteer Coordinator at (606) 886-4323 for further information or to request an application. (The Victim Services Program is a program of Mountain Comprehensive Care Center.)

Outpatient Drug Treatment Program and Education

Narconon warns parents that abuse of addictive pharmaceutical drugs with youth is on the rise with deadly consequences. Learn the signs of drug abuse.

Call Narconon for a free brochure on the signs of addiction for all drugs. 877-379-0208.

www.drugsno.com
Auxiliary Community Center

Free GED classes, Monday, Tuesday and Wednesday, from 10 a.m.-12.

Free Bible Lessons

Write to: Bible Way Outreach Ministry, P.O. Box 3371, Kingsport, TN 37664. Lessons completely free of charge to all interested.

Need help with addiction?

Lifeline of Floyd County "Conquer Chemical Dependency" is a Christ-centered 12-step program offering support to those who are coping with addiction and learning to live drug-free lives. The support group meets on the following

schedule:
Mondays, at Minnie (beside pharmacy), from 7-8 p.m.

Mondays, at Little Mud, Spruce Pine School, from 7-8 p.m.

Tuesdays, in Prestonsburg, in the Van Ark Building, from 2-3 p.m.

Tuesdays, at David, The David School, from 3:30-4:30 p.m.

Wednesdays, at Allen Baptist Church, from 7-8 p.m.

Thursdays, at Allen Baptist Church, from 7-8 p.m.

For more information, call Shirley Combs at (606) 434-8400, or Tom Nelson at (606) 478-2836.

Need Help With Home Repairs?

The Auxiliary Lifetime Learning Center can help. We are now taking applications for home repairs. If you, or someone you know, are low income and need help with repairs on your home, please call 606-886-0709 for your application, or stop by our office at 21 South River Street, Auxilium. Office Hours: Monday-Friday, 8-4.

Hope in the Mountains

Hope in the Mountains will host public meetings on Mondays, at 9 a.m., at the junction of U.S. 23 and Rt. 80, on Water Gap Rd., behind the Trimble Chapel Church.

Meetings focus will be to offer information in regard to community resources available to women seeking freedom from drug abuse. Family members are also welcome to attend. The Hope initiative proposes to help women break free from addictive lifestyles to become self-respecting contributing members of society.

Call 874-2008 or 788-1006 for more information.

Democratic Woman's Club

The Floyd County Democratic Woman's Club meets the third Monday of each month at 6 p.m., at Prestonsburg City Hall.

Have an 'Out of this World birthday party!

The East Kentucky Science Center is now offering a fun and distinctive

party venue for kids of all ages. The Birthday Party package includes rental of a classroom and admission to exhibits and planetarium programs. Must be booked two weeks in advance; limit 40 guests. Call 889-8260 for more information.

Prestonsburg Rotary Club

Prestonsburg Rotary Club meets on Thursdays, 12 noon to 1 p.m., at Reno's Roadhouse. For additional information, contact Paula Howard, 263-3225, or Tommie Layne, 886-4585. Everyone welcome.

'Earn While You Learn'

The Big Sandy Area C.A.P. office is taking applications for its "Senior Training Program." You must be 55 or older to apply. In Floyd, call 886-2929; Johnson, call 789-6515; Magoffin, call 349-2217; Pike, call 432-2757; and in Lawrence, call 638-4067.

Looking for a Support Group?

Floyd County Alzheimer's Support Group meets regularly at Riverview Manor or Healthcare Center. Call the center for meeting times. Domestic Violence Support Group - The Big Sandy Family Abuse Center holds meetings each Tuesday from 5:30 to 6:30 p.m. The meetings are free of charge. Call 886-6025 for more information.

Overeaters' Anonymous - Meetings held each Wednesday at 6:30 p.m., at the old Allen Baptist Church, located in Allen, just past red light. Call 889-9620 for more info.

US 106 Prostate Cancer Survivors Support Group - For all men with prostate cancer and their families. Group meets the 3rd Thursday of each month, at 6 p.m., at the Ramada Inn, Paintsville.

Community Weight Loss Support Group - Meets Thursdays at 6:30 p.m., at the Martin Community Center. For more info., call 377-6658. Those who have had gastric bypass surgery most especially welcome to attend. Meetings being offered as support to

anyone needing extra support in dealing with weight loss.

Domestic Violence Hotline - 24-hour Crisis Line manned by Certified Domestic Violence counselors. Call 886-6025, or 1-800-649-6605. Remember, "Love Doesn't Have to Hurt."

Disabled? - You may be eligible for grant money to assist in your daily living. For an application or more information, call 886-4326.

A.S.K. (Adoptive Support for Kentucky) - Support group for all adoptive parents (public, private, international, and kinship care), foster parents and all others interested in adoption. To be held the first Monday of each month, at the Department for Community Based Services office, 1009 North Lake Drive, Prestonsburg, from 6-8 p.m. Childcare will not be provided. For more information, contact Dedra Stone, adoptive parent liaison, at 432-4110 or 422-7927, or email to: dsolone@eastky.net.

PARENTS! - Contact the Big Sandy Area Community Action Program, Inc. to find out about child care services in your area, the STARS for KIDS NOW licensing standards program, and how you can earn an income by staying home with your own children while caring for children of others. Find a more by calling Cheryl L. Scott at 886-1280, or 888-777-7277 (toll free).

East Kentucky S.T.A.R.S. Homeschoolers - Will hold monthly meetings at the Paintsville Recreation Center. For more information, call Trudy at 889-9333, or 297-5147. Everyone welcome.

Narcotics Anonymous (NA) - Each Wednesday, from 7-8 p.m., in the Atrium Conference Room, 2nd floor, May Tower, Pikeville Methodist Hospital. For more info., contact Chris Cook at 606-433-1119 or christophercook@hotmail.com.

Healthy Living

Has a New Address

Inside this special online section, you'll explore natural healing remedies, get the skinny on better eating habits and see which popular health myths get debunked. Plus, find helpful advertising and special offers from local businesses who support your healthy lifestyle choices.

HMB
health mind • body

An Online Magazine of

The Floyd County Times brought to you by

KING'S DAUGHTERS MEDICAL CENTER

Taking Medicine FurtherSM

Online Now @ floydcountytimes.com

Celebrating a Century



Della Smith-Cole, formerly of Floyd County, will celebrate her 100th birthday Thursday. She was born March 15, 1912, at Weebury. Cole's daughter, Katherine S. Gunnell, said her mother is greatly loved by all her children, grandchildren, great grandchildren and great great grandchildren.

CENTRAL DISCOUNT

12054 MAIN STREET, MARTIN, KY • 606-285-3368

Sale Runs Through
Saturday, March 17th
Cash & Carry

CONSTRUCTION LUMBER

	8'	10'	12'	14'	16'
2x4	\$2.09	\$2.69	\$3.29	\$3.69	\$4.39
2x6	\$3.28	\$3.98	\$5.39	\$5.79	\$6.48
2x8	-	\$6.77	\$7.17	\$7.97	\$9.47
2x10	-	\$6.97	\$9.97	\$10.97	\$12.97

Premium Construction Studs \$2.19
1 x 12 #3 \$0.79 Per Foot

PRESSURE TREATED LUMBER

	8'	10'	12'	16'
2x4	\$2.79	\$3.29	\$3.99	-
2x6	\$3.38	\$4.78	\$5.68	\$7.68
2x8	\$4.98	\$5.98	\$6.98	\$9.58
5/4x6	\$3.36	\$3.96	\$4.96	-
4x4	\$6.45	\$7.95	\$9.45	-

Chloe Creek Oak \$0.76 Sq. Ft.
Appalachian Cherry \$0.86 Sq. Ft.
Bristol Gunstock \$0.96 Sq. Ft.
Tennessee Red Oak w/Pad attached \$1.16 Sq. Ft.

1 1/2" PVC Pipe 10' Joint \$3.37
2" PVC Pipe 10' Joint \$4.97
3" PVC Pipe 10' Joint \$8.87
4" PVC Pipe 10' Joint \$12.37

VINYL WINDOWS

2030 Vinyl Double-Hung Windows	\$87.00
2830 Vinyl Double-Hung Windows	\$97.00
3030 Vinyl Double-Hung Windows	\$97.00
3243 Vinyl Double-Hung Windows	\$107.00
2052 Vinyl Double-Hung Windows	\$117.00
6 Panel Metal-Clad Door	\$116.00
9-Line Metal-Clad Door	\$126.00

SEPTIC TANKS

500 GALLON	\$290.00
750 GALLON	\$330.00
1000 GALLON	\$325.00
Infiltrator	\$1849

WATER HEATERS

30 Gallon Electric	\$259.00
40 Gallon Electric	\$269.00
50 Gallon Electric	\$259.00
40 Gallon Gas	\$329.00
40 Gallon Propane Water Heater	\$329.00
1500 Watt Utility Heater	\$13.98
DuraHeat #R2300 Kero Heater	\$37.00
Wonderwall Stove	\$124.00
Sentry Coal Stove	\$499.00

7/16" OAB	\$749
7/16" Advanced	\$1049

6' Fiberglass Step Ladder 225lb	\$45.00
6' Fiberglass Step Ladder 225lb	\$75.00
20' Extension Ladder 200lb	\$85.00

John Deere #3800 Mining Boots	\$179.98
John Deere #3810 Mining Boots	\$179.98
John Deere #3820 Mining Boots	\$169.98
All Hilti Boots	\$33.00
All Roadway Boots	\$33.00
All Magnum Boots	\$33.00
All Caterpillar Boots	\$33.00
All Rocky Boots	\$99.00
Metric Boots	Starting at \$49.00

JOHN DEERE CLOTHING 50% OFF

APPLIANCES

Danby 7 Cu. Ft. Microwave	\$249.00
Danby 17 Cu. Ft. Refrigerator	\$749.00
Bunn 10-Cup Coffee Maker	\$249.00

Portable 18-Volt Cordless Drill	\$69.00
Dewalt 18-Volt Cordless Drill	\$69.98
Hitachi 18-Volt Drill Combo Set	\$109.00
24" Roll-Around Tool Chest	\$32.00
123pc German Tool Set	\$529.98

POWER TOOLS

Chip-A-Rite Family Miter	\$169.98
Chip-A-Rite Family Miter	\$199.98

POWER AIR TOOLS

#13 Air Cannon - 2000cf	\$249.00
#12 Air Cannon - 2000cf	\$249.00

COIN-OPERATED

Chip-A-Rite Compressor #GR2414	\$159.98
Chip-A-Rite Compressor #GR2414	\$239.98

150 QUART COIN-OPERATED GENERATOR - \$599.00

5550 WATT CUMMINS GENERATOR - \$649.00

TRUCKS

50 Gallon Aluminum Roof Rack	\$16.00
9013 Roll Roofing Black	\$12.00
9013 Roll Roofing Brown	\$12.00
1513 Roll	\$15.00
9013 Roll	\$15.00
81715 Van	\$10.88
121715 Van	\$12.66
Black Face Underpinning	\$54.98

VANITY MIRROR

18" Vanity, White or Oak	\$35.00
24" Vanity, White or Oak	\$35.00
30" Vanity, White or Oak	\$125.00
36" Vanity, White or Oak	\$175.00
48" Vanity, White or Oak	\$225.00

12-2 Wire with Ground 250' Roll	\$79.98
200 Amp 3-Phase Breaker Box	\$25.00
200 Amp 40-Amp Breaker Box	\$16.00
Heritage Fortress 24" Gun Safe	\$379.00
Heritage Fortress 36" Gun Safe	\$1079.00

40% OFF KNIVES!

CASE KX • BENCHMADE
Smith & Wesson
Ruger, John Deere, Bud-K
Schwabe

UK

Sweatshirts - \$7.50
Tee-Shirts - \$6.50
Hats - \$4.00

First Lady visits teachers, parents at Reading Recovery event

SOMERSET — Kentucky First Lady Jane Beshear met this week in Somerset with educators and parents from seven Southern and Eastern Kentucky counties—including Floyd County—to discuss ongoing efforts to improve reading skills in young children.

Mrs. Beshear, a strong advocate for education and former high school teacher, attended a book-reading demonstration by a first-grade participant in the Reading Recovery program, followed by a roundtable discussion on how the reading program is changing the lives of struggling young readers across the region.

The event, hosted at The Center for Rural Development by Forward in the Fifth in partnership with the Kentucky Valley Educational Cooperative, was held Thursday, March 8, as part of a series of special statewide activities planned in observance of the second annual Kentucky Literacy Celebration Week.

"Our Commonwealth has made great strides in recent years, being the only state to show significant statistical improvement among fourth- and eighth-grade readers in both the 2007 and 2009 National Assessment for Education," Mrs. Beshear said. "However, we still have a long way to go to increase literacy at all levels and must work on both state and local levels to promote literacy not only as an education tool, but to

stay competitive in the 21st Century."

During the program, Jennifer Sheens, Debbie Goble, and Charlene Horn of Prestonsburg shared with the First Lady some of their success stories and personal experiences in working with Reading Recovery. The program is a school-based, short-term intervention designed for 5-6 year olds who have difficulty with reading and writing.

Many of the participants talked about the social and academic changes they have seen in their students as a result of the program. Elijah Davidson, a first-grade student at Hopkins Elementary School, proved that point by demonstrating his reading skills for the entire group.

Davidson, who was accompanied by his mother and his Reading Recovery teacher, read from the children's book, "Ratty-Latty," a story about a rat who was too clever for anyone to catch.

"I cannot say enough good things about this pro-

gram," said Elijah's mother, Christina Devlin. "Elijah has improved so much since he started working with Mrs. Wilson in the Reading Recovery program. It is a truly amazing program."

The program at The Center was in continuation with Mrs. Beshear's ongoing work with Forward in the Fifth to help advance education in the region and throughout the state. Forward in the Fifth, a non-profit organization and affiliate of The Center, serves a 42-county primary service area in Southern and Eastern Kentucky and beyond.

Mrs. Beshear was in Somerset last fall to attend Pulaski County Literary Day, where nearly 1,000 fourth-grade students in Pulaski County were each presented a complimentary book by Somerset businessman and education supporter Chuck Coldiron, and participated in a regional dropout prevention summit hosted by Forward in the Fifth in 2010.

"Literacy is so critical to our daily lives," said Forward in the Fifth Executive Director Jim Tackett. "These skill sets were at the heart of our mission more than 25 years ago when Forward in the Fifth was created and still rings true today."

Forward in the Fifth was created in 1986 by U.S. Congressman Harold "Hal" Rogers (KY-05) and other leaders to work to reverse low educational attainment levels in the Fifth Congressional District.

"Those who can read and effectively communicate have a limitless potential that will never be surpassed," Tackett said.

The Kentucky Literacy Celebration was created by the Collaborative Center for Literacy Development (CCLD) and First Lady Jane Beshear. Established by legislation in 1998, the CCLD's mission is to promote literacy and address the diverse needs of all learners through professional development for Kentucky educators and research that informs policy and practice.



Educators and parents from seven Southern and Eastern Kentucky counties met with Kentucky First Lady Jane Beshear on Thursday, March 8, at The Center for Rural Development in Somerset to collaborate on the importance of improving reading skills in young children. Meeting with First Lady Jane Beshear, front row, second from left, are Keith Lyons, coordinator of communications, marketing, and promotions for Collaborative Center for Literacy Development; Jim Tackett, executive director of Forward in the Fifth; and Vickie Stone, Hazard; second row, from left, Debbie Goble and Jennifer Sheens of Prestonsburg; third row, from left, Danna Duff, Hazard; Eunice Waddles and Alissa Huff of Hindman; Patricia Burgan, Harlan; and Donna Singleton of Hazard; and back row, from left, Mindy Ketcham, Tonya Halcomb, and Carla Hinkle of Barbourville; Charlene Horn, Prestonsburg; and Pam Miller and Susan Lacey of Campton.

MSU offering alternative certification info sessions

College graduates who are interested in a career as a teacher may want to attend one of the upcoming information sessions on the Master of Arts in Teaching (MAT) program at Morehead State University.

MSU offers three MAT programs (middle school/secondary/special education) in which degree holders with no prior teaching experience may obtain a master's degree and teaching certification, while employed as a teacher.

Orientation sessions for the MAT program at MSU will be held in various locations from March 20-April 10. At the sessions, program design, including admission and application processes for middle, secondary and special education teaching will be discussed. Interested persons are encouraged to bring transcripts, GRE/ACT scores and any PRAXIS test results they may have.

Sessions will be held on various dates at several locations:

- Tuesday, March 20, 4 p.m., University of Kentucky, James W. Stuckert Career Center;
- Thursday, March 22, 3:30 p.m., MSU at Jackson;
- Friday, March 23, 3:30 p.m., Morton Middle School in Lexington;
- Monday, March 26, 4 p.m., Main campus (610 Ginger Hall);
- Monday, March 26, 4 p.m., Mason County High School;
- Tuesday, March 27, 4 p.m., MSU at Ashland;
- Wednesday, March 28, 4:30 p.m., MSU at Mt. Sterling;
- Wednesday, March 28, 4:30 p.m., MSU at Prestonsburg;
- Thursday, March 29, 4 p.m., MSU at West Liberty;
- Tuesday, April 10, 3 p.m., Kentucky State University/Brankford.

Date and location are tentative for the West Liberty event. Check with MSU officials prior to March 29.

On MSU's Morehead campus, orientation meetings are available by appointment.

Additional information on the Master of Arts in Teaching is available by calling the program office at 606-783-2079, or by sending e-mail to Michelle Roberts, MAT admissions coordinator, at m.roberts@moreheadstate.edu.

The Times

CLASSIFIEDS

work for you!

sell — buy — rent — hire — find

Over 18,000 Readers every issue!

5 Easy ways to place your ad:

1. Call: (606) 886-8506, Ryan Hall
2. Fax: (606) 886-3603
3. E-mail: classifieds@floydcountytimes.com
4. Stop by: 263 S. Central Avenue, Prestonsburg
5. Mail: P.O. 390, Prestonsburg, KY 41653

Our hours: 8 a.m.-5 p.m.

DEADLINES:
Wednesday's Paper: 3 Mon. 4 p.m.
Friday's Paper: 5 Wed. 4 p.m.

Visa - MC - Discover
Check

The Best Way To Write An Ad:

- Begin with a key word (item for sale, etc.)
- Use descriptive words to identify your items
- State your price or terms
- Include a phone number and/or e-mail address

NAME

ADDRESS:

PHONE #:

Write your ad here:

(approximately
18 letters
per line)

CREDIT CARD:

Our CLASSIFIEDS Will WORK For You!!!

Legals

PUBLIC NOTICE

SEO CHAPTER 11 V. 1 NOTICE OF INTENTION TO MINE
Pursuant to Application No. 836-0413 Original

SEO CHAPTER 11 V. 1 In accordance with the provisions KRS 350.053, notice is hereby given that Auto Express Transport Services, 534 Conn St., Lexington, Kentucky 41642 has filed an application for a permit for a surface mine and reclamation operation affecting 0.57 located 0.09 miles southeast of Barner in Floyd County.

The proposed operation is approximately 1.09 miles southeast of the junction of US 23 with KY State Route 1426 and is located on Levisa Fork of the Big Sandy River.

The proposed operation is located on the Harold USGS 1/2" minute quadrangle map. The surface area is owned by Gregory Hall. This application contains a request for a variance for experimental practice from the requirement to 405 KAR 7:060(2)(4)(a) as required under regulation, 405 KAR 7:060(2)(4)(a).

The application has been filed for public inspection at the Department for Natural Resources, Prestonsburg Regional Office, 3140 South Lake Drive, Suite 6, Prestonsburg, Kentucky 41653. Written comments, objections, or requests for a permit conference must be filed with the Director, Division of Mine Permits, #2 Hudson Hollow Complex, U.S. 127 South, Frankfort, Kentucky 40601.

This is the final advertisement of the application. All objections, comments, or requests for a permit conference must be received within thirty (30) days of today's date.

PUBLIC NOTICE NOTICE OF INTENTION TO MINE

Pursuant to Application Number 836-9023, Renewal #1

In accordance with KRS 350.053, notice is hereby given that N.F.C. Mining, Inc., 439 Meadows Branch, Lexington, Kentucky 40513 has applied for renewal of a permit for a refuse disposal facility located 1.0 miles southeast of Prestonsburg in Floyd County.

Legals

stonsburg in Floyd County. The proposed operation will disturb 39.15 surface acres.

The proposed facility is approximately 1.3 miles southeast from Big Branch Road's junction with KY Route 302 and located on Big Branch.

The proposed operation is located on the Lanco U.S.G.S 7 1/2" x 12" minute quadrangle map. The surface area is owned by Nancy J. Roberts and Tri-Star Development, LLC.

The application has been filed for public inspection at the Department for Surface Mining Reclamation and Enforcement's Prestonsburg Regional Office, 3140 South Lake Drive, Suite 6, Prestonsburg, Kentucky 41653. Written comments, objections, or requests for a permit conference must be filed with the Director, Division of Mine Permits, #2 Hudson Hollow, U.S. 127 South, Frankfort, Kentucky 40601.

This is the final advertisement of this application; all comments, objections or requests for a permit conference must be received within 30 days of this date.

NOTICE OF BOND RELEASE
In accordance with the provisions of KRS 350.093, notice is hereby given that Day Diamond Company, Inc., 183 Tollgate Pike, Kentucky 40511 intends to apply for Phase II and III release on Increment 31 of Permit Number 898-0771 which was last issued on January 18, 2012. Increment 31 covers an area of approximately 23.28 acres located 5.70 miles southwest of Pikeville and is situated in both Pike and Floyd County, Kentucky.

The proposed operation is approximately 4.20 miles southwest from Pike 1289's junction with KY Route 1426 and located 1.10 miles south of island creek.

The bond now in effect for Increment 31 is a letter of credit in the amount of \$32,700. One hundred percent of the original bond amount is included in this application for Phase II and Phase III release.

Legals

Reclamation work performed for Increment 31 includes backfilling, grading and seeding which was completed in October 2002. Results thus far achieved are consistent of the post-mining land use.

Written comments, objections, and request for a public hearing or informal conference must be filed with the Director, Division of Mine Reclamation and Enforcement, #2 Hudson Hollow, U.S. 127 South, Frankfort, Kentucky 40601 by April 20, 2012.

A public hearing has been scheduled for Monday, April 23, 2012 at 10:00 a.m. at the Division of Mine Reclamation and Enforcement's Pikeville Regional Office, 121 Mays Branch Road, Pikeville, Kentucky 41601. The hearing will be cancelled if no request for hearing or informal conference is received by April 20, 2012.

PUBLIC NOTICE COMMONWEALTH OF KENTUCKY FLOYD CIRCUIT COURT

DIVISION NO. II
C.A. NO. 11-CI-00709

DELAINE D. COLLINS, PLAINTIFF,

VS.
JASON A. TENNEY, DEFENDANT.

NOTICE OF PENDING ACTION

By virtue of the Order of the Floyd Circuit Court, dated January 29, 2011, the undersigned was appointed to serve as Warning Order to notify Jason A. Tenney of the pendency of a Complaint with which the Defendant's vehicle accident that occurred on February 21, 2011 on Kentucky Route 580, Frasures Creek, McDowell, Kentucky, is pending. The Plaintiff has alleged personal injuries as a result of the accident and has filed the Complaint against Jason A. Tenney for damages.

Notice is hereby given that the above described real estate as additional security directed to come forward and present any defense to the Complaint he may claim or be forever barred.

SIGNED:
A. DAVID BLANKENSHIP, Warning Order Attorney
KINNER & PATTON LAW OFFICES
328 East Court Street
Prestonsburg, Kentucky 41653
(606) 886-1343

Legals

PUBLIC NOTICE

COMMONWEALTH OF KENTUCKY
FLOYD CIRCUIT COURT
DIVISION NO. I
C.A. NO. 09-CI-00996

JPMORGAN CHASE BANK, NATIONAL ASSOCIATION PLAINTIFF

VS.

PENNY GUNNELLS, ET AL. DEFENDANTS

RE-NOTICE OF COMMISSIONER'S SALE

By virtue of a Judgment and Order of Sale of the Floyd Circuit Court entered the 12th day of May, 2010, in the above cause, as their interest in the subject property, for the sum of \$55,920.54 with interest thereon, plus additional sums and costs, please be advised that I shall proceed to offer for sale at the Old Floyd County Courthouse Door, South Central Avenue, Prestonsburg, Kentucky (behind the new Jane Beshear Justice Center), to the highest and best bidder, at public auction, on the 28th day of March, 2012 at 9:30 a.m., upon the terms set forth following the description, the following described property, to wit:

Property Address: 3058 S. Creek, Stanville, Kentucky 41659

That certain parcel of land lying on the waters of Mare Creek of Levisa River, and situated two miles northeast of Stanville, Kentucky in Floyd County, more particularly described as follows:

Beginning at a point in the mouth of a drain and in Mare Creek and on the northern side of Mare Creek Road; thence leaving Mare Creek and on a chord up the drain, said line being the property line between Martha Blackburn and Devon Scott, north 10 degrees 09 minutes 00 seconds east 230.00 feet to a point; thence leaving the drain and with lines around the foot of the hill said lines being the property divisional lines between Martha Blackburn and Kenas Hall and the following: South 49 degrees 10 minutes 35 seconds east 108.56 feet to a point near a clump of small poplars; thence South 70 degrees 24 minutes 30 seconds east 40.00 feet to an 8" x 12" inch iron road set, said point situated 69 feet west of Kentucky Power Company Pole Number 1078-67; thence leaving said property divisional line and through Martha Blackburn's property a new line South 11 degrees 59 minutes 00 seconds west 154.00 feet to a point in Mare Creek; said point being 6 feet south of a 16 inch and 8 inch Poplar Trees standing on the northern bank of Mare Creek; thence down Mare Creek on a chord of North 88 degrees 03 minutes 00 seconds west 129.00 feet to the point of beginning.

Being the same property conveyed to Johnny Ray Gunnells and Penny Gunnells, his wife, from Martha Blackburn, widow, dated February 6, 1987, of record in the Office of the County Clerk's Office of Floyd County, Kentucky.

A. The successful bidder shall either pay cash or make a deposit of \$5,000.00 of the purchase price with the balance on a credit for thirty (30) days. In which event the successful bidder shall be required to execute bond with good surety thereon. Said bond shall be for the unpaid purchase price and bear interest at the rate of 12% per annum from the date of sale until paid. Said bond shall have the force and effect of a Judgment for which execution may issue, and a lien shall be retained upon the above described real estate as additional security.

B. The purchaser shall be required to assume and pay all taxes or assessments, defects, liens or encumbrances of record in the property for prior years shall be paid from the sale proceeds of the property claimed in writing and good of record by the purchaser prior to the payment of the purchase price.

C. The property described above is sold, subject to any assessments, restrictions, defects, liens or encumbrances of record in the Floyd County Clerk's Office and such rights of redemption as may exist in favor of the United States of America and/or the record owners thereof.

Any announcements made on date of sale takes precedence over printed matter contained hereon.

Hon. William S. Kendrick, Floyd County Master Commissioner

Legals

PUBLIC NOTICE

COMMONWEALTH OF KENTUCKY
FLOYD CIRCUIT COURT
DIVISION I
C.A. NO. 09-CI-01113

U.S. BANK, N.A. PLAINTIFF

VS.

JAMES HARRIS
and LOMA HARRIS DEFENDANTS
RE-NOTICE OF COMMISSIONER'S SALE

By virtue of a Summary Judgment and Order of Sale of the Floyd Circuit Court entered the 26th day of January, 2010, in the above cause, as their interest in the subject property, for the sum of \$201,159.50 with interest thereon, plus additional sums and costs; please be advised that I shall proceed to offer for sale at the Old Floyd County Courthouse Door, South Central Avenue, Prestonsburg, Kentucky, (behind the new Floyd County Justice Center), to the highest and best bidder, at public auction, on the 26th day of March, 2012 at 9:00 a.m., upon the terms set forth following the description, the following described property, to wit:

Property Address: 330 Left Pen Hook, Harold, Kentucky
Beginning at a stake on the north side of the Pinhook road on a line between Emma S. Fuller and Rufus and Erian Sturgill; thence running in a northern direction with said line to Pinhook Creek; thence running down the creek with meanders of the stream a distance of one hundred feet to a stake; thence running across a distance of one hundred feet to a stake; thence running across the bottom in a southern direction approximately one hundred feet to the Pinhook road; thence running up the creek with road to the beginning, a distance of one hundred feet.

Being the same property conveyed to James Michael Harris by deed from Loma Compton Harris, dated the 10th day of March 1980 and recorded in Deed Book 246, Page 147 in the Office of the Court Clerk of Floyd County.

A. The successful bidder shall either pay cash or make a deposit of 10% of the purchase price with the balance on a credit for thirty (30) days, in which event the successful bidder shall be required to execute bond with good surety thereon. Said bond shall be for the unpaid purchase price and bear interest at the rate of 12% per annum from the date of sale until paid. Said bond shall have the force and effect of a Judgment for which execution may issue, and a lien shall be retained upon the above described real estate as additional security.

B. The purchaser shall be required to assume and pay all taxes or assessments upon the property for the current year and subsequent years. All taxes or assessments upon the property for prior years shall be paid from the sale proceeds if properly claimed in writing and filed of record by the purchaser prior to the payment of the purchase price.

C. The property described above is sold subject to any easements, restrictions, defects, liens or encumbrances of record in the Floyd County Clerk's Office and such rights of redemption as may exist in favor of the United States of America and/or the record owners thereof.

Any announcements made on date of sale takes precedence over printed matter contained herein.

Hon. William S. Kendrick, Floyd County Master Commissioner

PUBLIC NOTICE

NOTICE OF BOND RELEASE

Permit No. B35-0407

In accordance with KRS 350.093, notice is hereby given that Laurel Mountain Road, located on the south side of the road, Prestonsburg, Kentucky 41653 has applied for Phase I bond release on permit number B35-0407, which was last issued on 05-25-2010. The application covers an area of approximately 866.68 acres located 2.9 miles northeast of Hueysville in Floyd County.

The permit area is approximately 1.5 miles northeast from Route 2029 to the intersection of Laurel Mountain Road, Sellers Branch and Raccoon Branch of Saltlick Creek, and Mudlick Branch and Shepherd Branch of Brush Creek. The latitude is 37° 30'45". The longitude is 82° 53'27".

For Increment No. 7, approximately 60 percent of the original bond amount of \$83,200.00 is included in the application for release.

For Increment No. 11, approximately 60 percent of the original bond amount of \$72,700.00 is included in the application for release.

For Increment No. 15, approximately 60 percent of the original bond amount of \$27,000.00 is included in the application for release.

For Increment No. 16, approximately 60 percent of the original bond amount of \$64,800.00 is included in the application for release.

For Increment No. 28, approximately 60 percent of the original bond amount of \$26,500.00 is included in the application for release.

For Increment No. 27, approximately 60 percent of the original bond amount of \$42,900.00 is included in the application for release.

For Increment No. 28, approximately 60 percent of the original bond amount of \$112,700.00 is included in the application for release.

For Increment No. 29, approximately 60 percent of the original bond amount of \$49,900.00 is included in the application for release.

For Increment No. 30, approximately 60 percent of the original bond amount of \$75,700.00 is included in the application for release.

For Increment No. 31, approximately 60 percent of the original bond amount of \$10,400.00 is included in the application for release.

For Increment No. 32, approximately 60 percent of the original bond amount of \$56,800.00 is included in the application for release.

For Increment No. 33, approximately 60 percent of the original bond amount of \$137,000.00 is included in the application for release.

For Increment No. 34, approximately 60 percent of the original bond amount of \$47,300.00 is included in the application for release.

For Increment No. 35, approximately 60 percent of the original bond amount of \$44,100.00 is included in the application for release.

For Increment No. 36, approximately 60 percent of the original bond amount of \$59,000.00 is included in the application for release.

For Increment No. 37, approximately 60 percent of the original bond amount of \$7,600.00 is included in the application for release.

Written comments, objections, and requests for a public hearing or informal conference with the Director, Division of Mine Reclamation and Enforcement, #2 Hudson Hollow, Frankfort, Kentucky 40601, by March 27, 2012.

A public hearing on the application has been scheduled for March 28, 2012 at 10:00 AM, or soon thereafter as may be heard, at the Department for Natural Resources, Prestonsburg Regional Office, 3140 South Lake Drive, Prestonsburg, Kentucky 41653. The hearing will be cancelled if no request for a hearing or informal conference is received by March 27, 2012.

This is the final advertisement of the application

Legals

PUBLIC NOTICE

COMMONWEALTH OF KENTUCKY
FLOYD CIRCUIT COURT
DIVISION NO. I
C.A. NO. 11-CI-467

CITIZENS NATIONAL BANK PLAINTIFF

VS.

JULIUS JONES, VIRGINIA WILLIAMSON JONES,
SHANE LEE d/b/a LEE HORIZONTAL INC.,
JULIUS JONES CONTRACTING, LLC DEFENDANTS

NOTICE OF COMMISSIONER'S SALE

By virtue of a Default Judgment, Summary Judgment and Order of Sale of the Floyd Circuit Court entered the 8th day of December, 2011, in the above cause, as the interest in the subject property, in the principal amount of \$217,641.00 against Julius Jones, personally, Virginia Williamson Jones, in form, a \$34,251.35 against Julius Jones Contracting, LLC, with interest thereon, plus additional sums and costs; please be advised that I shall proceed to offer for sale at the Old Floyd County Courthouse Door, South Central Avenue, Prestonsburg, Kentucky, (behind the new Floyd County Justice Center), to the highest and best bidder, at public auction, on the 25th day of March, 2012 at 10:00 a.m., upon the terms set forth following the description, the following described property, to wit:

Property Address: 112 Alley Fork, East Point, Kentucky
A CERTAIN TRACT OR PARCEL OF LAND LOCATED IN FLOYD COUNTY, KENTUCKY, ON WATERS OF ALLEY FORK OF LITTLE PAINT CREEK OF LEVISA FORK OF BIG SANDY RIVER, MORE PARTICULARLY DESCRIBED AS FOLLOWS:

BEGINNING AT A 3/4" x 3/4" INCH IRON PIPE ON THE NORTH SIDE OF THE UNPLOWED ROAD, APPROXIMATELY 30 FEET NORTH OF THE CENTER LINE OF ALLEY FORK, A CORNER OF THE NELSON AND HAZEL BALDRIDGE PROPERTY. SAID PROPERTY IS LOCATED IN THE WIRE FENCE OF THE NORTH SIDE OF THE ACCESS ROAD TO THE NELSON AND HAZEL BALDRIDGE PROPERTY AND THE KATHY AND PHILIP BALDRIDGE PROPERTY. THENCE LEAVING THE HAROLD L. BALDRIDGE PROPERTY AND RUNNING UP THE FENCE AND HAZEL BALDRIDGE PROPERTY, BEING MORE PARTICULARLY DESCRIBED IN EXHIBIT "A" ATTACHED HERETO, AND MADE A PART OF THE SAME AS IF SET OUT AT LENGTH HEREIN

THIS BEING THE SAME PROPERTY CONVEYED TO JULIUS JONES AND VIRGINIA WILLIAMSON JONES, HIS WIFE, BY DEED FROM PAUL BRADFORD HUGHES AND RHONDA HUGHES, HIS WIFE, DATED THE 6TH DAY OF JULY, 2007 AND RECORDED IN DEED BOOK 539, PAGE 213, IN THE OFFICE OF THE COURT CLERK OF FLOYD COUNTY.

A. The successful bidder shall either pay cash or make a deposit of 10% of the purchase price with the balance on a credit for thirty (30) days, in which event the successful bidder shall be required to execute bond with good surety thereon. Said bond shall be for the unpaid purchase price and bear interest at the rate of 12% per annum from the date of sale until paid. Said bond shall have the force and effect of a Judgment for which execution may issue, and a lien shall be retained upon the above described real estate as additional security.

B. The purchaser shall be required to assume and pay the taxes or assessments upon the property for the current year and subsequent years. All taxes or assessments upon the property for prior years shall be paid from the sale proceeds if properly claimed in writing and filed of record by the purchaser prior to the payment of the purchase price.

C. The property described above is sold subject to any easements, restrictions, defects, liens or encumbrances of record in the Floyd County Clerk's Office and such rights of redemption as may exist in favor of the United States of America and/or the record owners thereof.

Any announcements made on date of sale takes precedence over printed matter contained herein.

Hon. William S. Kendrick, Floyd County Master Commissioner

PUBLIC NOTICE

COMMONWEALTH OF KENTUCKY
FLOYD CIRCUIT COURT
DIVISION I
C.A. NO. 09-CI-00481

CITIFINANCIAL SERVICES, INC. PLAINTIFF

VS.

IRIS J. PRATER

COUNTY OF FLOYD DEFENDANTS

RE-NOTICE OF COMMISSIONER'S SALE

By virtue of a Judgment and Order of Sale of the Floyd Circuit Court entered the 18th day of January, 2011, in the above cause, as the interest in the subject property, for the sum of \$101,741.30 with interest thereon, plus additional sums and costs; please be advised that I shall proceed to offer for sale at the Old Floyd County Courthouse Door, South Central Avenue, Prestonsburg, Kentucky, (behind the new Floyd County Justice Center), to the highest and best bidder, at public auction, on the 26th day of March, 2012 at 9:00 a.m., upon the terms set forth following the description, the following described property, to wit:

Property Address: 4989 Ky Route 1426, Dana, KY 41615

A certain tract or parcel of land lying in Floyd County, Kentucky, on Prater Creek and being the same property conveyed to Crit Conn and Eula Conn, husband and wife, by deed dated September 22, 1958, and of record at Deed Book 18, Page 505, and being more particularly bounded and described as follows:

Bounded and described as follows: Beginning at a concrete well box running north to the right corner of a large flat rock, thence running east on a straight line to a small mulberry tree near the Norman Conn line, thence running with the said Norman Conn line leaving a twelve foot space between this line and said Norman Conn line to the main highway, thence west with the main highway to a sharp marked stone, thence a straight line northward to the said starting place of a concrete well box.

Being the same property conveyed to Iris J. Prater, single, from Crit Conn and Eula Conn, husband and wife, by deed dated April 11, 2002, and recorded in Deed Book 539, Page 471, Page 469, office of the Floyd County Court Clerk.

A. The successful bidder shall either pay cash or make a deposit of \$5,000.00 of the purchase price with the balance on a credit for thirty (30) days, in which event the successful bidder shall be required to execute bond with good surety thereon. Said bond shall be for the unpaid purchase price and bear interest at the rate of 12% per annum from the date of sale until paid. Said bond shall have the force and effect of a Judgment for which execution may issue, and a lien shall be retained upon the above described real estate as additional security.

B. The purchaser shall be required to assume and pay the taxes or assessments upon the property for the current year and subsequent years. All taxes or assessments upon the property for prior years shall be paid from the sale proceeds if properly claimed in writing and filed of record by the purchaser prior to the payment of the purchase price.

C. The property described above is sold subject to any easements, restrictions, defects, liens or encumbrances of record in the Floyd County Clerk's Office and such rights of redemption as may exist in favor of the United States of America and/or the record owners thereof.

Any announcements made on date of sale takes precedence over printed matter contained herein.

Hon. William S. Kendrick, Floyd County Master Commissioner

Legals

Public Notice
Notice is hereby given that I, Marion T. Springs, of 323 Southview Dr., Rochelle, IL 61068, have filed an application with the Natural Resources and Environmental Protection Cabinet to place fill on my property along the left descending bank of the left fork of Beaver Creek of the Levisa Fork of the Big Sandy River. The property is located at Drift, Kentucky, and is located along Ky State Route 1101 and is approximately .05 miles from the intersection of Kentucky State Route 122 and State Route 1101. Any comments or objections concerning this application shall be directed to: Kentucky Division of Water, Surface Water Permit, Flood Plain Management Section, 200 Fair Oaks Lane, Frankfort, Kentucky 40601. Phone (502) 564-3470.

STORAGE AUCTION

Sunday 3/18/2012 3:00 PM

Past due storage units

A Storage 40 Jackson St.,
Prestonsburg, Ky. 41653

Must pay in cash when unit is sold.

20 Jonnie Ross 46-Eric
Vanderpool 19 Daniel

16 James Newsome 35
Christine Goble

40 Lois Crum 12 Ryan
Thatcher

17 James Jarrell 69 Michael
Children

22 Ross Gibson

PUBLIC NOTICE

COMMONWEALTH OF KENTUCKY
FLOYD CIRCUIT COURT
DIVISION I
C.A. NO. 08-CI-00960

CHASE HOME FINANCE LLC PLAINTIFF

VS.

BELINDA SHELTON DEFENDANTS

RE-NOTICE OF COMMISSIONER'S SALE

BY VIRTUE OF Revised Final Judgment and Order of Sale referring to Master Commissioner of the Floyd Circuit Court entered on the 23rd day of October, 2008, in the Floyd Circuit Court, in the above styled action, in the principal sum of \$99,992.54, together with interest, costs and fees, I shall proceed to offer for sale at the Old Floyd County Courthouse Door, South Central Avenue, Prestonsburg, Kentucky, (behind the new Floyd County Justice Center), to the highest bidder, at public auction, on the 26th day of March, 2012 at 9:00 a.m., upon the terms set forth following the description, the following described real estate lying in Floyd County, Kentucky, and more particularly described as follows:

Being two certain tracts of land lying and being on the waters of Left Beaver Creek, in Drift, in Floyd County, Kentucky as recorded in the Floyd County Court Clerk's Office in Deed Book 216, Page 439 and in Deed Book 263, Page 338.

Unless otherwise noted any monument referred to herein as an "Iron Pin (set)" is a one half inch rebar, at least 18 inches in length, with in Orange Plastic Cap stamped "ASI LS 3388". All Bearings hereon are based on a Magnetic North. The Kentucky State Department of Transportation Highway Plans for State Route 122 sheet 8 of 96 State Project No. 237 year of 1935.

First Tract (Deed Book 216, Page 439)

Commencing at a point on a 6.00 foot high chain link fence on the back side of the Lincoln Addition to Drift as being of record in the Floyd County Court Clerk's Office in Deed Book 72, Page 241 being the location of the large Mulberry as called for by both above said Deeds, and being a corner to other property of Berus Turner as being of record in the Floyd County Court Clerk's Office in Deed Book 263, Page 338, said point being the POINT OF BEGINNING, thence along said Lincoln Addition crossing High Street with said other Turner Property, S 28 C 2 53' W a distance of 26.65 Feet to an "Iron Pin (set)" on the south side of High Street thence S 28 C 2 53' W a distance of 59.63 Feet to an "Iron Pin (found)" 4 inch diameter, open top Pipe bent, being a corner to property now owned by Everett Maggard and Mary Maggard as being of record in the Floyd County Clerk's Office in Deed Book 216, Page 636, thence S 45 C 2 53' W a distance of 1.16 feet to the POINT OF BEGINNING at foot of slope and bearing S 46 27' 09" W a distance of 1.56 feet from another "Iron Pin (found)" 4 inch diameter open top Pipe bent above corner the hill and foot of slope crossing the calculated point of a corner to property now owned by Diana Reed as being of record in the Floyd County Court Clerk's Office in Deed Book 425, Page 252 at plus a distance of 23.21 feet N 49 35' 43" W a total distance of 85.32 Feet to an "Iron Pin (set)" at foot of slope between houses 1 and 2 as being of record in the Floyd County Clerk's Office in Deed Book 216, Page 636, thence S 45 C 2 53' W a distance of 80.00 feet to a 4.00 feet high chain link fence; thence leaving said Reed Property along east side fence with said Berger Property N 35 57' 04" E a distance of 83.43 Feet to an "Iron Pin (set)" on the south side of High Street; thence N 34 57' 04" E a distance of 29.57 Feet a point on a 6.00 feet high chain link fence on the back side of the Lincoln Addition to Drift as being of record in the Floyd County Court Clerk's Office in Deed Book 72, Page 241; thence, thence leaving said Berger Property along said fence S 60 30' 58" E a distance of 79.65 Feet to the POINT OF BEGINNING. Containing 0.22 acres as shown on Appalachian Surveying Inc. Drawing File name 04-026 Master.

Second Tract (Deed Book 263, Page 338)

Commencing at a point on a 6.00 feet high chain link fence on the back side of the Lincoln Addition to Drift as being of record in the Floyd County Court Clerk's Office in Deed Book 72, Page 241 being the location of the large Mulberry as called for by both above said Deeds and being a corner to other property of Berus Turner as being of record in the Floyd County Court Clerk's Office in Deed Book 216, Page 439, said point being the POINT OF BEGINNING, thence along said Fence S 44 31' 10" E a distance of 1.16 feet to the POINT OF BEGINNING at edge of High Street thence with east side of said High Street S 28 02' 53" E a distance of 26.65 feet to the POINT OF BEGINNING. Containing 0.22 acres as shown on Appalachian Surveying Inc. Drawing File name 04-026 Master.

Both Tracts include area of said High Street at edge of pavement equalling an area of 0.07 acres.

Being the same property conveyed to Belinda Shelton, a single person, from Berta Moore, aka Berta Turner and Everett Maggard and Mary Maggard, husband and wife, by deed dated September 12, 2007 in Deed Book 539, Page 59 of the Floyd County Court Clerk's Office.

A. The successful bidder shall either pay cash or make a deposit of 10% of the purchase price with the balance on a credit for thirty (30) days, in which event the successful bidder shall be required to execute bond with good surety thereon. Said bond shall be for the unpaid purchase price and bear interest at the rate of 12% per annum from the date of sale until paid. Said bond shall have the force and effect of a Judgment for which execution may issue, and a lien shall be retained upon the above described real estate as additional security.

B. The purchaser shall be required to assume and pay all taxes or assessments upon the property for the current year and subsequent years. All taxes or assessments upon the property for prior years shall be paid from the sale proceeds if properly claimed in writing and filed of record by the purchaser prior to the payment of the purchase price.

C. The property described above is sold subject to any easements, restrictions, defects, liens or encumbrances of record in the Floyd County Clerk's Office and such rights of redemption as may exist in favor of the United States of America and/or the record owners thereof.

Any announcements made on date of sale takes precedence over printed matter contained herein.

Hon. William S. Kendrick, Floyd County Master Commissioner

Legals

PUBLIC NOTICE
NOTICE OF INTENTION
TO MINE

Pursuant to Application Number 858-5064 - Renewal No.2

In accordance with the provisions of KRS 350.085, notice is hereby given that Czar Coal Corporation, 81 Enterprise Drive, Delton, Kentucky 41024 has applied for a renewal of a permit for an underground coal mining operation located 2.5 miles southwest of Odds in Johnson, Floyd and Martin Counties. The operation will disturb 75.2 surface acres and there will be 11,119.16 acres overlying underground workings making the total area within the permit boundary 11,194.40 acres.

The operation is approximately 2.5 miles south of Johnson, Floyd and Martin Counties. The operation will disturb 75.2 surface acres and there will be 11,119.16 acres overlying underground workings making the total area within the permit boundary 11,194.40 acres.

The operation is located on the Lancer Thomas U.S. 25, 7 1/2 minute quadrangle map. The surface area to be disturbed is owned by Pechontas Development Corporation, Jerry Howell and Jefferson Coal Company. The operation will be underlain by the Pechontas Development Corporation, Jerry Howell and Jefferson Coal Company. The operation will be underlain by the Pechontas Development Corporation, Jerry Howell and Jefferson Coal Company.

Items declared surplus below:

- Monitors
- Printers
- Copiers
- CPUs
- Projectors

To obtain a detailed listing of items or to schedule a viewing, contact Penelope Spradlin at 606-886-4512. Between the hours of 8:00 a.m. and 4:00 p.m. on Friday, prior to the time and date specified for the bid opening.

Sealed bids must be mailed or delivered to Matthew C. Wreman, Director of Finance/Treasurer, Floyd County Board of Education, 100 North Front Avenue, Prestonsburg, KY 41653. All envelopes must be marked on the outside of the envelope "SURPLUS PROPERTY SEALED BIDS".

Sealed bids will be accepted until 1:00 PM, Wednesday, March 21, 2012 and publicly opened that date at 1:05 PM, in the central office, located at 108 North Front Avenue, Prestonsburg, KY 41653. All bids will be subject to board approval during the regular scheduled board meeting which will be held at 6:30 PM, at Prestonsburg Elementary School, 400 Clark Dr., Prestonsburg, KY 41653. All bids must be received by the time designated and none will be considered thereafter. The Board of Education cannot assume the responsibility for any delay in the delivery of the bids to the board.

Items sold will be awarded to the highest bidder(s) meeting all specifications and conditions, and subject to all applicable laws and regulations, on a per item basis, and/or a group basis, whichever is deemed to be in the best interest of the Board of Education. The Floyd County Board of Education reserves the right to accept or reject any or all sealed bids.

The application has been filed for public inspection at the Department for Surface Mining Reclamation and Enforcement, Prestonsburg Regional Office, 3140 South Lake Drive, Suite 6, Prestonsburg, Kentucky 41653.

Written comments, objections or requests for a permit conference must be filed with the Director, Division of Permits, #2 Hudson Hollow, U.S. 127 South, Frankfort, Kentucky 40601.

This is the final advertisement of this application; all comments, objections or requests for a permit conference must be received within 30 days of this date.

NOTICE OF INTENTION TO MINE

Pursuant to Application Number 836-5565, Renewal No. 5

In accordance with KRS 350.055, notice is hereby given that FDCO Coal, Inc., P.O. Box 1200, Johnson Creek, Kentucky 41650 has applied for a renewal of a permit to an existing underground coal mining and reclamation operation located 2.5 miles east of Drift in Floyd County. The proposed operation will disturb 29.20 surface acres and will underlie 2,175.12 acres, and the total area within the permit boundary will be 2,204.90 acres.

The proposed operation is approximately 2.5 miles east from KY Route 122's junction with Simpson Branch County Road and located 0.10 miles southeast of Simpson Branch.

The proposed operation is located on the McDowell USGS 7 1/2 minute quadrangle. The surface area to be disturbed is owned by Cagle, Martin, Stella Martin Hamilton, Ella Martin, Sola Williams and The Elk Horn Coal Company, LLC, 544 South Lake Drive, Prestonsburg, KY 41653. The operation will underlie land owned by Cagle, Martin, Stella Martin Hamilton, Ella Martin, Sola Williams, The Elk Horn Coal Company, LLC, Dorothy Huff Hamilton, Vannie Kidd, Emmitt Lawson, Bass Martin, Helton, Dennis

Legals

Anna H. Huff, Levi Hall, Billy J. Hall, John M. and Leslie K. Caudill, Lula Bradley, May Beverly Estate, Wills Faye David, Nellie Faye David, Laverly Estate, Eugene Hamilton, Tony Jr. and Alden Nettie Hall, Mary Francis Stone, Arthur Mitchell, Roland Moore, Zernoff and Pamela Stumbo, Everett and Susan Knott, Shelton, Rudolph Parsons, Charles and Carolyn Wallen, Charles and Clova Howell, Bonnie Vorath, Alex and Alverta Samons, Clinis Hall, Madge and Cecilia Denny, Edith Cook Skeens, Roland Caudill, Sallie Hall Hutchinson, Penny Skemmer, Russell Beasley, Ted and Helen Stumbo, William E. and Helen Hall, Bobbie and Audrey Hall, Vernon and Anna R. Hall, Billie Joe and Janice Glynn, Dennis Ray Hall, Ray Turner, N & K Martin Heirs, Edith Huff, Dorothy Martin, and Jamie Ray and Lisa Powell.

The application has been filed for public inspection at the Department for Natural Resources, Prestonsburg Regional Office, 3140 South Lake Drive, Prestonsburg, Kentucky 41653. Written comments, objections, or requests for a permit conference must be filed with the Director of the Division of Permits, #2 Hudson Hollow, U.S. 127 South, Frankfort, Kentucky 40601.

ACCEPTING
SEALED BIDS-SURPLUS PROPERTY

The Floyd County Board of Education will receive sealed bids for technology items declared surplus below:

Monitors

Printers

Copiers

CPUs

Projectors

To obtain a detailed listing of items or to schedule a viewing, contact Penelope Spradlin at 606-886-4512. Between the hours of 8:00 a.m. and 4:00 p.m. on Friday, prior to the time and date specified for the bid opening.

Sealed bids must be mailed or delivered to Matthew C. Wreman, Director of Finance/Treasurer, Floyd County Board of Education, 100 North Front Avenue, Prestonsburg, KY 41653. All envelopes must be marked on the outside of the envelope "SURPLUS PROPERTY SEALED BIDS".

Sealed bids will be accepted until 1:00 PM, Wednesday, March 21, 2012 and publicly opened that date at 1:05 PM, in the central office, located at 108 North Front Avenue, Prestonsburg, KY 41653. All bids will be subject to board approval during the regular scheduled board meeting which will be held at 6:30 PM, at Prestonsburg Elementary School, 400 Clark Dr., Prestonsburg, KY 41653. All bids must be received by the time designated and none will be considered thereafter. The Board of Education cannot assume the responsibility for any delay in the delivery of the bids to the board.

Items sold will be awarded to the highest bidder(s) meeting all specifications and conditions, and subject to all applicable laws and regulations, on a per item basis, and/or a group basis, whichever is deemed to be in the best interest of the Board of Education. The Floyd County Board of Education reserves the right to accept or reject any or all sealed bids.

ANNOUNCEMENTS

SERVICES

Miscellaneous

RECENTLY DIVORCED???
New support group for individuals divorced one yr or less
Every Thurs 6-8 pm @
Spiritual Journey Studio
(Across from Dewey Dam entrance)
\$5 participation fee
Call to sign up: 606-339-7778

Automotive

For sale Toyota Camry 2008
50,000 miles
2009 GMC 24,000 miles. Call for more information
(606)874-9879

ANIMALS

Pets

For sale a week old great
puppies puppies. \$300 Call
74-2887

AUTOMOTIVE

Ages

HICKS AUTO SALES
DAVID R. HICKS
"Good Titles"
1999 Oldsmobile silhouette
van 115,000 miles \$3,200
98 Dodge ram 4x4 quad cab
2000 Buick Lesabre Limited
146,000 miles
1995 GMC Sierra 4wd extra
cab
1998 zr2 s10
1991 Ford F-150 100,000
miles
2007 Chevy Tracker \$3,000
2003 Wide Glide H.D.
12,000 miles \$9,000
2007 Yukon SLT Loaded
100,000 miles \$18,500
"Rebuilt Title"
1995 Ford Taurus \$2,900
2003 Ranger supercab
2006 Chevy Silverado crew
cab \$9,800
CALL 606-886-2842



ANNOUNCEMENTS

Dear friends and relatives,
We are asking for donations for the upkeep of the Hicks Cemetery, located at Hippo.
Through previous donations, we have been able to secure regular mowing, trimming, cleaning and general upkeep of the cemetery.
It is our intent, with help from people like you, to see this is continued.
Donations may be sent or given to either of the following people:
Greg Davis
1032 State Rd. #850
David, Kentucky 41616
Sarah Alice Reffett
P.O. Box 74
Hucysville, Kentucky 41640
Thanks for your help,
Hicks Cemetery Committee

Apartments/Townhouses

PARK PLACE APARTMENTS

**Best Deal On Rentals
move in now
Deposit Paid in Installments
1BR starting at \$305
2BR starting at \$330
Laundry and Maintenance onsite
606-886-0039
606-349-7000**



REAL ESTATE SALES

Houses For Sale

FOR SALE
3 Br. 2 1/2 bath home for sale
by owner 1.3 miles up Abbot
Rd. Prestonsburg. Call
886-9449

Houses For Sale

For Sale
Double wide Trailer - 1994
Chandeleur, with 15 acres
of land. Good condition, private
gated driveway, all electric,
3 bedrooms, 2 bath, 2 porches,
block storage building,
additional storage trailer,
head neighbor hood with city
water accessible. Located
near Turner Branch, in
Floyd Co. near Allen Central
High School. \$80,000. Call
Wanda 806-205-2995.

House and 1 acre lot for sale
Price, KY, 4 BDRM, 1 & 1/2
bath, new heat pump, city water,
electric, porch, ready to
move in! \$70,000. Call Lenny
791-2301 or 377-6741

House for sale Creek (McDowell)
one mile up in Doty Creek.
Must have references to rent
No Pets. Call 225-9130

REAL ESTATE RENTALS

Apartments/Townhouses

Duplex for rent, 2bdrm, 1 bath,
central heat & air, on US 23,
mile north of Prestonsburg.
Also 3 bedroom house, call
889-9747 or 886-9007

APARTMENT FOR RENT
UNFURNISHED 1 BR, 1
BATH APARTMENT WITH
HARDWOOD FLOORS &
FIRE PLACE. LOCATED BETWEEN
PRESTONSBURG HIGH SCHOOL & COMMUNITY COLLEGE. APPLICATION, DEPOSIT & LEASE
REQUIRED. NO PETS. CALL
886-3565 OR 886-0099

Large apartment for rent. Located
on US 23 at Starville. 2 br.
2 bath. Walk in closet. Large
living room area. 1 yr lease.
NO PETS. \$650 per month.
\$650 security deposit.
Call 606-478-8100

For rent 1 bdrm Apt. located in
Martin, utilities included. \$500
per month. \$250 deposit. Call
226-4375 or 285-9093

For rent 1 Bdrm Apt. close to
Prestonsburg. NO HUD or
Pets. Call 263-4323, or
205-9510

Two bedroom Apartment for
rent \$400 deposit \$400 per
month located at Eastern.
Call 358-9123. Leave message

Houses For Rent

FOR RENT - RECENTLY REMODELED
2 BDRM, 1 BATH
FARMHOUSE ON PRIVATE
LOT. ADJACENT TO PRESTONSBURG. 4 MILES OFF
US 23. CLOSE TO SCHOOLS
AND HOSPITAL. 5600 S.F.
MONTH. PLUS DEPOSIT.
\$650 - 791-6781 OR
806-886-1597

For rent newly remodeled
three bedroom house with one
and one half bath, dining
room, kitchen, living room and
large family room. Located two
miles south of Martin on Han-
nane Branch, Off Ky Rt. 122.
Blacktop road and drive way
\$750 per month plus utilities.
references required. No pets.
For more info. Call
606-255-9112

Trailer for rent. Call
806-874-9790

Two bedroom one bath house
for rent 900 sq ft. Call
886-6184

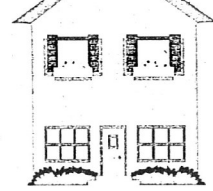

Land (Acreage)

FOR SALE
APPROXIMATELY 40 TO 50
ACRES OF PRIME REAL ESTATE
LOCATED IN A SHORT
DISTANCE FROM PRESTONSBURG.
6 TENNIS OF
A MILE UP SPURLOCK
FORK OF MIDDLE CREEK.
OLDER HOME ON PROPERTY.
PROPERTY COULD BE RENO-
VATED OR DEMOLISHED TO
ALLOW YOU TO BUILD
YOUR DREAM HOME. NATU-
RAL GAS AND CITY WATER
ARE ON SITE. PROPERTY
COULD BE SUBDIVIDED
INTO SEVERAL HOUSE
SITES IF DESIRED. ALL
COUNTRY HOMES. PLAIN &
SIGNIFICANT
AMOUNT OF MATURE TIM-
BER IS ALSO AVAILABLE
FOR HARVESTING. ASKING
\$110,000.00. Please call
606-886-6041. SERIOUS IN-
QUIRIES ONLY.

MANUFACTURED HOUSING

For Sale

FOR SALE
ONE OWNER, LIKE NEW, 14
X 70 SINGLE WIDE. 3 BR, 2
1/2 BATH. ALL APPLIANCES
INCLUDED. \$9,000.00 OR
BEST OFFER. CALL
791-0696

Rentals

2 BDR MOBILE HOMES FOR RENT
LOCATED 5 MILES ON
RT. 124. HAVE APPLIANCES.
PLUS W.D. NEWLY RE-
MOLDED. NO PETS. O
HUD. CALL 886-8665.

3BR 2BA 14X70 M H ON COW CREEK
\$95.00 PLUS
ELECTRIC AND 300.00 SE-
CURITY DEPOSIT. ACCEPTS
HUD. NO PETS. REFER-
ENCES REQUIRED.
606-874-2802

For Rent
2 bedroom mobile home, on
private lot, new flooring
throughout, located on Rt.
1428 between Allen and Pre-
stonsburg. No HUD. No Pets.
Background checks and serious
inquiries only. \$500/month
rent. \$200 deposit. Call
606-259-7063 or 226-6152.

FOR RENT
SINGLE WIDE, 3 BR, 2 BATH
AT AUXIER \$495.00 PER
MONTH. NO PETS. CALL
367-1169

EMPLOYMENT

Help Wanted - General

Administrative Assistant
needed: must be Reliable, Re-
sponsible. Knowledge of Mi-
crosoft Office, 10 years gen-
eral office duties. Experience
required. Salary Negotiable. No
Phone Calls Please. Send Re-
sume to:
Alliance Corporation 2014 KY
Rt. 221 Prestonsburg, KY
41653 or Email to howell@al-
liancecorp.com

Community Connections

at Nol, KY,
has full time position avail-
able for immediate place-
ment for LPN to work with
adults with intellectual Dis-
abilities. Monday thru Friday
Must have valid drivers li-
cense and auto insurance.
Call for more info.
(606)875-1900
Equal Opportunity Employer

Secretary wanted to work in
County office. M-F 10 a.m.
to 5:30 p.m. Full time at
Martin. Should have High
school diploma and knowledge
of secretary and medical billing
(\$110,000.00). Please call
606-285-9000 between 9:30
a.m. and 7:00 p.m.

HELP WANTED

PREMIER ELKHORN COAL COMPANY, Myra, Ky is now ac-
cepting applications for the following positions:

Backdump Operator must have minimum of 2 years experi-
ence operating a backdump in the surface mining of coal. Ky
surface Mine Certification required.

Blaster requires 2 years blasting experience, CDL Certification,
ATF Possessors License, and Ky Blaster License Certification.

TECO coal offers excellent wages and benefits; a superb
health care plan that includes medical prescription, dental and
vision coverage; paid sick, holidays, and life insurance; com-
pany paid retirement plan plus 401-K retirement savings plan
with a company match, bonus plans, and short and long term
disability benefits.

Applications will be accepted at:

Kentucky Department for Employment Services
38 College Street
Pikeville, KY 41501
Premier Elkhorn Coal Company is an EOE.

NOW HIRING!

Waste Connections of Eastern Kentucky has an immediate
opening for a Residential Rear-Load Driver to support local
routes at our site in Martin, KY. Minimum Class B
CDL required. Candidates interested in secure, steady employ-
ment in a family atmosphere are encouraged to apply.

Competitive Pay and Full Benefits
Please apply at www.wasteconnections.com or call Melissa at
901-259-8244.

Waste Connections is an Affirmative Action /Equal Opportunity
Employer (M/F/D/V).

Help Wanted

Ingram Barge Company, the leader in the inland marine
community has openings for:

TOWBOAT PILOTS (FLEET AND LINE HAUL)
VESSEL ENGINEERS
DECKHANDS
CULINARY COOKS

Candidates must possess a current valid drivers license and
High School Diploma/GED. Generous wages, bonus plan and
advancement opportunities, along with a comprehensive
benefit package, (paid retirement, 401K, medical, life & AD&D,
etc.) Interested candidates must apply online at
www.ingrambarge.com
EOE, M/F/V



FAST LANE, INC. CAREER OPPORTUNITY
Now hiring convenience store and discount
tobacco store managers. Experience or two-year
degree preferred.

Excellent benefits:
- Health Insurance
- 401 (K)
- Paid Vacation
- Monthly Bonus Program
- Safety Bonus Program
and many other great incentives.

Send resume to:
Fast Lane, Inc.
Attn: James Mills
PO Box 248
Lovely, KY 41231



Mr. Fix-It Home Improvement
We can replace or fix any
problems on your home or
mobile home. We have
experience with
roofing, flooring and
more.
Give us a call for a FREE ESTIMATE
606-205-4158

Reynolds Marine Service
"Service You Can Trust"
Brian Reynolds Owner/Operator
Located at Bonner, KY.
Repair Work & New
"and Used Parts."
Lake Service Available
606-874-8281

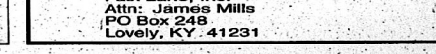
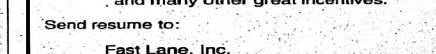
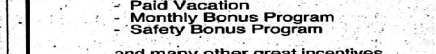
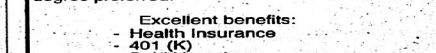
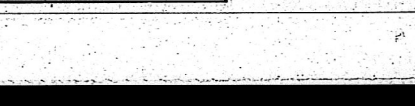

ATHLON SPORTS INSIDE COLLEGE BASKETBALL

ATHLONSPORTS.COM

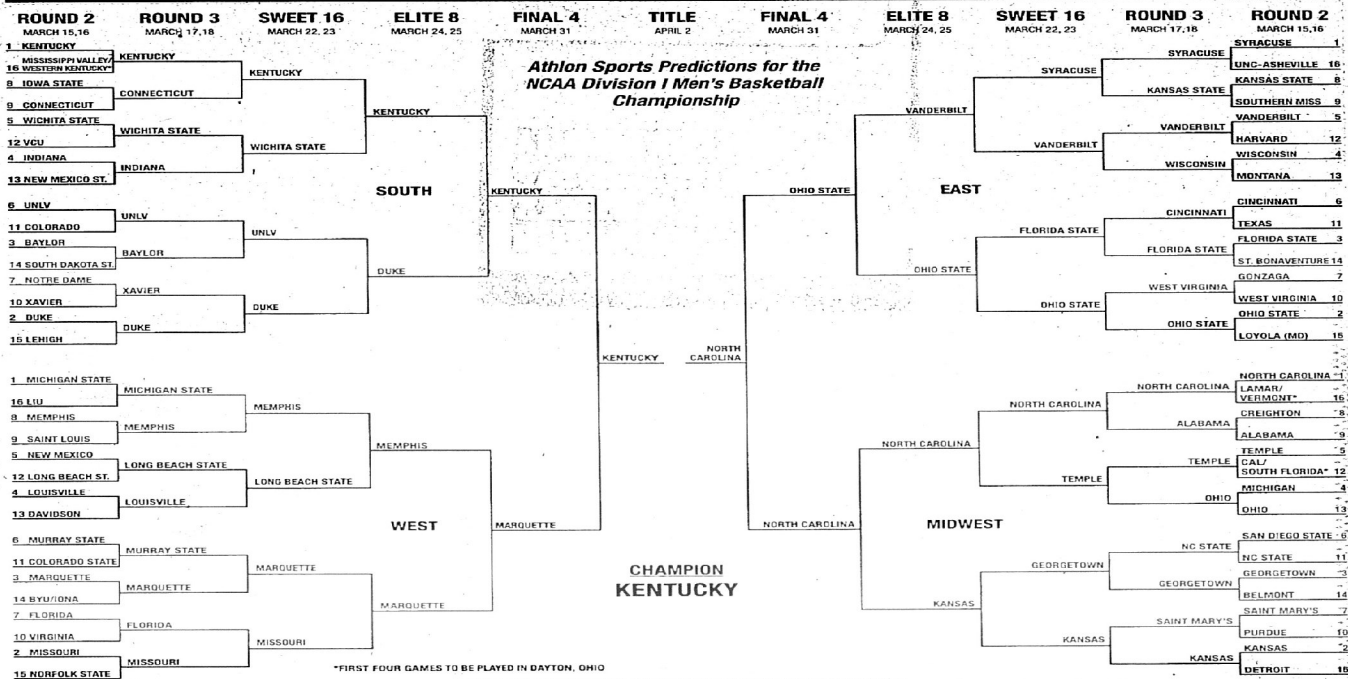

SOUTH REGION

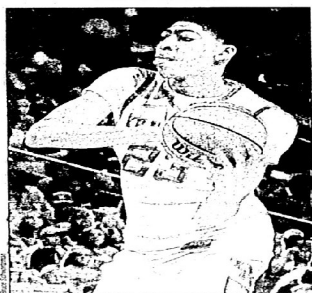

Anthony Davis, Kentucky

Kentucky is making a record 53rd NCAA Tournament appearance. The Wildcats are the No. 1 overall seed even after losing to Vanderbilt in the SEC Tournament title game. Duke gets only 45.5 percent of its scoring from made 2-point field goals. That ranks 320th out of 345 teams in the nation. The Blue Devils get 31.4 percent of their scoring on 3-pointers and 23.1 percent from the foul line. ... Baylor is in the NCAA Tournament for the second time in three years but only the third time since 1998. The Bears reached the Elite Eight two years ago, also as a No. 3 seed, by beating Sam Houston, Old Dominion and Saint Mary's. ... Indiana is back in the NCAA Tournament after a three-year absence, its longest since missing the field from 1968-72. The Hoosiers will be forced to play without senior guard Verdel Jones (7.5 ppg, 3.2 apg), who tore his ACL during the Big Ten Tournament. ... Wichita State reached the Sweet 16 in 2006 (its last time in the NCAA) as a No. 7 seed. The Shockers beat No. 10 Seton Hall and No. 2 Tennessee before losing to No. 11 George Mason. ... UNLV features one of the top transfers in the nation. Forward Mike Moser, who began his career at UCLA, leads the Rebels in scoring (14.1 ppg) and rebounding (10.6 rpg). ... Notre Dame went 13-5 in the Big East despite losing its best player, forward Tim Abromaitis, to a torn ACL in November.

WEST REGION



Draymond Green, Michigan State

Michigan State has a .684 winning percentage in the NCAA Tournament (52-24), which is good for eighth all-time. The Spartans have reached the NCAA in 15 straight seasons, with six trips to the Final Four. ... Missouri has won at least one game in five of its last six trips to the NCAA Tournament. Last year, the Tigers, a No. 11 seed, lost in the first round to No. 6 seed Cincinnati. ... Marquette senior forward Jae Crowder was named Big East Player of the Year despite being the Golden Eagles' second-leading scorer. Crowder averages 17.4 points and 8.1 rebounds. Senior guard Darus Johnson-Odom leads the team with 18.5 points per game. ... Louisville is ranked No. 2 in the nation in defensive efficiency according to KenPom.com. The Cardinals allow only 0.847 points per possession. The national average is 1.009. ... New Mexico records an assist on 64.8 percent of its field goals, good for third in the nation. Sophomore guard Kendall Williams leads the Lobos with 4.1 assists per game. ... Murray State ranks fifth in the nation in 3-point shooting percentage (.407). Senior guard Isaiah Canaan, a first-team All-American, shoots 47.3 and makes 3.1 threes per game. ... Florida has 15 NCAA Tournament wins in the last six seasons despite missing the field in both 2008 and '09. The Gators won the national title in '05 and '06 and reached the Elite Eight last season.

EAST REGION



Kris Joseph, Syracuse

Syracuse is a No. 1 seed for only the third time ever. The Orange have been a No. 2 seed five times and are one of only four No. 2s to lose in the first round. In 1991, the second-seeded Orangemen (as they were called at the time), lost to Richmond 73-69. ... Ohio State doesn't rely heavily on the 3-point shot. Only 19.5 percent of the Buckeyes' points come from beyond the arc, which ranks 330th in the nation. ... Florida State became the first team to beat both North Carolina and Duke twice in the same season since Georgia Tech did it in 1995-96. The Seminoles captured the ACC Tournament title by defeating Duke in the semis and UNC in the championship game. ... Wisconsin is in the NCAA for the 14th straight season and is a No. 4 seed for the third straight year. The Badgers lost to No. 8 Butler in the Sweet 16 last season and to No. 12 Cornell in the second round in 2010. ... Vanderbilt is making its fifth NCAA appearance in the past six seasons. The Commodores made the Sweet 16 in 2004 and 2007 but lost in the first round in '08, '10 and '11. ... Cincinnati ranks 307th in the nation in free-throw shooting, hitting only 64.1 percent from the line. Guard Sean Kilpatrick (7.44) is the only regular who shoots over 70 percent. ... Gonzaga is in the NCAA Tournament for the 14th straight season. The Zags have reached the Sweet 16 five times during this stretch.

MIDWEST REGION



Kendall Marshall, North Carolina

North Carolina is a No. 1 seed for the fourth time in the past five seasons. The Tar Heels earned the top seed in the Midwest Region despite losing to Florida State in the ACC Tournament title game. ... Kansas is among the best in the nation at making 2-point field goals (.541, ninth-best) and defending 2-point field goals (.400, second-best). ... Georgetown advanced to the Final Four in 2007 but has lost to a double-digit seed in each of its past three trips to the NCAA Tournament—Davidson (No. 10) in '08, Ohio (No. 14) in '09 and VCU (No. 11) in '11. ... Michigan is a No. 4 seed in the Midwest Region. It's the Wolverines' highest seed since they were a No. 3 in 1998. Michigan has not reached the Sweet 16 since 1994. ... Temple ranks ninth in the nation in 3-point shooting, hitting .402 from beyond the arc. Owl opponents are shooting .336 from three. ... San Diego State had not won an NCAA Tournament game until beating Northern Colorado and Temple on its way to the Sweet 16 last year. The Aztecs had lost in the first round in each of their previous six trips. ... Saint Mary's won the outright West Coast Conference regular-season title, snapping Gonzaga's streak of 11 straight seasons with at least a share of the league championship. ... Creighton sophomore Greg McDermott ranks fourth in the nation in scoring at 23.1 points per game.

Wesley Wayne Howard, Pharm.D., MBA
Howard Family Pharmacy, Inc.
327 KY Rt 550
Eastern, KY 41622
606-358-4800
Refills at www.howardfamilypharmacy.com
Flu Shots & Pneumonia Shots Available
(Near Allen Central High School at Eastern)

HOWARD FAMILY PHARMACY
QUALITY CARE AND SERVICE

We Accept
Most Insurance
Plans
Credit/Debit Cards

VISA
MasterCard

**DOWNLOAD,
STREAM
& SURF ALL
YOU WANT!**

Inter Mountain Cable offers the
FASTEST CABLE MODEM High Speed
Broadband Service in Eastern Kentucky! You can
surf the web, play games and download movies/
music with speeds up to 10meg/1meg!

**4 meg/1 meg Broadband & Phone
Only \$49.99 for first six months**

Call Inter Mountain Cable Today at:
1.800.635.1702

LIKE US on Facebook at www.facebook.com/imebunde

**BECOME A
SPONSOR**
by calling
Brian Conn or
Jessica Thompson
606-886-8506

The Times
Floyd County
Serving the citizens of Floyd County since 1927